

DESCRIPTION OF SERVICE AREA

- A. The service area of Southwest Gas Corporation within the County of San Bernardino, State of California, San Bernardino Baseline and Meridian, includes the following described area:
1. Township 11 North, Range 5 West, All of Sections 1, 2, 3, 10, 11, 12, 13, 14, 15, 22, 23, 24, 25, 26, 27, 34, 35, and 36.
  2. Township 11 North, Range 4 West, All of Sections 4, 5, 6, 7, 8, 9, 16, 17, 18, 19, 20, 21, 28, 29, 30, 31, 32, and 33.
  3. Township 10 North, Range 5 West, All of Sections 1, 2, 3, 10, 11, 12, 13, 14, 15, 22, 23, 24, 25, 26, 27, 34, 35, and 36.
  4. Township 10 North, Ranges 4, 3, 2, and 1 West and Ranges 1 and 2 East.
  5. Township 9 North, Range 5 West, All of Sections 1, 2, 3, 10, 11, 12, 13, 14, 15, 22, 23, 24, 25, 26, 27, 34, 35, and 36.
  6. Township 9 North, Ranges 4, 3, 2, and 1 West and Ranges 1 and 2 East.
  7. Township 8 North, Range 5 West, All of Sections 1, 2, 3, 10, 11, 12, 13, 14, 15, 22, 23, 24, 25, 26, 27, 34, 35, and 36.
  8. Township 8 North, Ranges 4, 3, 2, and 1 West and Ranges 1 and 2 East.
  9. Township 7 North, Range 5 West, All of Sections 1, 2, 3, 10, 11, 12, 13, 14, 15, 22, 23, 24, 25, 26, 27, 34, 35, and 36.
  10. Township 7 North, Ranges 4, 3, 2, and 1 West and Ranges 1 and 2 East.
  11. Township 6 North, Ranges 5, 4, 3, 2, and 1 West and Ranges 1 and 2 East.
  12. Township 5 North, Range 5 West, All of that portion lying east of the existing Southern California Gas Company Transmission Pipeline No. 1185, and south of the southerly property line and east of the easterly property line, of the Southern California Gas Property known as the Adelanto Compressor Station in Section 6.
  13. Township 5 North, Ranges 4, 3, 2, and 1 West and Ranges 1 and 2 East.
  14. Township 4 North, Range 5 West, All of that portion lying east of the existing Southern California Gas Company Transmission Pipeline No. 1185.
  15. Township 4 North, Ranges 4, 3, 2, and 1 West and Ranges 1 and 2 East.
  16. Township 3 North, Range 6 West, All of that portion lying southerly, easterly and northerly of the centerline improvement line of Interstate Route 15 as shown on State of California, Transportation Agency, Department of Public Works, Division of Highways, Right-of-Way Map.

DESCRIPTION OF SERVICE AREA  
(Continued)

17. Township 3 North, Range 5 West, All of that portion lying east of the existing Southern California Gas Company Transmission Pipeline No. 1185, and southerly of the centerline improvement line of Interstate Route 15 as shown on State of California, Transportation Agency, Department of Public Works, Division of Highways, Right-of-Way Map.
  18. Township 3 North, Ranges 4, 3, 2, and 1 West and Ranges 1 and 2 East.
  19. Township 2 North, Range 1 West and Ranges 1 and 2 East.
- B. The aforesaid Southern California service area of Southwest Gas Corporation is more particularly described as follows:

BEGINNING at the northwest corner of Section 3, Township 11 North, Range 5 West; thence easterly along the north line of Sections 3, 2, and 1, to the northeast corner of said Section 1, said Township and Range; thence continuing easterly along the north line of Sections 6, 5, and 4, Township 11 North, Range 4 West, to the northeast corner of said Section 4, said Township and Range; thence southerly along the east line of Sections 4, 9, 16, 21, 28, and 33, Township 11 North, Range 4 West, to the southeast corner of said Section 33, said Township and Range; thence easterly along the north line of Sections 3, 2, and 1, Township 10 North, Range 4 West, to the northeast corner of said Section 1, said Township and Range; thence continuing easterly along the north line of Township 10 North, Ranges 3, 2, and 1 West, and Ranges 1 and 2 East, to the northeast corner of said Township 10 North, Range 2 East; thence southerly along the east line of Townships 10, 9, 8, 7, 6, 5, 4, 3, and 2 North, Range 2 East, to the southeast corner of said Township 3 North, Range 2 East; thence westerly along the south line of Township 2 North, Ranges 1 and 2 East and Range 1 West, to the southwest corner of said Township 2 North, Range 1 West; thence northerly along the west line of said Township 2 North, Range 1 West, to the northwest corner of said Township and Range; thence westerly along westerly the south line of Township 3 North, Ranges 2, 3, 4, and 5 West, to the southwest corner of Township 3 North, Range 5 West; thence continuing westerly along the south line of Township 3 North, Range 6 West, to the intersection with the centerline improvement line of Interstate Route 15 as shown on State of California, Transportation Agency, Department of Public Works, Division of Highways, Right-of-Way Map; thence northwesterly, northerly, and northeasterly along said centerline improvement line of said Interstate Route 15, to its intersection with that certain line labeled "LL E. RD. BD." as shown on State of California, Transportation Agency, Department of Public Works, Division of Highways, Right-of-Way Number 909031 of said Township 3 North, Range 6 West; thence northeasterly along said "LL E. RD. BD." line to its intersection with the east edge of the existing Southern California Gas Company Transmission Pipeline No. 1185, being within Township 3

DESCRIPTION OF SERVICE AREA  
(Continued)

North, Range 5 West; thence northerly along the east edge of said Southern California Gas Company Transmission Pipeline No. 1185, through its varying course within Townships 4 and 5 North, Range 5 West, to its intersection with the south line of the Southern California Gas Company Property, known as Adelanto Compressor Station in Section 6, Township 5 North, Range 5 West; thence easterly along the south line, to the southeast corner of said Property; thence northerly along the east line, to the north line of Township 5 North, Range 5 West; thence westerly along the south line of Township 6 North, Range 5 West, to the southwest corner of said Township and Range; thence northerly along the west line of Township 6 North, Range 5 West, to the northwest corner of said Township and Range; thence easterly along the north line of Sections 6, 5, and 4, said Township and Range, to the northeast corner of said Section 4, said Township and Range; thence northerly along the centerline of Townships 7, 8, 9, 10, and 11 North, Range 5 West, to the northwest corner of Section 3, Township 11 North, Range 5 West, to the POINT OF BEGINNING.

DESCRIPTION OF SERVICE AREA  
VICTORVILLE MUNICIPAL UTILITY SERVICES AT AND AROUND THE  
SOUTHERN CALIFORNIA LOGISTICS AIRPORT

A. The service area for Victorville Municipal Utility Services within the City of Victorville, County of San Bernardino, State of California, San Bernardino Baseline and Meridian, includes the following described area:

1. Township 6 North, Range 5 West, All of Sections 11, 14, 22, and 23; and portions of Sections 10, 13, 15, 24, 25, 26, 27, and 36.

B. The aforesaid Victorville Municipal Utility Services area is more particularly described as follows:

BEGINING at the South one-quarter corner of said Section 26 as shown on that Record of Survey filed in Book 65, at Pages 98 through 102, of Records of Survey, Records of said County, said Record of Survey being a survey of "G.A.F.B. Federal Property" boundary;

Thence along the following courses as shown on said Record of Survey:

North 89 degrees 34 minutes 41 seconds West 2666.91 feet to the Southeast corner of said Section 27, said Southeast corner also being a corner of Parcel 1 of that Official Map No. 1003 as filed in Book 2 at Pages 16 through 20 of Official Maps, Records of said County;

South 89 degrees 33 minutes 56 seconds West 2668.68 feet to the South one-quarter corner of said Section 27;

South 89 degrees 33 minutes 37 seconds West 2001.17 feet to the Southeast corner of the West one-half of the West one-half of the West one-half of the South one-half of said Section 27;

North 00 degrees 37 minutes 29 seconds West 2649.16 feet to the Northeast corner of said West one-half of the West one-half of the West one-half of the South one-half of Section 27;

South 89 degrees 29 minutes 20 seconds West 667.80 feet to the West one-quarter corner of said Section 27;

DESCRIPTION OF SERVICE AREA  
VICTORVILLE MUNICIPAL UTILITY SERVICES AT AND AROUND THE  
SOUTHERN CALIFORNIA LOGISTICS AIRPORT

*(Continued)*

North 00 degrees 37 minutes 35 seconds West 2647.01 feet to the Northwest corner of said Section 27;

North 00 degrees 36 minutes 22 seconds West 5301.02 feet to the Northwest corner of said Section 22;

North 89 degrees 18 minutes 43 seconds East 2757.08 feet to the North one-quarter corner of said Section 22;

Along the North line of said Section 22 North 89 degrees 18 minutes 07 seconds East 537.00 feet;

Thence North 00 degrees 20 minutes 13 seconds West 5330.23 to a point in the North line of said Section 15, said point being distant North 89 degrees 09 minutes 00 seconds East 529.09 feet along said North line from the North one-quarter corner of said Section 15;

Thence leaving said "G.F.A.B. Federal Property" boundary, South 89 degrees 09 minutes 00 seconds West 529.09 feet to said North one-quarter corner of Section 15 as shown on said Record of Survey and as shown on Parcel Map No. 2892 filed in Book 26 Page 29 of Parcel Maps, Records of San Bernardino County and as shown on Parcel Map No. 1022 filed in Book 9 at Page 3 of Parcel Maps, said Records of San Bernardino County;

Thence North 01 degrees 02 minutes 25 seconds West 2678.60 feet to the center one-quarter corner of said Section 10 as shown on said Parcel Maps;

Thence North 01 degrees 02 minutes 09 seconds West 2668.83 feet to the North one-quarter corner of said Section 10 as shown on said Parcel Map No. 1022;

Thence North 89 degrees 30 minutes 09 seconds East 2643.60 feet to the Northeast corner of said Section 10 as shown on said Parcel Map No. 1022;

Thence South 89 degrees 53 minutes 22 seconds East 2667.61 feet to the north quarter corner of said Section 11, as shown on that Record of Survey filed in Book 37 Page 94 of Records of Survey;

Thence South 89 degrees 52 minutes 53 seconds East 2665.37 feet to the Northeast corner of said Section 11, as shown on last said Record of Survey;

DESCRIPTION OF SERVICE AREA  
VICTORVILLE MUNICIPAL UTILITY SERVICES AT AND AROUND THE  
SOUTHERN CALIFORNIA LOGISTICS AIRPORT

*(Continued)*

Thence South 01 degrees 06 minutes 11 seconds East 5394.07 feet to the northwest corner of said Section 13 as shown on last said Record of Survey and said Northwest corner being the Northeast corner of said Section 14;

Thence South 00 degrees 05 minutes 28 seconds East 2654.20 feet to the one-quarter corner of said Sections 13 and 14 as shown on said last said Record of Survey and as shown on said Record of Survey filed in Book 65 Pages 98 through 102, said one-quarter corner also being a corner of said Parcel 1 of Official Map No. 1003 and being a corner of said "G.A.F.B. Federal Property" boundary;

Thence along the boundary of said Parcel 1 and "G.A.F.B. Federal Property" boundary as shown on said Official Map and last said Record of Survey the following courses:

North 88 degrees 49 minutes 27 seconds East 2645.37 feet to the center one-quarter corner of said Section 13;

South 00 degrees 14 minutes 29 seconds East 2658.58 feet to the South one-quarter corner of said Section 13 as shown on said Record of Survey filed in Book 65 at Pages 98 through 102 and on that Record of Survey filed in Book 138 at Pages 89 through 101 of Records of Survey;

Thence leaving said "G.A.F.B. Federal Property" boundary, North 88 degrees 55 minutes 00 seconds East 1326.21 feet to the Northeast corner of the west one-half of the east one-half of said Section 24 as shown on last said Record of Survey;

Thence South 00 degrees 20 minutes 44 seconds East 5331.71 feet to the Southeast corner of said west one-half of the east one-half of said Section 24 as shown on last said Record of Survey and said Record of Survey filed in Book 65 Pages 98 through 102;

Thence North 89 degrees 15 minutes 45 seconds East 1328.68 feet to the Northeast corner of said Section 25 as shown on said Record of Survey filed in Book 65 at Pages 98 through 102;

DESCRIPTION OF SERVICE AREA  
VICTORVILLE MUNICIPAL UTILITY SERVICES AT AND AROUND THE  
SOUTHERN CALIFORNIA LOGISTICS AIRPORT

*(Continued)*

Thence South 00 degrees 20 minutes 05 seconds East 2685.61 feet to the East one-quarter corner of said Section 25, said one-quarter corner of Section 25 being an angle point the easterly line of said "G.A.F.B. Federal Property" boundary and an angle point in that land conveyed to the Southern California Logistics Airport Authority by that Quit Claim recorded as Document Number 2007-0557487 in the Official Records of the County Recorder of said County;

Thence along said "G.A.F.B. Federal Property" boundary and said boundary of land conveyed by Quit Claim Deed the following courses:

South 07 degrees 06 minutes 00 seconds West 2705.90 feet to the South line of said Section 25 and said South line being the North line of said Section 36;

North 89 degrees 57 minutes 26 seconds East 350.00 feet to the Northwest corner of said Section 36;

South 00 degrees 17 minutes 58 seconds East 1230.53 feet to a point in east line of said Section 36, said point being called the "intersection of Air Base Road" by the legal description of said Quit Claim Deed and said intersection also being shown on that Record of Survey filed in Book 102 Page 27 of Records of Survey, said Records of San Bernardino County;

Thence leaving said "G.A.F.B. Federal Property" boundary, continuing along the boundary of the land conveyed by said Quit Claim Deed and the centerline of Air Base Road the following courses:

North 66 degrees 56 minutes 18 seconds West 2886.28 feet to the beginning of a curve concave southerly and having a radius of 3000.00 feet;

Westerly along said curve through a central angle of 23 degrees 31 minutes 30 seconds an arc distance of 1231.77 feet;

South 89 degrees 32 minutes 12 seconds West 1459.91 feet to a point in the West line of said Section 25, said point being shown as the intersection of said west line and the centerline of Air Base Road shown on said Record of Survey filed in Book 102 Page 27 and shown on Parcel Map No. 18158 as filed in Book 217 of Parcel Maps at Pages 22 through 32, said Records of San Bernardino County;



DESCRIPTION OF SERVICE AREA  
VICTORVILLE MUNICIPAL UTILITY SERVICES AT AND AROUND THE  
SOUTHERN CALIFORNIA LOGISTICS AIRPORT

*(Continued)*

Thence leaving the boundary of land per said Quit Claim Deed, along said centerline, South 89 degrees 32 minutes 12 seconds West 2669.29 feet (2669.28 per last said Record of Survey) to the northerly extension of the West line of the Southeast one-quarter of Section 35 of Township 6 North, Range 5 West, San Bernardino Base and Meridian, as shown on last said Record of Survey;

Thence South 00 degrees 31 minutes 40 seconds East 90.39 feet as shown on last said Record of Survey to the POINT OF BEGINNING.

Excluding therefrom, all main lines, service lines, and risers owned and maintained by the Company and used to provide wholesale (resale) service to Victorville Municipal Utility Services or to provide legacy retail service to existing customers, as identified on Cal. P.U.C. Sheet No. 51.1 from the above described boundary area for Victorville Municipal Utility Services.

The basis of bearings for this description is North 89 degrees 34 minutes 41 seconds West on the south line of the southwest one-quarter of Section 26 of Township 6 North, Range 5 West, San Bernardino Meridian, as shown on that Record of Survey filed in Book 65, at Pages 98 through 102, of Records of Survey, Records of the County of San Bernardino, California.

N  
N

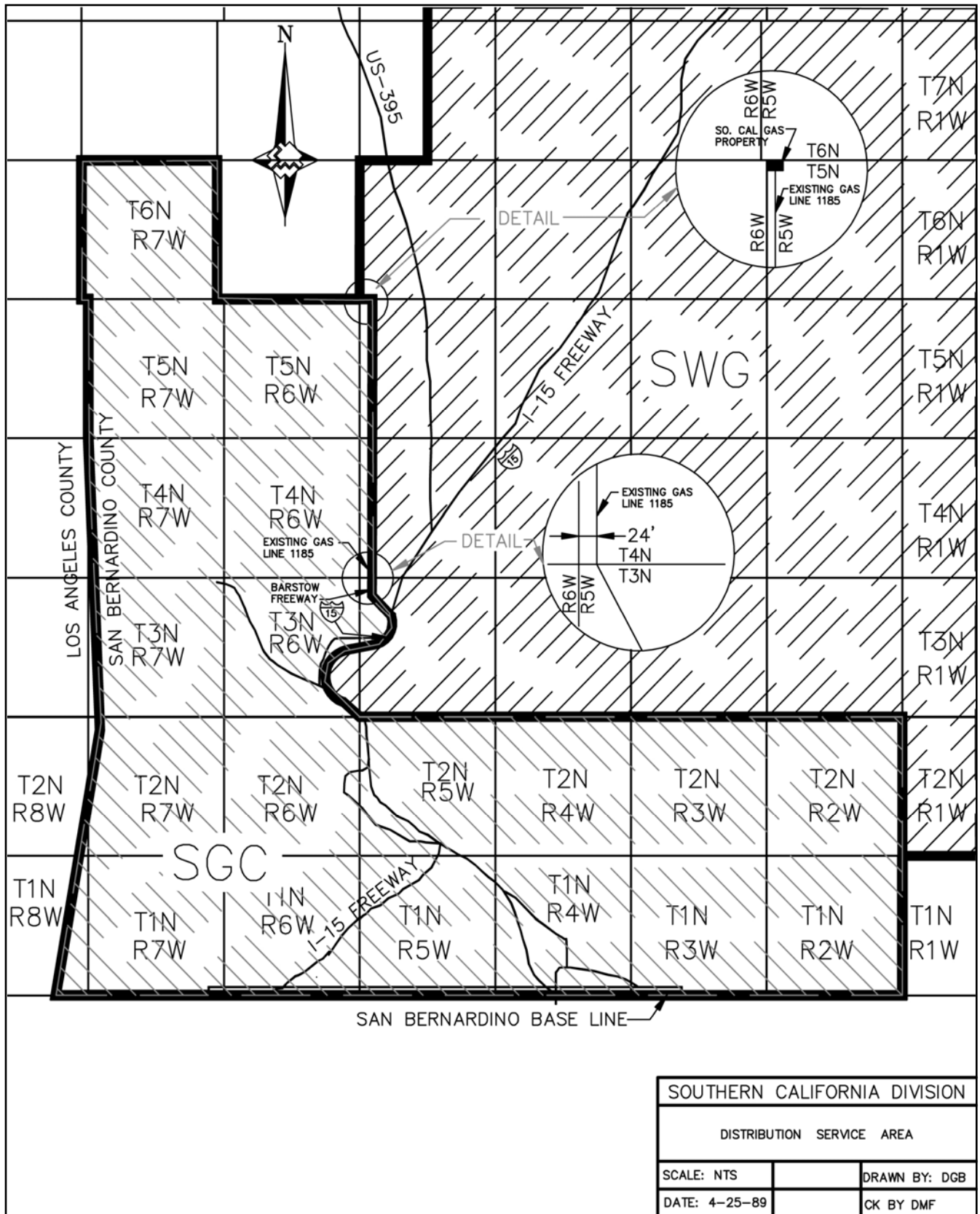

SOUTHERN CALIFORNIA DIVISION	
DISTRIBUTION SERVICE AREA	
SCALE: NTS	DRAWN BY: DGB
DATE: 4-25-89	CK BY DMF

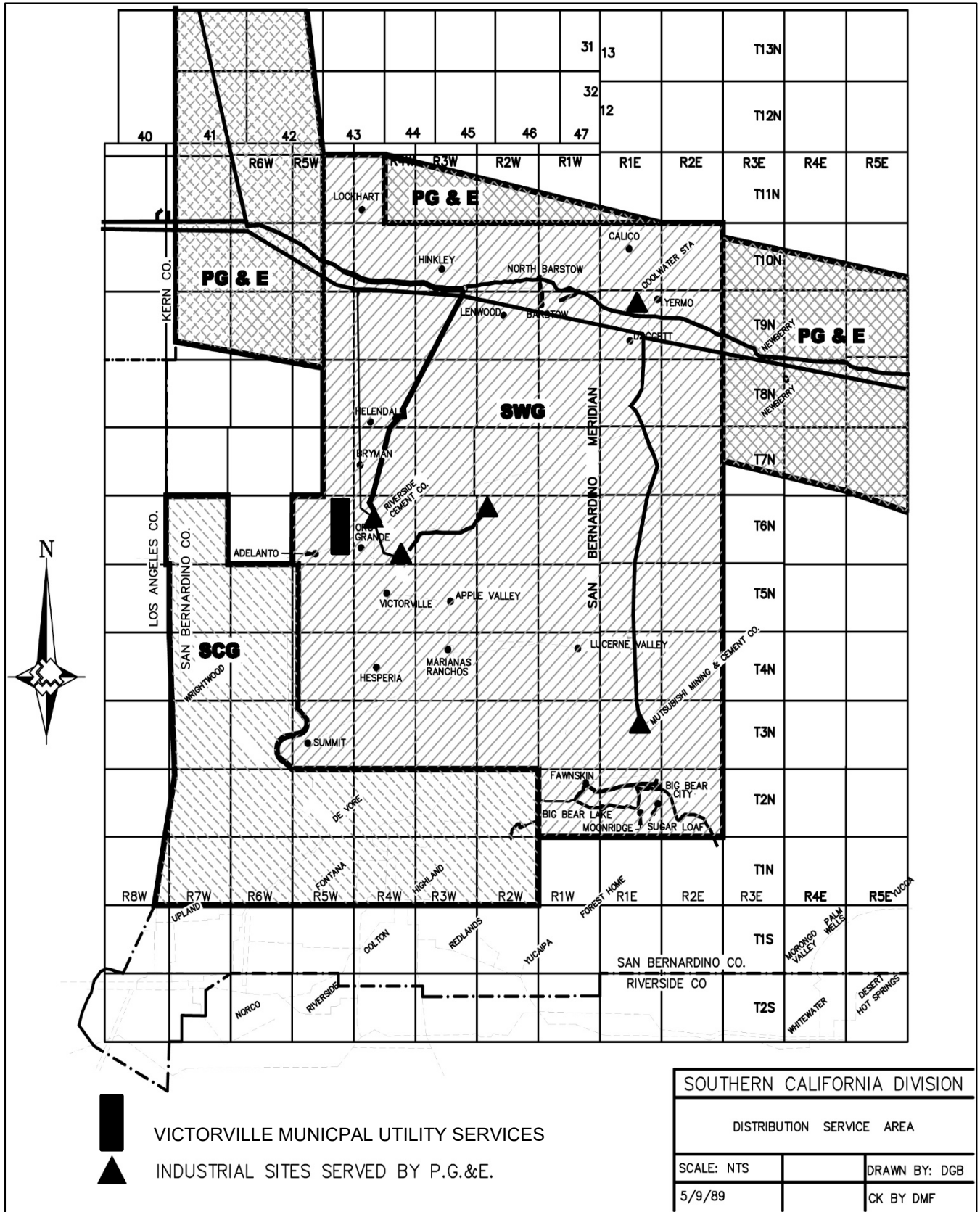

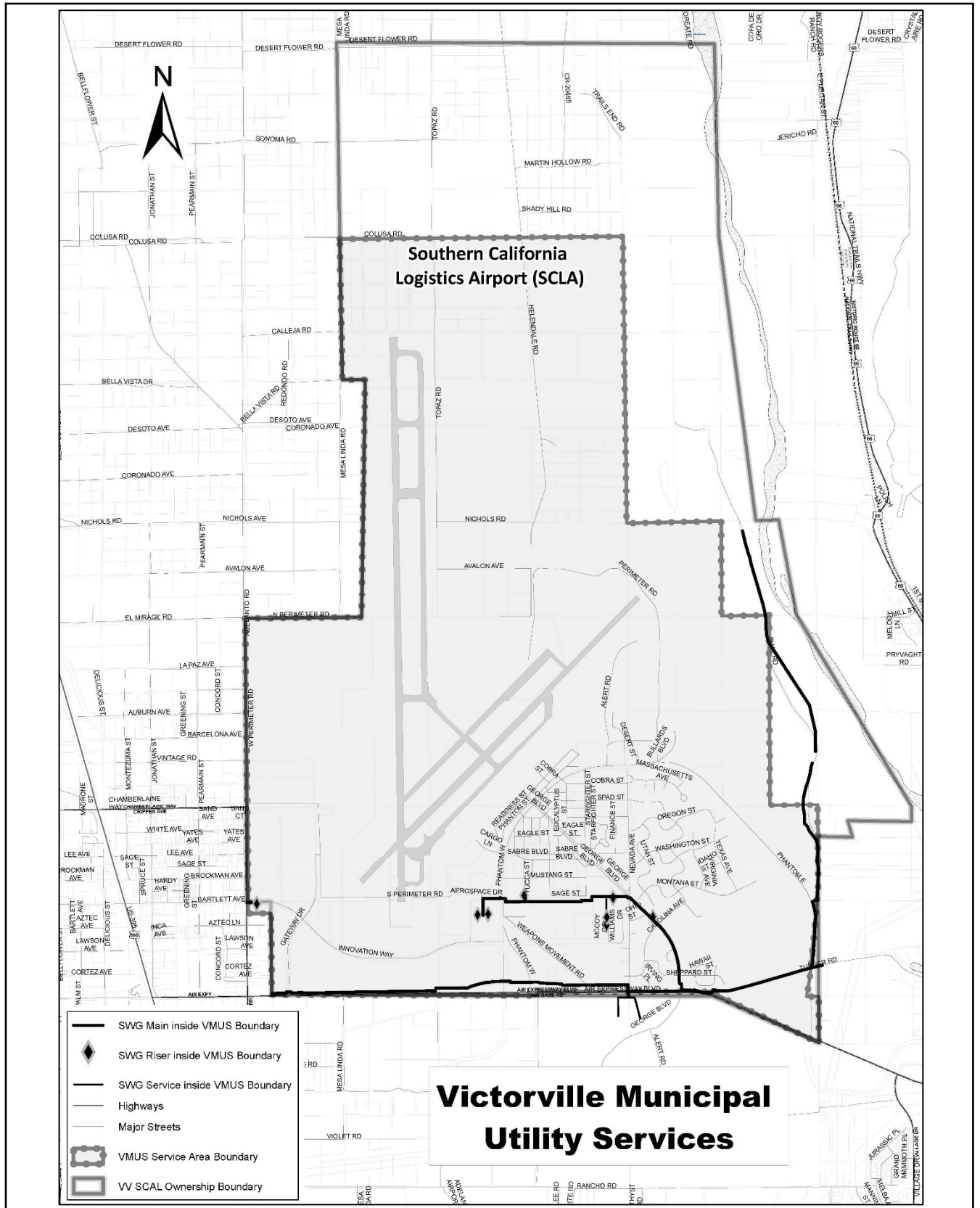

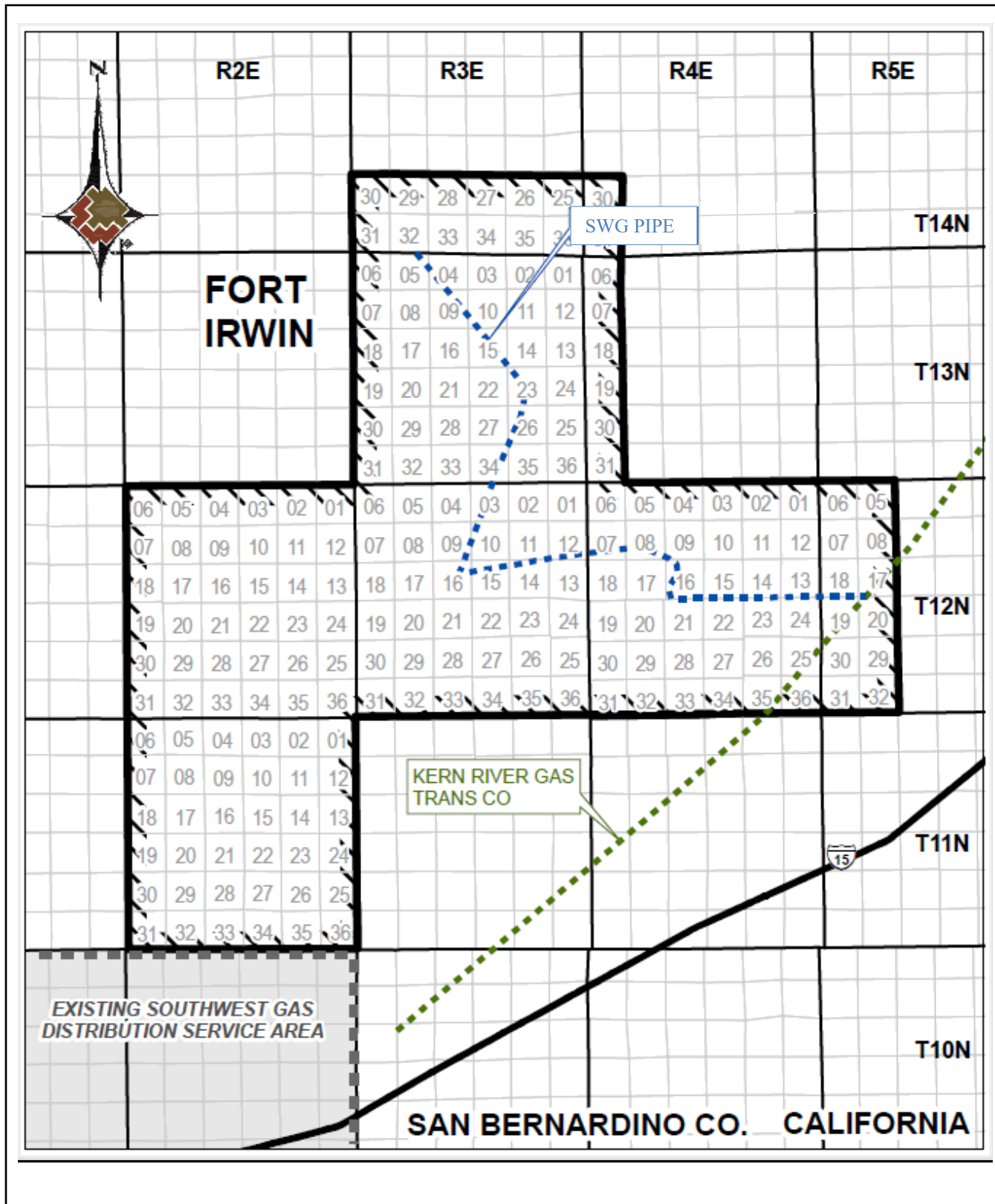

DESCRIPTION OF SERVICE AREA  
(Continued)

- A. The service area of Southwest Gas Corporation within the County of San Bernardino, State of California, San Bernardino Baseline and Meridian, includes the following described area:
1. Township 14 North, Range 3 East, All of Sections 25, 26, 27, 28, 29, 30, 31, 32, 33, 34, 35, and 36.
  2. Township 14 North, Range 4 East, All of Sections 30 and 31.
  3. Township 13 North, Range 3 East, All of Sections 1 through 36.
  4. Township 13 North, Range 4 East, All of Sections 6, 7, 18, 19, 30, and 31.
  5. Township 12 North, Range 2 East, All of Sections 1 through 36.
  6. Township 12 North, Range 3 East, All of Sections 1 through 36.
  7. Township 12 North, Range 4 East, All of Sections 1 through 36.
  8. Township 12 North, Range 5 East, All of Sections 5, 6, 7, 8, 17, 18, 19, 20, 29, 30, 31, and 32.
  9. Township 11 North, Range 2 East, All of Sections 1 through 36.

N  
N

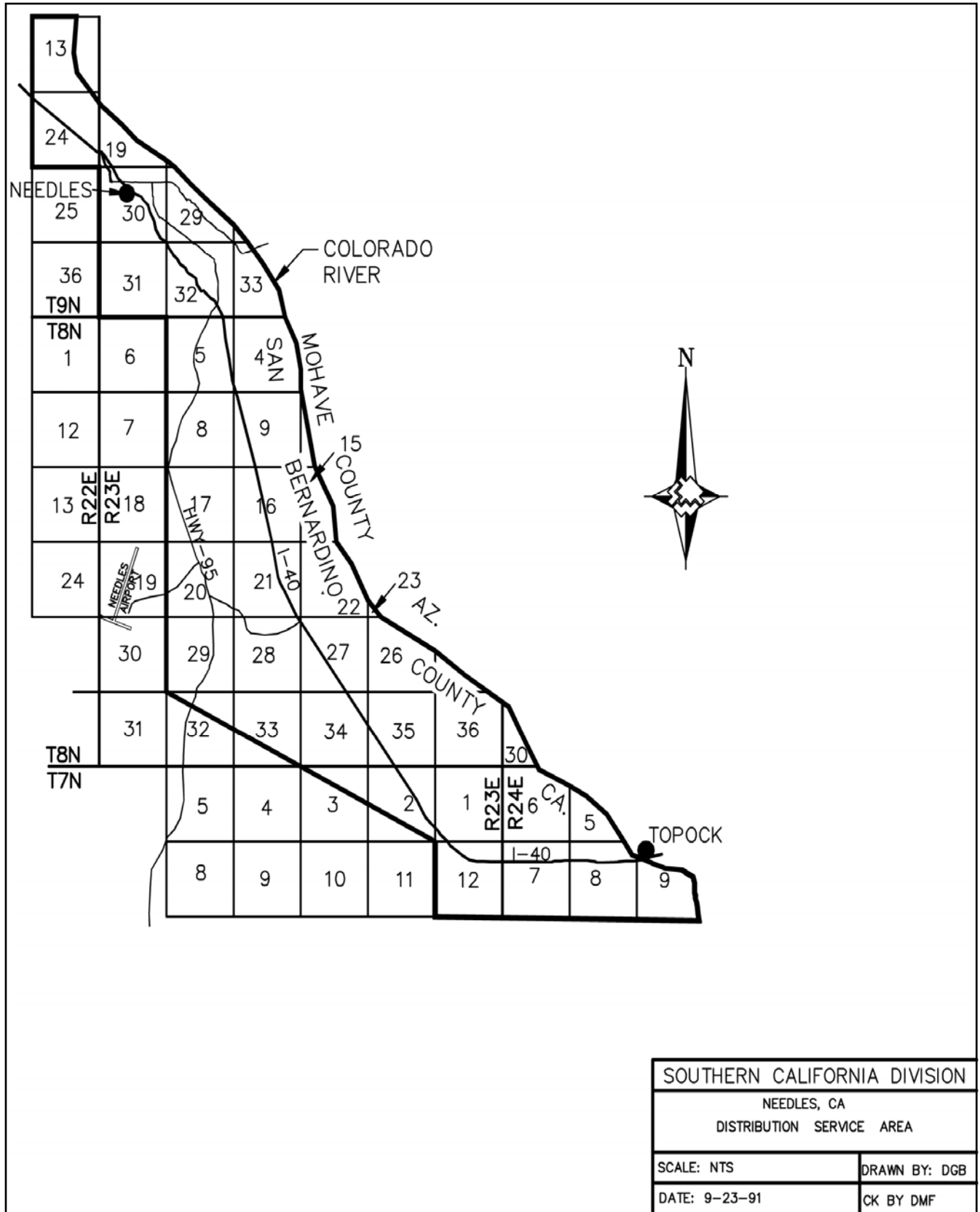

DESCRIPTION OF SERVICE AREA  
NEEDLES, CALIFORNIA

- A. The service area of Southwest Gas Corporation within the County of San Bernardino, State of California, San Bernardino Baseline and Meridian, includes the following described area:
1. Township 7 North, Range 23 East, All of Sections 1 and 12; all of that portion of Sections 2 and 3 lying northerly of the prolongation of a line from the southeast corner of Section 2, to the northwest corner of Section 32, Township 8 North, Range 23 East.
  2. Township 7 North, Range 24 East, All of Section 7; all of that portion of Sections 5, 6, 8 and 9 lying west of the California/Arizona state boundary.
  3. Township 8 North, Range 23 East, All of Sections 5, 8, 16, 17, 20, 21, 27, 28, 29, 34 and 35; all of that portion of Sections 4, 9, 10, 11, 12, 13, 14, 15, 22, 23, 24, 25, 26 and 36 lying west of the California/Arizona state boundary; all of that portion of Sections 32, 33 and 34 lying northerly of the prolongation of a line from the southeast corner of Section 2, Township 7 North, Range 23 East, to the northwest corner of said Section 32.
  4. Township 8 North, Range 24 East, All of that portion of Section 31 lying west of the California/Arizona state boundary.
  5. Township 9 North, Range 23 East, All of Sections 30, 31 and 32; all of that portion of Sections 19, 20, 28, 29 and 33 lying west of the California/Arizona state boundary.
  6. Township 9 North, Range 22 East, All of Section 24; all of that portion of Section 13 lying west of the California/Arizona state boundary.



DESCRIPTION OF SERVICE AREA  
NEEDLES, CALIFORNIA  
(Continued)

- B. The aforesaid Southern California service area of Southwest Gas Corporation is more particularly described as follows:

BEGINNING at the southeast corner of Section 31, Township 9 North, Range 23 East; thence westerly along the south line of said Section 31, to the southwest corner thereof; thence northerly along the west line of Sections 30 and 31, to the northwest corner of said Section 30; thence westerly along the south line of Section 24, Township 9 North, Range 22 East, S.B.B. & M, to the southwest corner thereof; thence northerly along the west line of Sections 13 and 24, said Township and Range, to the northwest corner of said Section 13; thence easterly along the north line of said Section 13, to the California/Arizona state boundary; thence southeasterly along the California/Arizona state boundary to the south line of Section 9, Township 7 North, Range 24 East; thence westerly along the south line of Sections 7, 8 and 9 of Township 7 North, Range 24 West and Section 12, Township 7 North, Range 23 East, to the southwest corner of said Section 12; thence northerly along the west line of said Section 12, to the northwest corner thereof; thence northwesterly through Sections 2 and 3 of Township 7 North, Range 23 East, and Sections 32, 33 and 34, Township 8 North, Range 23 East, to the northwest corner of said Section 32; thence northerly along the west line of Sections 5, 8, 17, 20 and 29, to the southeast corner of Section 31, Township 9 North, Range 23 East; said southeast corner, also being the POINT OF BEGINNING.

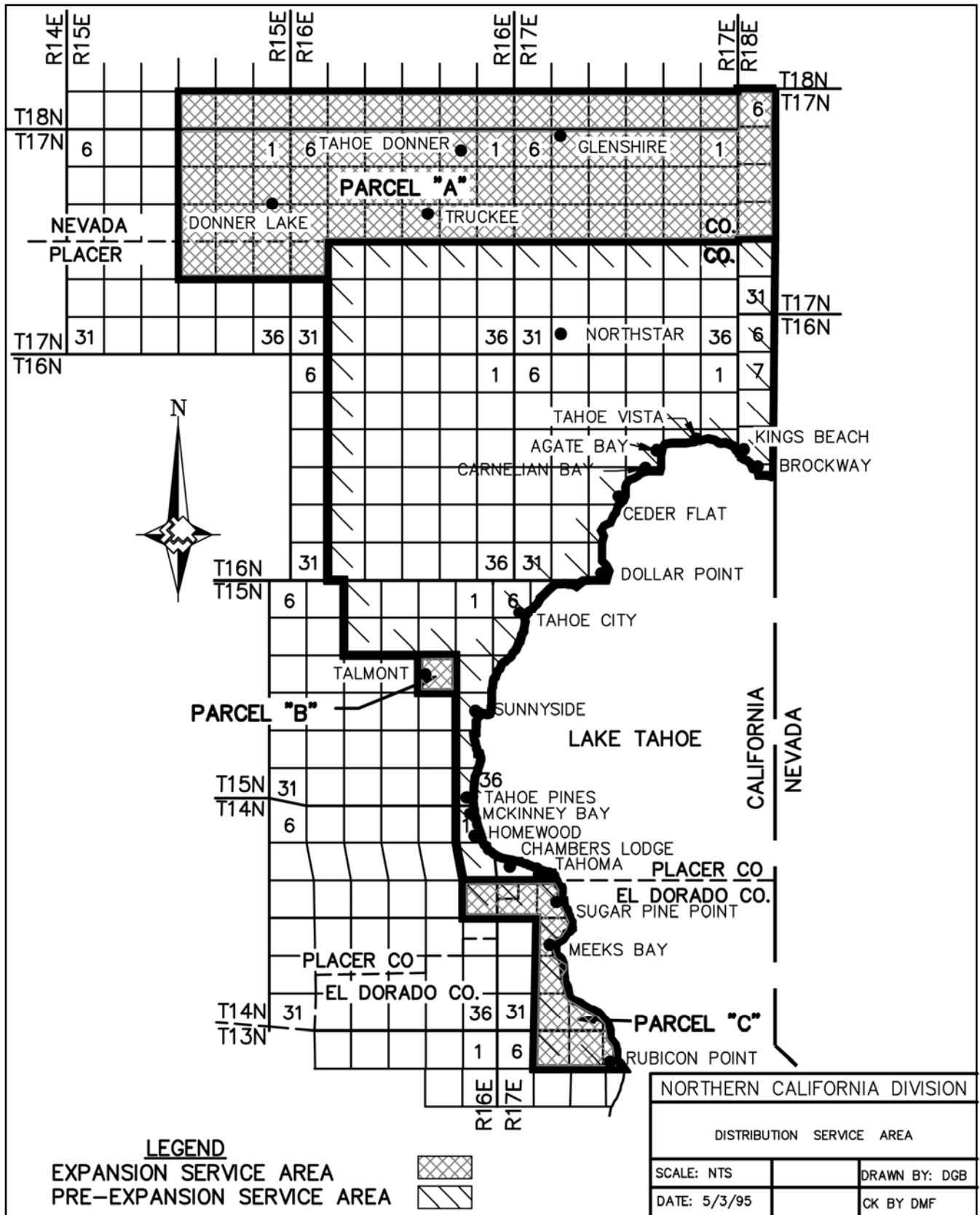

DESCRIPTION OF EXPANSION SERVICE AREA

- A. The expansion service area of Southwest Gas Corporation in or near Truckee, Counties of Nevada and Placer (Parcel "A"); Talmont, County of Placer (Parcel "B"); and El Dorado, Counties of El Dorado and Placer (Parcel "C"), State of California, Mount Diablo Baseline and Meridian, includes the following described area:

PARCEL "A":

1. Township 18 North, Range 15 East, All of Sections 34, 35 and 36.
2. Township 18 North, Range 16 East, All of Sections 31, 32, 33, 34, 35 and 36.
3. Township 18 North, Range 17 East, All of Sections 31, 32, 33, 34, 35 and 36.
4. Township 17 North, Range 15 East, All of Sections 1, 2, 3, 10, 11, 12, 13, 14, 15, 22, 23 and 24.
5. Township 17 North, Range 16 East, All of Sections 1, 2, 3, 4, 5, 6, 7, 8, 9, 10, 11, 12, 13, 14, 15, 16, 17 and 18.
6. Township 17 North, Range 17 East, All of Sections 1, 2, 3, 4, 5, 6, 7, 8, 9, 10, 11, 12, 13, 14, 15, 16, 17 and 18.
7. Township 17 North, Range 18 East, All that portion of Sections 6, 7, 18 and 19 west of the California/Nevada State Boundary Line.

PARCEL "B":

1. Township 15 North, Range 16 East, All of Section 14.

PARCEL "C":

1. Township 14 North, Range 16 East, All of Section 13.
2. Township 14 North, Range 17 East, All of Section 18; All that portion of Sections 16, 17, 20, 21, 28, 29, 32 and 33, west of the Lake Tahoe Shore Line.
3. Township 13 North, Range 17 East, All of Section 5; All that portion of Sections 3 and 4, west of the Lake Tahoe Shore Line.

DESCRIPTION OF EXPANSION SERVICE AREA  
(Continued)

- B. The aforesaid Truckee (Parcel "A"); Talmont (Parcel "B"); and El Dorado (Parcel "C"), California, expansion service area of Southwest Gas Corporation is more particularly described area:

PARCEL "A":

BEGINNING at the northwest (NW) corner of Section 34, Township 18 North, Range 15 East, M.D.B.& M., Nevada County, California; thence easterly along the north line of Sections 34, 35 and 36, to the northeast (NE) corner of said Section 36; thence continuing easterly along the north line of Sections 31, 32, 33, 34, 35 and 36, Township 18 North, Range 16 East, M.D.B.& M., to the northeast (NE) corner of Section 36, said township and range; thence continuing easterly along the north line of Sections 31, 32, 33, 34, 35 and 36, Township 18 North, Range 17 East, M.D.B.& M., to the northeast (NE) corner of Section 36, said township and range; thence continuing easterly along the north line of Section 6, Township 17 North, Range 18 East, M.D.B.& M., to a point on the California/Nevada State Boundary Line; thence southerly along the California/Nevada State Boundary Line through Sections 6, 7, 18 and 19, said township and range, to the southeast (SE) corner of Section 19, on the Nevada/Placer County Line; thence westerly along the Nevada/Placer County Line to the southwest (SW) corner of Section 19, said township and range; thence continuing westerly along the south line of Sections 13, 14, 15, 16, 17 and 18, Township 17 North, Range 17 East, to the southwest (SW) corner of Section 18, said township and range; thence continuing westerly along the south line of Sections 13, 14, 15, 16 and 17, Township 17 North, Range 16 East, M.D.B.& M., to the southwest (SW) corner of Section 17, said township and range; thence southerly along the east line of Section 19, to the southeast (SE) corner of said Section 19; thence westerly along the south line of Section 19 to the southwest (SW) corner of said Section 19; thence continuing westerly along the south line of Sections 24, 23 and 22, Township 17 North, Range 15 East, M.D.B.& M., to the southwest (SW) corner of said Section 22; thence northerly through the Placer/Nevada County line along the west line of Sections 22, 15, 10 and 3, said township and range, to the northwest (NW) corner of Section 3; thence continuing northerly along the west line of Section 34, Township 18 North, Range 15 East, M.D.B.& M., to the northwest (NW) corner of said Section 34, said corner being the POINT OF BEGINNING.

DESCRIPTION OF EXPANSION SERVICE AREA  
(Continued)

PARCEL "B":

BEGINNING at the northwest (NW) corner of Section 14, Township 15 North, Range 16 East, M.D.B.& M., Placer County, California; thence easterly along the north line to the northeast (NE) corner of said Section 14; thence southerly along the east line to the southeast (SE) corner of said Section 14; thence westerly along the south line to the southwest (SW) corner of said Section 14; thence northerly along the west line to the northwest (NW) corner of said section, township and range, said corner being the POINT OF BEGINNING.

PARCEL "C":

BEGINNING at the northwest (NW) corner of Section 13, Township 14 North, Range 16 East, M.D.B.& M., Placer County, California; thence easterly along the north line of Section 13, to the northeast (NE) corner of Section 13, said township and range; thence continuing easterly along the north line of Sections 18 and 17 (along the El Dorado and Placer County Line-north line of Sections 18 and 17), Township 14 North, Range 17 East, M.D.B.& M., to a point in Section 17, said point being the Shore Line of Lake Tahoe; thence continuing in a southeasterly direction along the meandering Lake Tahoe Shore Line through Sections 16, 17, 20, 21, 28, 29, 32 and 33, to a point on the southerly line of Section 33, said township and range; thence continuing in a southeasterly direction along the meandering of the Lake Tahoe Shore Line in Sections 4 and 3, Township 13 North, Range 17 East, M.D.B.& M., to a point in Section 3, said point being the south line of Section 3; thence westerly along the south line of Sections 3, 4 and 5, to the southwest (SW) corner of said Section 5; thence northerly along the west line of Section 5, to the northwest (NW) corner of Section 5, said township and range; thence continuing northerly along the west line of Sections 32, 29 and 20, Township 14 North, Range 17 East, M.D.B.& M., to the northwest (NW) corner of said Section 20, said township and range; thence westerly along the south line of Section 18, said township and range, to the southwest (SW) corner of Section 18, said township and range; thence continuing westerly (through the El Dorado/Placer County Line - Sections 18 and 13) along the south line of Section 13, Township 14 North, Range 16 East, M.D.B.& M., to the southwest (SW) corner of Section 13, said township and range; thence northerly along the west line of Section 13, to the northwest (NW) corner of said Section 13, said township and range, said corner being the POINT OF BEGINNING.

DESCRIPTION OF PRE-EXPANSION SERVICE AREA

- A. The pre-expansion service area of Southwest Gas Corporation within the County of Placer, State of California, Mount Diablo Baseline and Meridian, includes the following described area:
1. Township 17 North, Range 16 East, All of Sections 20, 21, 22, 23, 24, 25, 26, 27, 28, 29, 32, 33, 34, 35 and 36.
  2. Township 17 North, Range 17 East, All of Sections 19, 20, 21, 22, 23, 24, 25, 26, 27, 28, 29, 30, 31, 32, 33, 34, 35 and 36.
  3. Township 17 North, Range 18 East, All that portion of Sections 30 and 31 west of the California/Nevada State Boundary Line.
  4. Township 16 North, Range 16 East, All of Sections 1, 2, 3, 4, 5, 8, 9, 10, 11, 12, 13, 14, 15, 16, 17, 20, 21, 22, 23, 24, 25, 26, 27, 28, 29, 32, 33, 34, 35 and 36.
  5. Township 16 North, Range 17 East, All of Sections 1, 2, 3, 4, 5, 6, 7, 8, 9, 10, 11, 12, 16, 17, 18, 19, 20, 29, 30, 31 and 32; All that portion of Sections 13, 14, 15, 21, 22, 28 and 33 north and west of the Lake Tahoe Shore Line.
  6. Township 16 North, Range 18 East, All that portion of Sections 6, 7, 18, 19 and 30 west of the California/Nevada State Boundary Line; All that portion of Sections 19 and 30 east of the Lake Tahoe Shore Line.
  7. Township 15 North, Range 16 East, All of Sections 1, 2, 3, 4, 9, 10, 11, 12 and 13; All that portion of Sections 24, 25 and 36 west of the Lake Tahoe Shore Line.
  8. Township 15 North, Range 17 East, All that portion of Sections 4, 5, 6, 7, 18 and 19 west of the Lake Tahoe Shore Line.
  9. Township 14 North, Range 16 East, All that portion of Sections 1 and 12 west of the Lake Tahoe Shore Line.
  10. Township 14 North, Range 17 East, All that portion of Sections 7 and 8 south of the Lake Tahoe Shore Line.

DESCRIPTION OF PRE-EXPANSION SERVICE AREA  
(Continued)

- B. The aforesaid Placer County, California, pre-expansion service area of Southwest Gas Corporation is more particularly described as follows:

BEGINNING at the northwest (NW) corner of Section 20, Township 17 North, Range 16 East, M.D.B.& M., Placer County, California; thence easterly along the north line of Sections 20, 21, 22, 23 and 24, to the northeast (NE) corner of said Section 24; thence continuing easterly along the north line of Sections 19, 20, 21, 22, 23 and 24, to the northeast (NE) corner of Section 24, Township 17 North, Range 17 East, M.D.B.& M.; thence continuing easterly along the north line of Section 30, Township 17 North, Range 18 East, M.D.B.& M., to a point on the California/Nevada State Boundary Line; thence southerly along the California/Nevada State Boundary Line through Sections 30 and 31, to the south line of said Section 31, said township and range; thence continuing southerly along the California/Nevada State Boundary Line through Sections 6, 7, 18, 19 and 30, Township 16 North, Range 18 East, M.D.B.& M., to a point, said point being the Shore Line of Lake Tahoe; thence in a northwesterly direction along the meandering Lake Tahoe Shore Line through Sections 30 and 19, to a point, said point being the west line of Section 19, said township and range; thence continuing in a southwesterly direction along the meandering Lake Tahoe Shore Line through Sections 13, 14, 15, 22, 21, 28 and 33, Township 16 North, Range 17 East, M.D.B.& M., to a point, said point being the south line of Section 33, said township and range; thence continuing in a southwesterly direction along the meandering Lake Tahoe Shore Line through Sections 4, 5, 6, 7, 18 and 19, Township 15 North, Range 17 East, M.D.B.& M., to a point, said point being the west line of Section 19, said township and range; thence continuing in a southerly direction along the meandering Lake Tahoe Shore Line through Sections 24, 25 and 36, Township 15 North, Range 16 East, M.D.B.& M., to a point, said point being the south line of Section 36, said township and range; thence continuing in a southeasterly direction along the meandering Lake Tahoe Shore Line through Sections 1 and 12, Township 14 North, Range 16 East, M.D.B.& M., to a point, said point being the east line of Section 12, said township and range; thence continuing in a southeasterly direction along the meandering Lake Tahoe Shore Line through Sections 7 and 8, Township 14 North, Range 17 East, M.D.B.& M., to a point, said point being the south line of Section 8, said township and range; thence westerly along the south line of Sections 8 and 7, to the southwest (SW) corner of Section 8, said township and range; thence continuing westerly along the south line of Section 12, Township 14 North, Range 16 East, M.D.B.& M., to the southwest (SW) corner of Section 12, said township and range;

DESCRIPTION OF PRE-EXPANSION SERVICE AREA  
(Continued)

thence northerly along the west line of Sections 12 and 1, to the northwest (NW) corner of said Section 1, township and range; thence continuing northerly along the west line of Sections 36, 25, 24 and 13, to the northwest (NW) corner of said Section 13, Township 15 North, Range 16 East, M.D.B. & M.; thence westerly along the south line of Sections 11, 10 and 9, to the southwest (SW) corner of Section 9, said township and range; thence northerly along the west line of Sections 9 and 4, to the northwest (NW) corner of Section 4, said township and range; thence westerly along the south line of Section 32, to the southwest (SW) corner of Section 32, Township 16 North, Range 16 East, M.D.B. & M., thence northerly along the west line of Sections 32, 29, 20, 17, 8 and 5, to the northwest (NW) corner of Section 5, said township and range; thence continuing northerly along the west line of Sections 32, 29 and 20, to the northwest (NW) corner of Section 20, Township 17 North, Range 16 East, M.D.B. & M., said corner being the POINT OF BEGINNING.



SOUTHWEST GAS CORPORATION  
P.O. Box 98510  
Las Vegas, Nevada 89193-8510  
California Gas Tariff

Canceling \_\_\_\_\_

Original \_\_\_\_\_

Cal. P.U.C. Sheet No. \_\_\_\_\_

62

Cal. P.U.C. Sheet No. \_\_\_\_\_

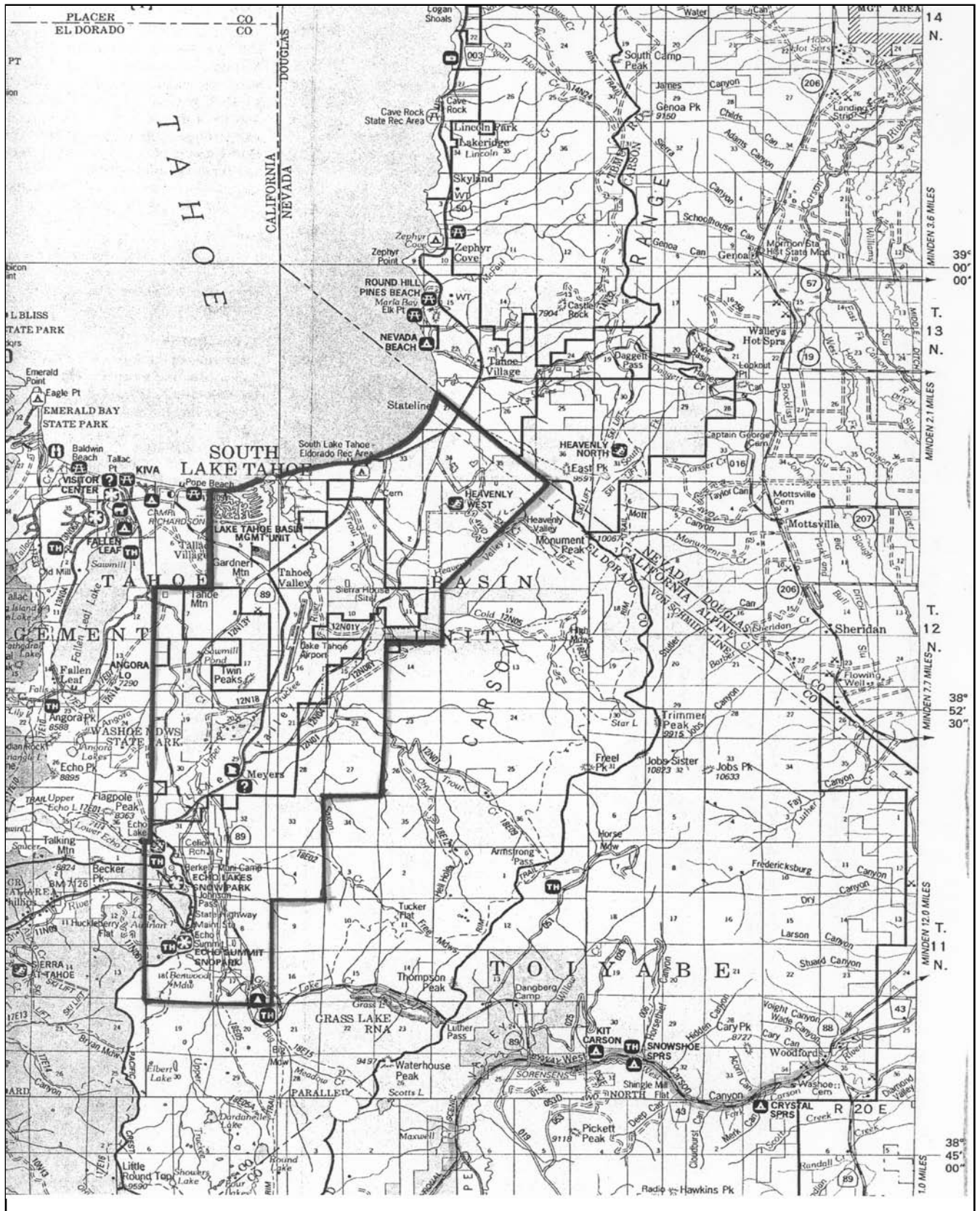

Advice Letter No. 864  
Decision No. \_\_\_\_\_

Issued by  
John P. Hester  
Senior Vice President

Date Filed March 23, 2011  
Effective April 24, 2011  
Resolution No. \_\_\_\_\_

DESCRIPTION OF SERVICE AREA

1. The expansion service area of Southwest Gas Corporation in or near South Lake Tahoe, County of El Dorado, State of California, Mount Diablo Baseline and Meridian, includes the following described area:
  - A. Township 13 North, Range 18 East, All of Section 34; All that portion of fractional Sections 28, 31, 32 and 33 southeast of the Lake Tahoe Shore Line; All that portion of Sections 26, 35 and 36 west of the California/Nevada State Boundary Line. All that portion of fractional Section 27 southeast of the Lake Tahoe Shore Line and west of the California/Nevada State Boundary Line.
  - B. Township 12 North, Range 18 East, All of Sections 2, 3, 4, 7, 8, 9, 10, 11, 15, 16, 17, 18, 19, 20, 21, 22, 27, 28, 29, 30, 31, 32 and 33; All that portion of fractional Section 5, south of the Lake Tahoe Shore Line; all that portion of Section 1 southwest of the California/ Nevada State Boundary Line and northwest of a line from the intersection of the California/Nevada State Boundary Line with the El Dorado/Alpine County Line and the southwest corner of said Section 1.
  - C. Township 11 North, Range 18 East, All of Sections 4, 5, 6, 7, 8, 17 and 18.

DESCRIPTION OF SERVICE AREA  
(Continued)

2. The aforesaid South Lake Tahoe, California, expansion service area of Southwest Gas Corporation is more particularly described as follows:

BEGINNING at the intersection of the southeast Lake Tahoe Shore Line and the California/Nevada State Boundary Line in fractional Section 27, Township 13 North, Range 18 East, M.D.B. & M., El Dorado County, California; thence southeasterly along said State Boundary Line through said fractional Section 27, Sections 26, 35 and 36, said township and range, to a point on the north line of Section 1, Township 12 North, Range 18 East, M.D.B.& M.; thence continuing southeasterly along said State Boundary Line to a point on the El Dorado/Alpine County Line; thence southwesterly to the northeast corner of Section 11, said township and range; thence south along the east line of said Section 11 to the southeast corner of said Section 11; thence west along the south line of said Section 11 to the northeast corner of Section 15, said township and range; thence south along the east lines of Sections 15, 22 and 27, said township and range, to the southeast corner of said Section 27; thence west along the south line of said Section 27, to the northeast corner of Section 33, said township and range; thence south along the east line of said Section 33, and the east line of Section 4, Township 11 North, Range 18 East, M.D.B.& M., to the southeast corner of said Section 4; thence west along the south line of said Section 4 to the northeast corner of Section 8, said township and range; thence south along the east lines of Sections 8 and 17, said township and range, to the southeast corner of said Section 17; thence west along the south lines of Sections 17 and 18, said township and range, to the southwest corner of said Section 18; thence north along the west lines of Sections 18, 7 and 6, said township and range, and the west lines of Sections 31, 30, 19, 18 and 7, Township 12 North, Range 18 East, M.D.B.& M., to the northwest corner of said Section 7; thence east along the north line of said Section 7 to the southwest corner of Section 5, said township and range; thence north along the west line of fractional Section 5, said township and range, to the southerly Shore Line of Lake Tahoe; thence in an easterly direction along the meandering of the Lake Tahoe Shore Line coincident with the north lines of fractional Section 5, Township 12 North, Range 18 East, M.D.B.& M., fractional Sections 31, 32, 33, 28 and 27, in Township 13 North, Range 18 East, M.D.B.&M., to the POINT OF BEGINNING.