

SOUTHWEST GAS CORPORATION
 P.O. Box 98510
 Las Vegas, Nevada 89193-8510
 Arizona Gas Tariff No. 7
 Arizona Division

Canceling First Revised A.C.C. Sheet No. 123
Original A.C.C. Sheet No. 123

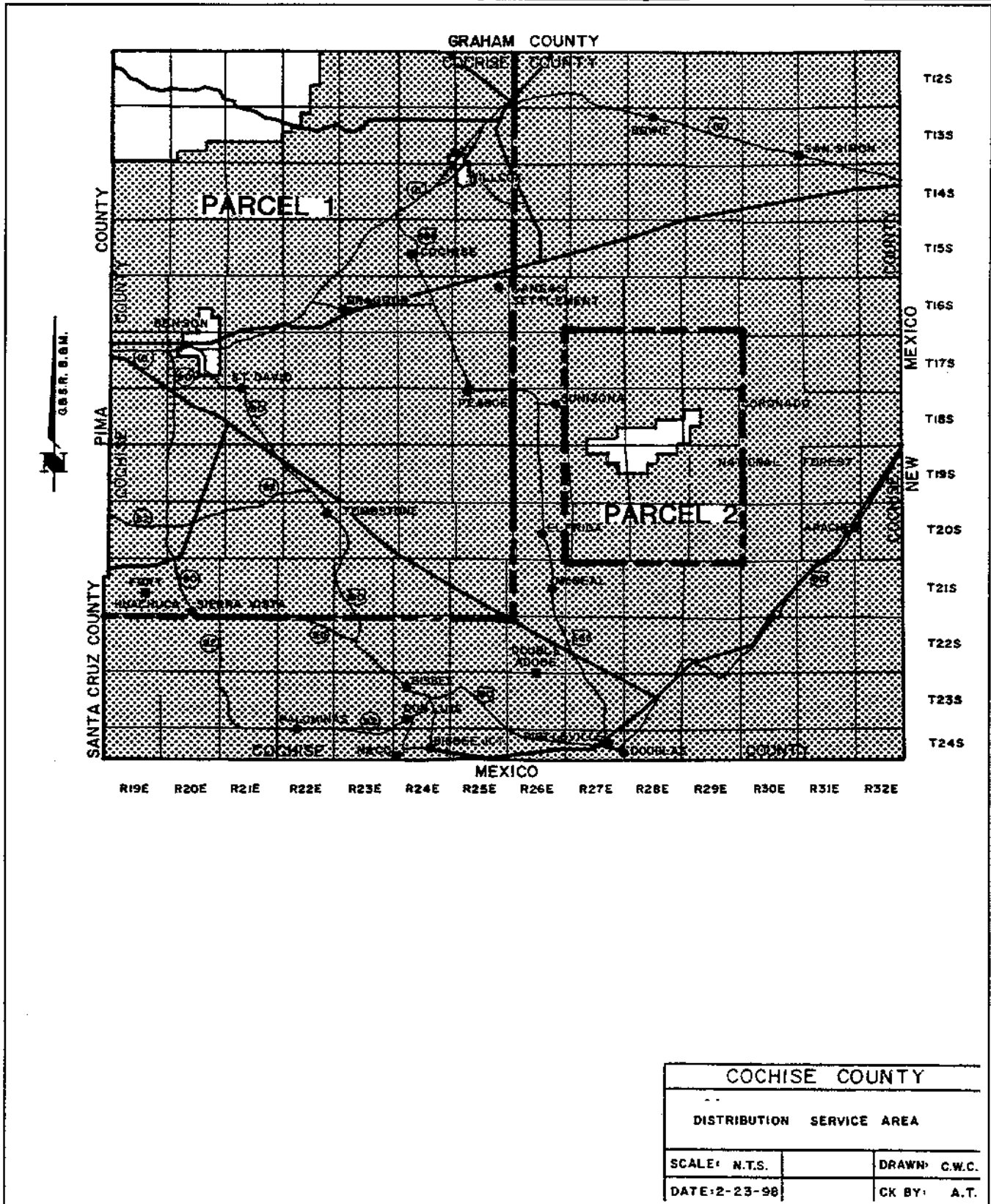

Issued On March 2, 1998
 Docket No. G-01551A-97-0226

Issued by
 Edward S. Zub
 Senior Vice President

Effective March 4, 1998
 Decision No. 60591

SOUTHWEST GAS CORPORATION
 P.O. Box 98510
 Las Vegas, Nevada 89193-8510
 Arizona Gas Tariff No. 7
 Arizona Division

First Revised _____ A.C.C. Sheet No. 124
 Original _____ A.C.C. Sheet No. 124
 Cancelling _____

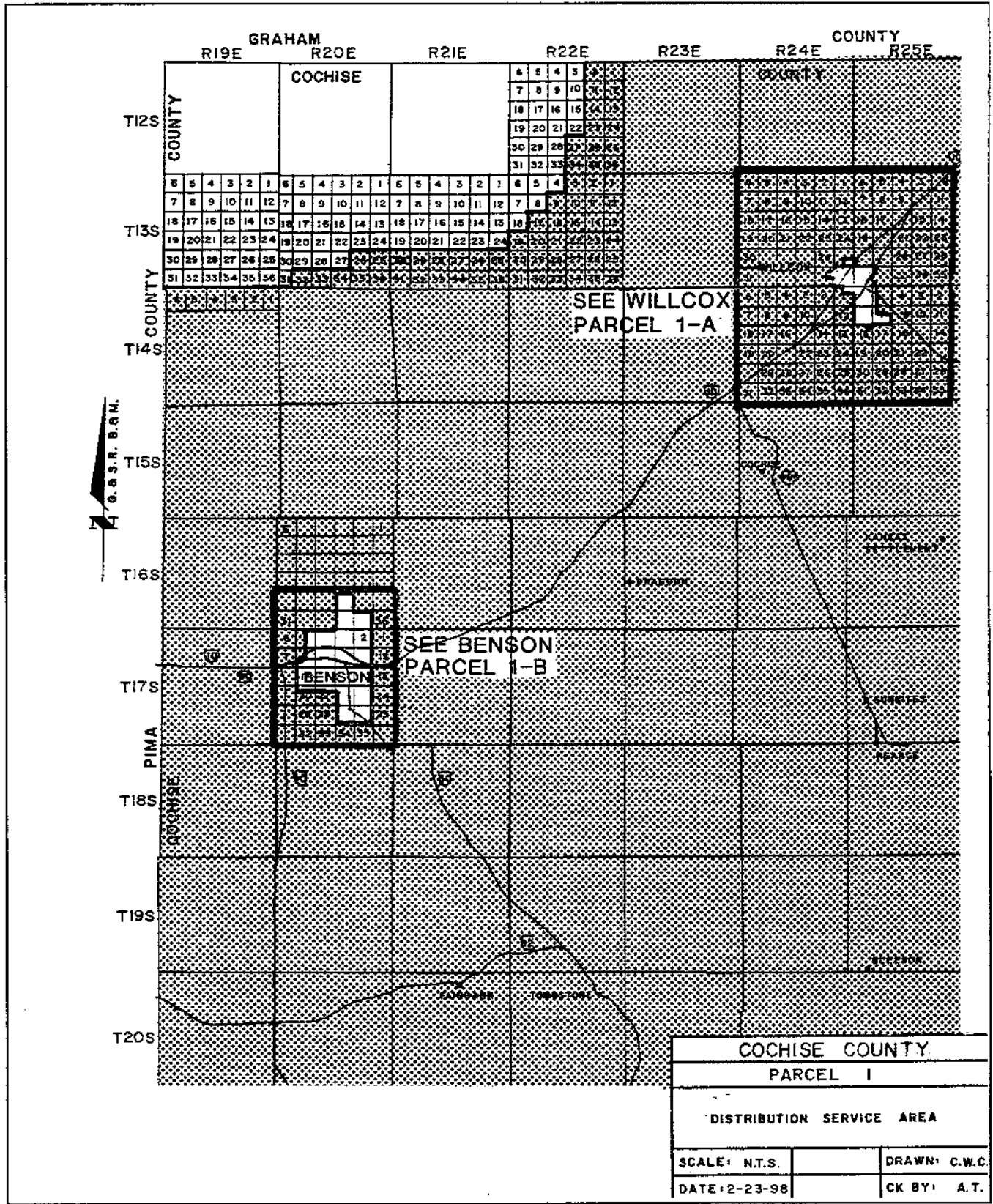

Issued On March 2, 1998 Issued by Edward S. Zub Effective March 4, 1998
 Docket No. G-01551A-97-0226 Senior Vice President Decision No. 60591

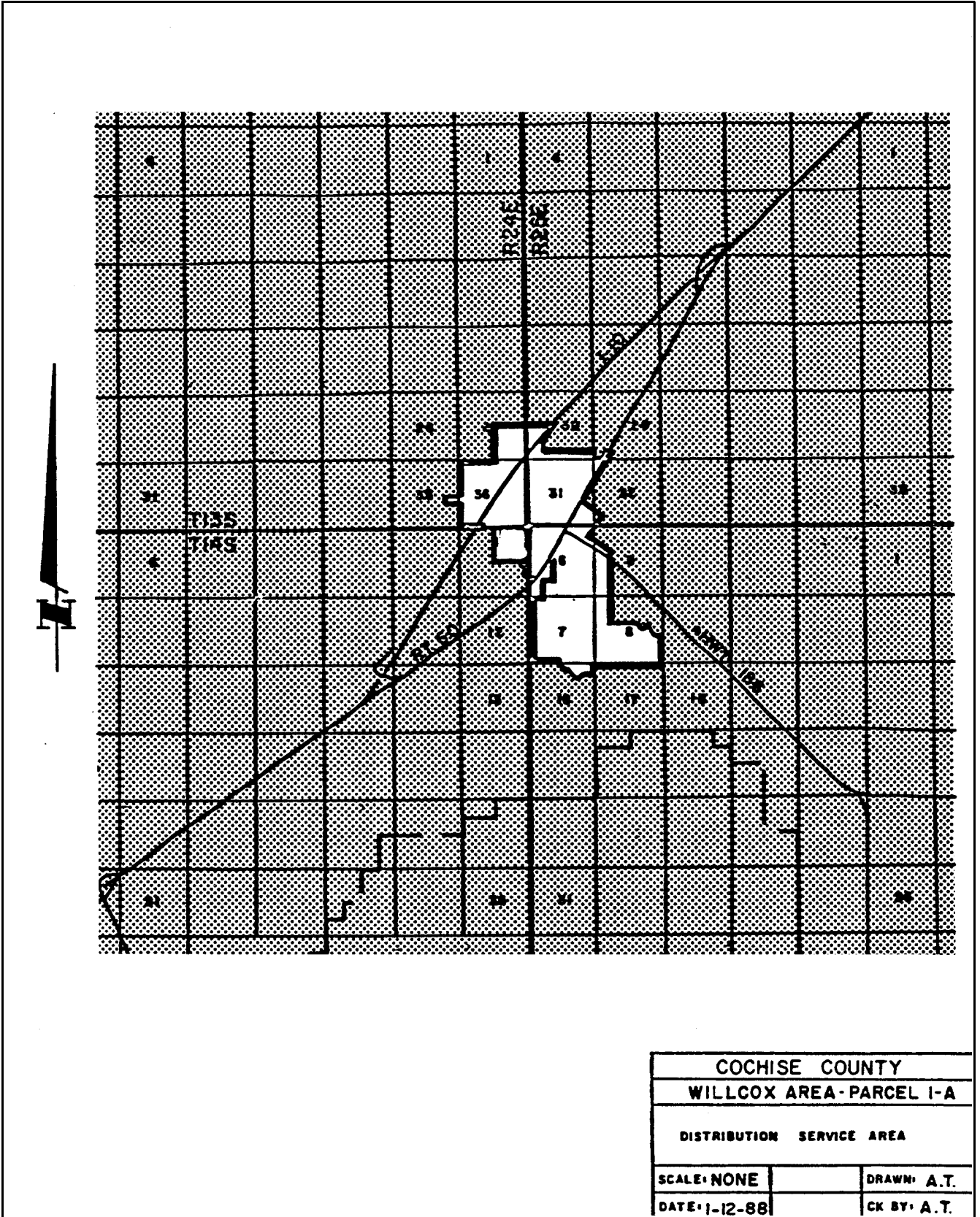

COCHISE COUNTY	
WILLCOX AREA - PARCEL 1-A	
DISTRIBUTION SERVICE AREA	
SCALE: NONE	DRAWN: A.T.
DATE: 1-12-88	CK BY: A.T.

Issued On August 29, 1997
Docket No. U-1551-96-596

Issued by
Edward S. Zub
Senior Vice President

Effective September 1, 1997
Decision No. 60352

SOUTHWEST GAS CORPORATION
P.O. Box 98510
Las Vegas, Nevada 89193-8510
Arizona Gas Tariff No. 7
Arizona Division

Canceling _____ First Revised _____ A.C.C. Sheet No. 126
Original _____ A.C.C. Sheet No. 126

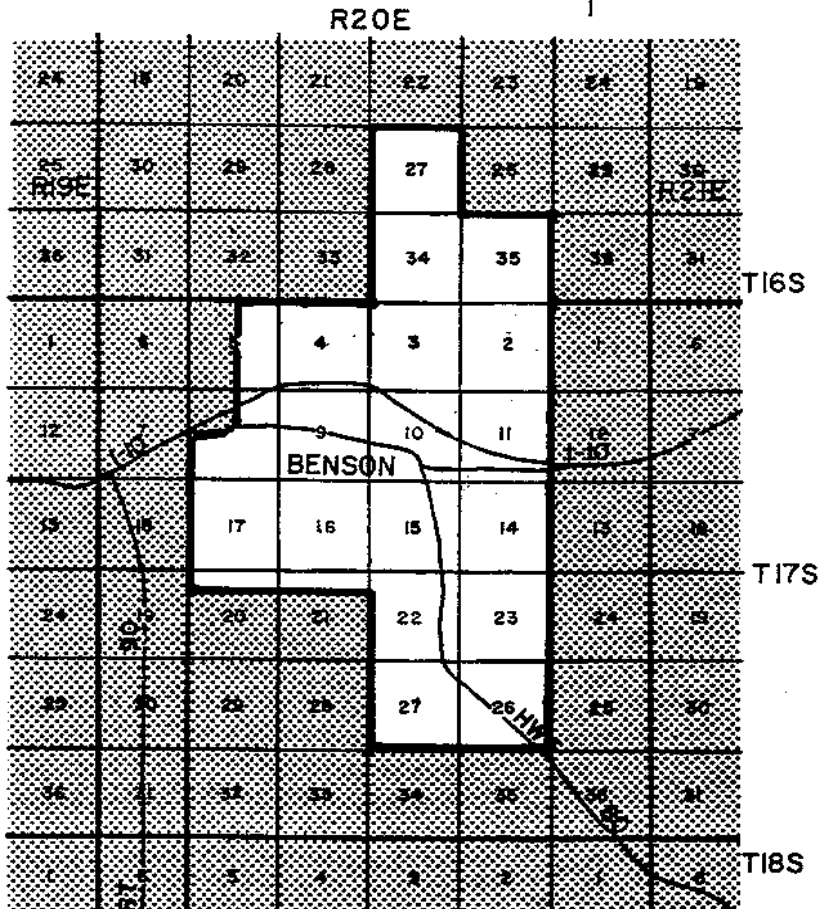

COCHISE COUNTY		
BENSON AREA-PARCEL I-B		
DISTRIBUTION SERVICE AREA		
SCALE: N.T.S.		DRAWN: C.W.C.
DATE: 2-4-98		CK BY: A.T.

Issued On March 2, 1998 Issued by Edward S. Zub Effective March 4, 1998
Docket No. G-01551A-97-0226 Senior Vice President Decision No. 60591

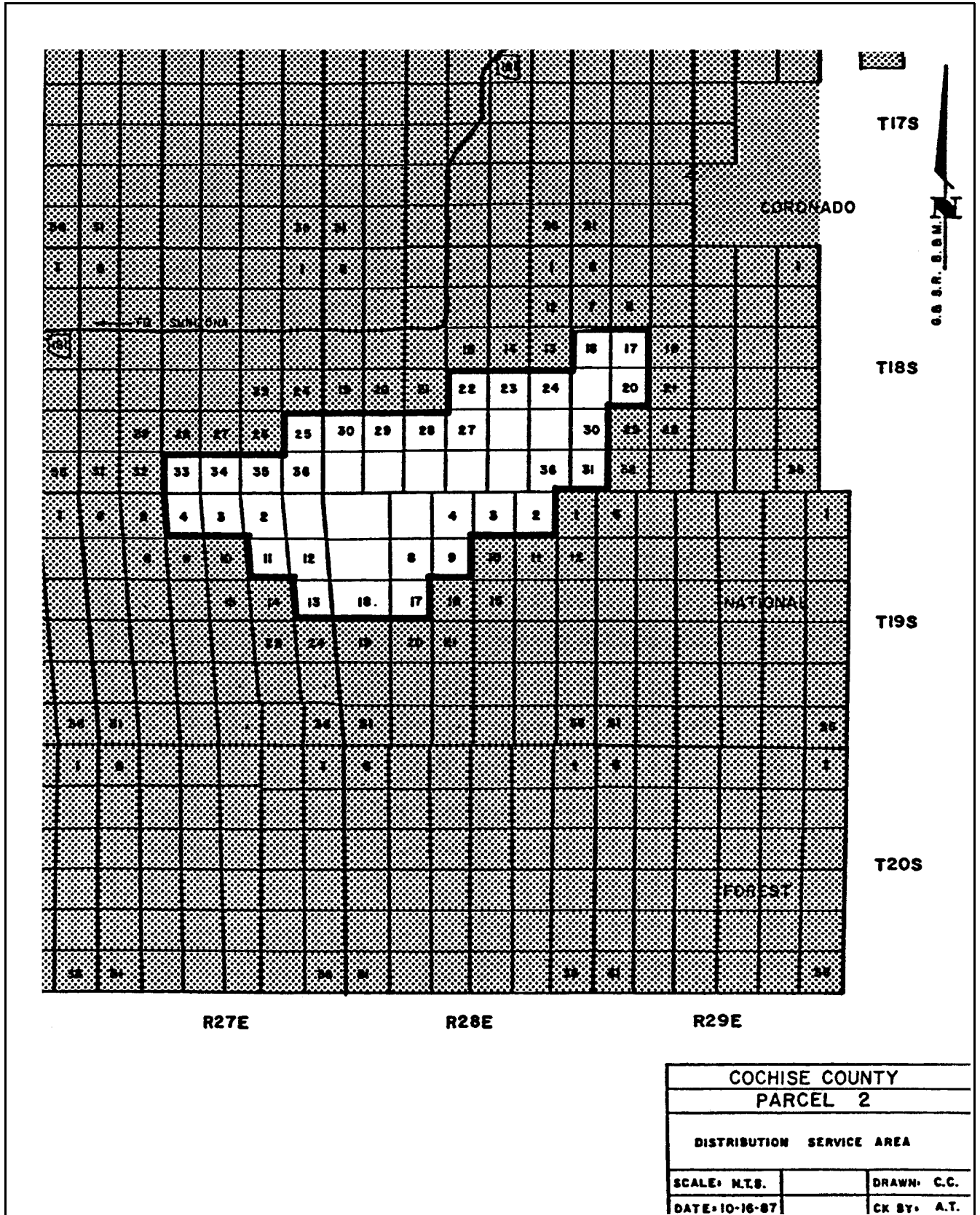

Issued On August 29, 1997
 Docket No. U-1551-96-596

Issued by
 Edward S. Zub
 Senior Vice President

Effective September 1, 1997
 Decision No. 60352

RULE NO. 2

CERTIFICATED GAS SERVICE AREA

The service area of Southwest Gas Corporation within the County of Cochise, State of Arizona, Gila and Salt River Baseline and Meridian, includes the following described area:

1. Township 12 South, Range 22 East, All of Sections 1, 2, 11, 12, 13, 14, 23, 24, 25, 26, 27, 34, 35 and 36.
2. Township 12 South, Ranges 23, 24, 25, 26, 27, 28, 29, 30, 31 and 32 East.
3. Township 13 South, Range 20 East, All of Sections 25, 26, 32, 33, 34, 35 and 36.
4. Township 13 South, Range 21 East, All of Sections 25, 26, 27, 28, 29, 30, 31, 32, 33, 34, 35 and 36.
5. Township 13 South, Range 22 East, All of Sections 1, 2, 3, 9, 10, 11, 12, 13, 14, 15, 16, 17, 19, 20, 21, 22, 23, 24, 25, 26, 27, 28, 29, 30, 31, 32, 33, 34, 35 and 36.
6. Township 13 South, Ranges 23, 24, 25, 26, 27, 28, 29, 30, 31 and 32 East.
7. Township 14 South, Ranges 19, 20, 21, 22, 23, 24, 25, 26, 27, 28, 29, 30, 31 and 32 East.
8. Township 15 South, Ranges 19, 20, 21, 22, 23, 24, 25, 26, 27, 28, 29, 30, 31 and 32 East.
9. Township 16 South, Ranges 19, 20, 21, 22, 23, 24, 25, 26, 27, 28, 29, 30, 31 and 32 East.
10. Township 17 South, Ranges 19, 20, 21, 22, 23, 24, 25, 26, 27, 28, 29, 30, 31 and 32 East.
11. Township 18 South, Ranges 19, 20, 21, 22, 23, 24, 25, 26, 30, 31 and 32 East.
12. Township 18 South, Range 27 East, All of Sections 1, 2, 3, 4, 5, 6, 7, 8, 9, 10, 11, 12, 13, 14, 15, 16, 17, 18, 19, 20, 21, 22, 23, 24, 26, 27, 28, 29, 30, 31 and 32.

RULE NO. 2

CERTIFICATED GAS SERVICE AREA

(Continued)

- 13. Township 18 South, Range 28 East, All of Sections 1, 2, 3, 4, 5, 6, 7, 8, 9, 10, 11, 12, 13, 14, 15, 16, 17, 18, 19, 20 and 21.
- 14. Township 18 South, Range 29 East, All of Sections 1, 2, 3, 4, 5, 6, 7, 8, 9, 10, 11, 12, 13, 14, 15, 16, 21, 22, 23, 24, 25, 26, 27, 28, 29, 32, 33, 34, 35 and 36.
- 15. Township 19 South, Ranges 19, 20, 21, 22, 23, 24, 25, 26, 29, 30, 31 and 32 East.
- 16. Township 19 South, Range 27 East, All of Sections 5, 6, 7, 8, 9, 10, 14, 15, 16, 17, 18, 19, 20, 21, 22, 23, 24, 25, 26, 27, 28, 29, 30, 31, 32, 33, 34, 35 and 36.
- 17. Township 19 South, Range 28 East, All of Sections 1, 10, 11, 12, 13, 14, 15, 16, 19, 20, 21, 22, 23, 24, 25, 26, 27, 28, 29, 30, 31, 32, 33, 34, 35 and 36.
- 18. Township 20 South, Ranges 19, 20, 21, 22, 23, 24, 25, 26, 27, 28, 29, 30, 31 and 32 East.
- 19. Township 21 South, Ranges 19, 20, 21, 22, 23, 24, 25, 26, 27, 28, 29, 30, 31 and 32 East.
- 20. Township 22 South, Ranges 19, 20, 21, 22, 23, 24, 25, 26, 27, 28, 29, 30, 31 and 32 East.
- 21. Township 23 South, Ranges 19, 20, 21, 22, 23, 24, 25, 26, 27, 28, 29, 30, 31 and 32 East.
- 22. Township 24 South, Ranges 19, 20, 21, 22, 23, 24, 25, 26, 27, 28, 29, 30, 31 and 32 East.
- 23. Areas adjacent to the EL Paso Natural Gas Company gas transmission main in Township 12 South, Range 19 East; Township 12 South, Range 20 East; Township 12 South, Range 21 East; Township 13 South, Range 21 East; and Township 13 South, Range 22 East.

RULE NO. 2

CERTIFICATED GAS SERVICE AREA

(Continued)

EXCEPTING

The city limits of Willcox, Arizona, more particularly described as follows:

- 1. Township 13 South, Range 24 East.

Section 25, SE 1/4

Section 35, N 1/2 NE 1/4 SE 1/4

Section 36, All

- 2. Township 13 South, Range 25 East.

Section 29, S 1/2 SW 1/4 SW 1/4

Section 30, W 1/2 SW 1/4, W 1/2 NE 1/4 SW 1/4, S 1/2 SE 1/4, SW 1/4, S 1/2 S 1/2 SE 1/4

Section 31, W 1/2, NE 1/4, W 1/2 SE 1/4, W 1/2 NE 1/4 SE 1/4, SE 1/4, SE 1/4

Section 32, NW 1/4 NW 1/4, W 1/2 SW 1/4 NW 1/4, W 1/2 SW 1/4 SW 1/4

- 3. Township 14 South, Range 24 East.

Section 1, NE 1/4.

- 4. Township 14 South, Range 25 East.

Section 5, SW 1/4 NW 1/4, W 1/2 SW 1/4

Section 6, E 1/2, NW 1/4, NW 1/4 SW 1/4, E 1/2 NE 1/4 SW 1/4, SE 1/4 SW 1/4

Section 7, All

Section 8, W 1/2 NW 1/4, S 1/2 SE 1/4 NW 1/2, S 1/2 SW 1/4 NE 1/4, SW 1/4, W 1/2 SE 1/4, W 1/2 E 1/2 SE 1/4

Section 18, N 1/2 NE 1/4

RULE NO. 2

CERTIFICATED GAS SERVICE AREA

(Continued)

ALSO EXCEPTING

The city limits of Benson, Arizona, more particularly described as follows:

1. Township 16 South, Range 20 East.

Sections 27, 34 and 35, All

2. Township 17 South, Range 20 East.

Sections 2, 3 and 4, All

Section 5, E 1/2

Section 8, E 1/2 and all that portion south of the south right-of-way of Highway 80 in the NW 1/4 and SW 1/4

Sections 9, 10, 11, 14, 15, 16 and 17, All

Section 20, N 1/2 N 1/2

Section 21, N 1/2 N 1/2

Sections 22, 23, 26 and 27, All