

SOUTHWEST GAS CORPORATION  
P.O. Box 98510  
Las Vegas, Nevada 89193-8510  
Arizona Gas Tariff No. 7  
Arizona Division

First Revised \_\_\_\_\_ A.C.C. Sheet No. 165  
Original \_\_\_\_\_ A.C.C. Sheet No. 165  
Canceling \_\_\_\_\_

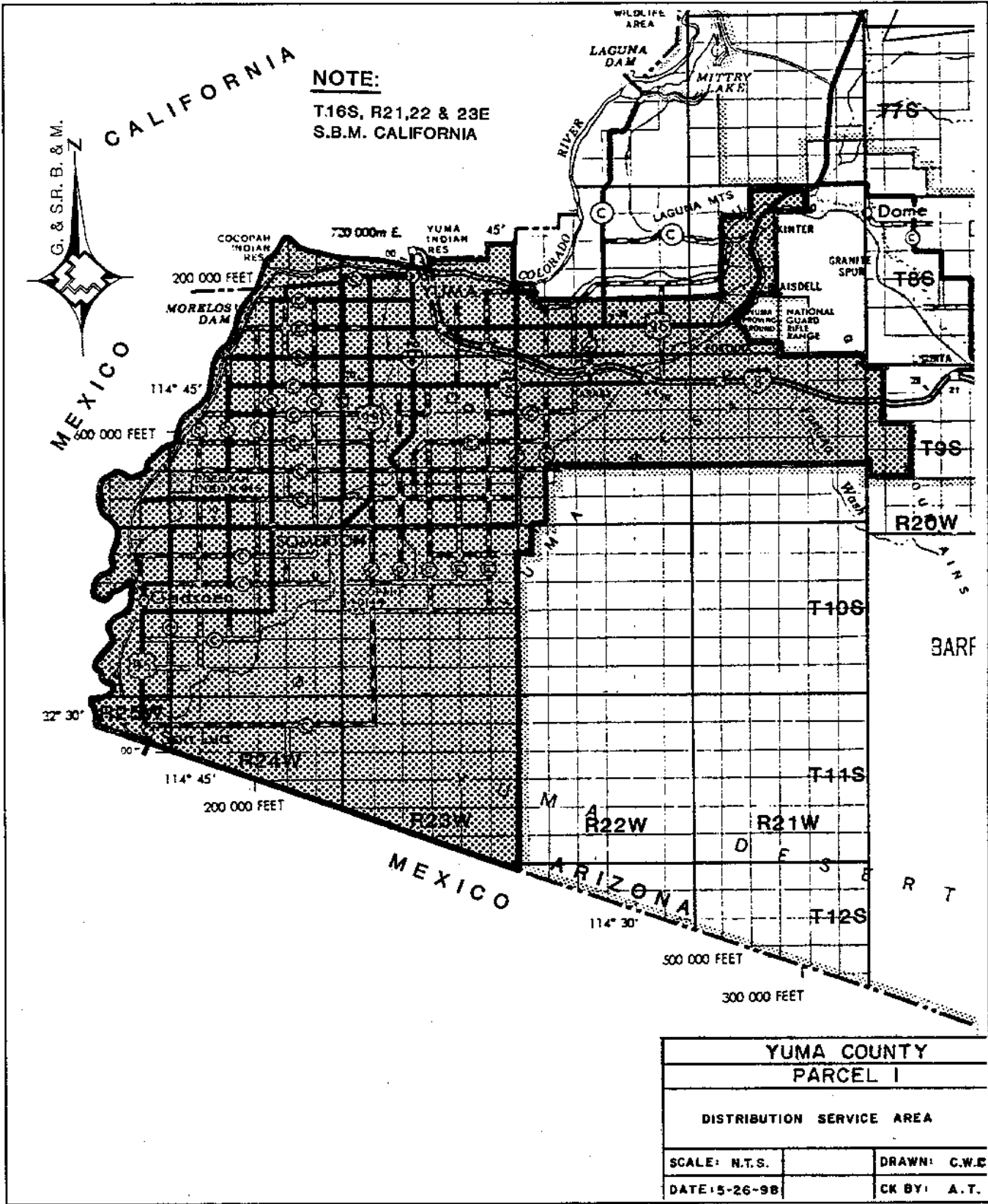

Issued On May 29, 1998      Issued by Edward S. Zub      Effective June 3, 1998  
Docket No. U-1551-87-098      Senior Vice President      Decision No. 56074

SOUTHWEST GAS CORPORATION  
 P.O. Box 98510  
 Las Vegas, Nevada 89193-8510  
 Arizona Gas Tariff No. 7  
 Arizona Division

Canceling \_\_\_\_\_ First Revised \_\_\_\_\_ A.C.C. Sheet No. 166  
 Original \_\_\_\_\_ A.C.C. Sheet No. 166

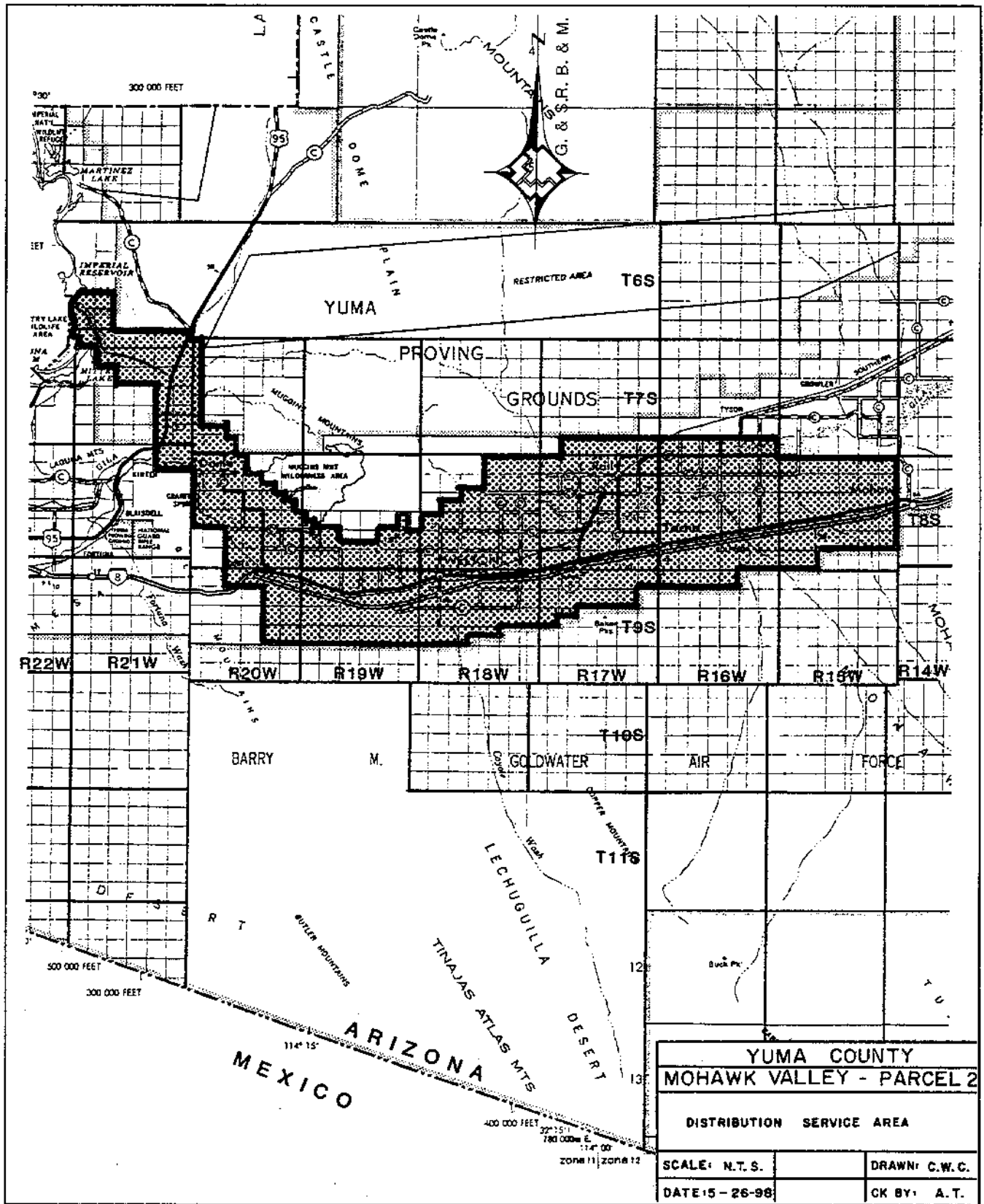

Issued On May 29, 1998 Issued by Edward S. Zub Effective June 3, 1998  
 Docket No. U-1551-87-098 Senior Vice President Decision No. 56074

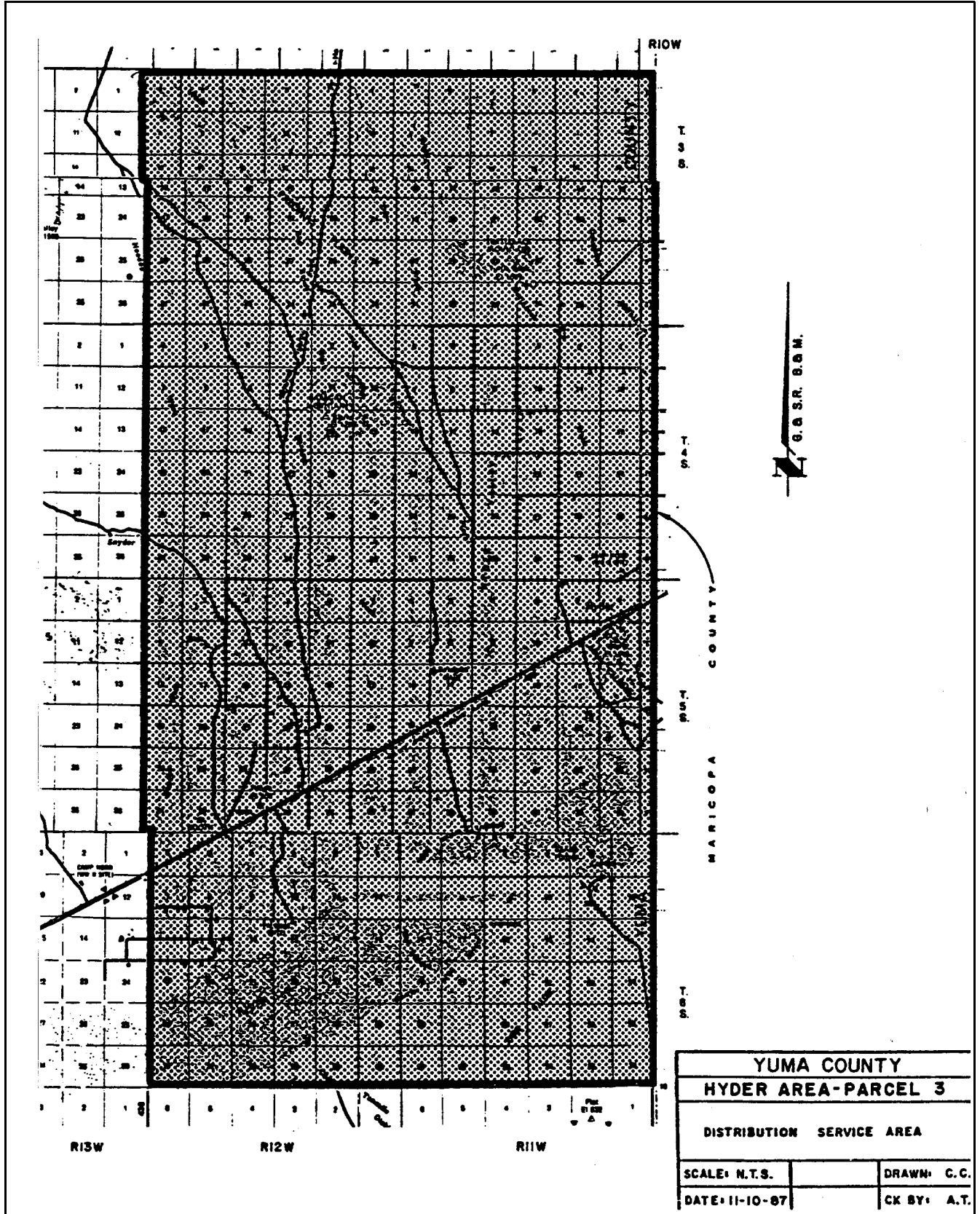

Issued On August 29, 1997  
Docket No. U-1551-96-596

Issued by  
Edward S. Zub  
Senior Vice President

Effective September 1, 1997  
Decision No. 60352

RULE NO. 2

CERTIFICATED GAS SERVICE AREA

The service area of Southwest Gas Corporation in or near Yuma, County of Yuma, State of Arizona, Gila and Salt River Baseline and Meridian and County of San Bernardino, State of California, San Bernardino Baseline and Meridian, includes the following described area:

PARCEL 1

1. Township 8 South, Range 21 West, All of Sections 3, 4, 8, 9, 16, 17, 20, 21, 30 and 31, All that portion of Sections 29 and 32 west and Section 33 south of the Yuma Proving Grounds.
2. Township 8 South, Range 22 West, All of Sections 25, 26, 27, 28, 29, 30, 31, 32, 33, 34, 35 and 36, All of the southwest quarter (SW 1/4) of Section 19.
3. Township 8 South, Range 23 West, All of Sections 25,26,27,28,29,30,31,32,33,34,35 and 36, All that portion of Sections 19, 20, 21, 22, 23 and 24 south of the Arizona/California Boundary Line.
4. Township 8 South, Range 24 West, All of Sections 25, 26, 27, 34, 35 and 36, All that portion of Sections 22, 23, 24, 28, 32 and 33 east and south of the Arizona/California Boundary Line.
5. Township 9 South, Range 21 West, All of Sections 2, 3, 4, 5, 6, 7, 8, 9, 10, 11, 13, 14, 15, 16, 17, 18, 19, 20, 21, 22, 23 and 24.
6. Township 9 South, Range 22 West, All of Sections 1, 2, 3, 4, 5, 6, 7, 8, 9, 10, 11, 12, 13, 14, 15, 16, 17, 18, 19, 20, 21, 22, 23, 24, 30 and 31.
7. Township 9 South, Range 23 West.
8. Township 9 South, Range 24 West, All of Sections 1, 2, 3, 4, 9, 10, 11, 12, 13, 14, 15, 16, 17, 20, 21, 22, 23, 24, 25, 26, 27, 28, 29, 30, 31, 32, 33, 34, 35 and 36, All that portion of Sections 5, 7, 8, 18 and 19 east of the Arizona/California Boundary Line.
9. Township 9 South, Range 25 West, All of Section 36, All that portion of Sections 24, 25, 26, 27, 34 and 35 east of the Arizona/California Boundary Line.

RULE NO. 2

CERTIFICATED GAS SERVICE AREA

*(Continued)*

10. Township 10 South, Range 22 West, the west half (W 1/2) of Section 6.
11. Township 10 South, Range 23 West.
12. Township 10 South, Range 24 West.
13. Township 10 South, Range 25 West, All of Sections 1, 12, 13, 24, 25 and 36, All that portion of Sections 2, 10, 11, 14, 23, 26, 27, 34 and 35 east of the Arizona/California Boundary Line/centerline of the Colorado River.
14. Township 11 South, Range 23 West, All of Sections 1, 2, 3, 4, 5, 6, 7, 8, 9, 10, 11, 12, 13, 14, 15, 16, 17, 18, 19, 20, 21, 22, 23, 24, 25, 26, 27, All that portion of Sections 28, 29, 30, 33, 34, 35 and 36 north of the U.S./Mexico Boundary Line.
15. Township 11 South, Range 24 West, All of Sections 1, 2, 3, 4, 5, 6, 8, 9, 10, 11, 12, 13, 14, All that portion of Sections 7, 15, 16, 17, 18, 22, 23 and 24 north of the U.S./Mexico Boundary Line.
16. Township 11 South, Range 25 West, All of Sections 1 and 2, All that portion of Section 3 and 10 east of the Arizona/California Boundary Line, All that portion of Sections 10, 11 and 12 north of the U.S./Mexico Boundary Line.
17. Township 12 South, Range 23 West, All that portion of Section 1 north of the U.S./Mexico Boundary Line.
18. Township 16 South, Range 21 East, S.B.B.M., All that portion of Sections 24, 25, 35 and 36 south of the Arizona/California Boundary Line.
19. Township 16 South, Range 22 East, S.B.B.M., All that portion of Sections 19, 25, 26, 27, 28, 29, 30, 31, 32, 33, 34, 35 and 36 south of the Arizona/California Boundary Line.
20. Township 16 South, Range 23 East, S.B.B.M., All that portion of Sections 29, 30 and 31 north of the Arizona/California Boundary Line.

RULE NO. 2

CERTIFICATED GAS SERVICE AREA

*(Continued)*

PARCEL 2

1. Township 6 South, Range 21 West, All of Sections 25 and 36, All that portion of Sections 26 and 35 east of the meander shore line of Mittry Lake.
2. Township 7 South, Range 16 West, All of Sections 31, 32, 33, 34, 35 and 36.
3. Township 7 South, Range 17 West, All of Sections 32, 33, 34, 35 and 36.
4. Township 7 South, Range 20 West, All of Sections 6, 7, 18, 19, 30, 31 and 32, the south half (S 1/2) of Section 29, and the west half (W 1/2) of Section 33.
5. Township 7 South, Range 21 West, All of Sections 1, 2, 3, 4, 5, 8, 9, 10, 11, 12, 13, 14, 15, 16, 23, 24, 25, 26, 35 and 36, All that portion of Section 6 east of the meander shore line of Mittry Lake.
6. Township 8 South, Range 15 West, All of Sections 1, 2, 3, 4, 5, 6, 7, 8, 9, 10, 11, 12, 13, 14, 15, 16, 17, 18, 19, 20, 21, 22, 23, 24, 25, 26, 27, 28, 29, 30, 31 and 32.
7. Township 8 South, Range 16 West.
8. Township 8 South, Range 17 West.
9. Township 8 South, Range 18 West, All of Sections 1, 2, 3, 10, 11, 12, 13, 14, 15, 16, 19, 20, 21, 22, 23, 24, 25, 26, 27, 28, 29, 30, 31, 32, 33, 34, 35 and 36, and the south half (S 1/2) of Section 17.
10. Township 8 South, Range 19 West, All of Sections 25, 26, 29, 30, 31, 32, 33, 34, 35 and 36, the southwest quarter (SW 1/4) of Section 19, the west half (W 1/2) of Section 24, and the south half (S 1/2) of Sections 27 and 28.
11. Township 8 South, Range 20 West, All of Sections 4, 5, 6, 7, 8, 9, 10, 14, 15, 16, 17, 18, 19, 20, 21, 22, 23, 24, 25, 26, 27, 28, 33, 34, 35 and 36, the south half (S 1/2) of Section 3, and the southwest quarter (SW 1/4) of Sections 11 and 13.

RULE NO. 2

CERTIFICATED GAS SERVICE AREA

*(Continued)*

12. Township 8 South, Range 21 West, All of Sections 1 and 2.
13. Township 9 South, Range 16 West, All of Sections 3, 4, 5 and 6.
14. Township 9 South, Range 17 West, All of Sections 1, 2, 3, 4, 5, 6, 7, 8, 9, 10, 11 and 18, and the north half (N 1/2) of Section 17.
15. Township 9 South, Range 18 West, All of Sections 1, 2, 3, 4, 5, 6, 7, 8, 9, 10, 11, 12, 13, 14, 15, 16, 17, 18, 19 and 20, the north half (N 1/2) and the southwest quarter (SW 1/4) of Section 21, and the north half (N 1/2) of Section 22.
16. Township 9 South, Range 19 West, All of Sections 1, 2, 3, 4, 5, 6, 7, 8, 9, 10, 11, 12, 13, 14, 15, 16, 17, 18, 19, 20, 21, 22, 23 and 24.
17. Township 9 South, Range 20 West, All of Sections 1, 2, 3, 4, 11, 12, 13, 14, 23 and 24.

PARCEL 3

1. Township 3 South, Range 10 West, All that portion lying within Yuma County.
2. Township 3 South, Ranges 11 and 12 West.
3. Township 4 South, Range 10 West, All that portion lying within Yuma County.
4. Township 4 South, Ranges 11 and 12 West.
5. Township 5 South, Range 10 West, All that portion lying within Yuma County.
6. Township 5 South, Ranges 11 and 12 West.
7. Township 6 South, Range 10 West, All that portion lying within Yuma County.
8. Township 6 South, Ranges 11 and 12 West.



SOUTHWEST GAS CORPORATION  
P.O. Box 98510  
Las Vegas, Nevada 89193-8510  
Arizona Gas Tariff No. 7

Original \_\_\_\_\_ A.C.C. Sheet No. 172-181  
Canceling \_\_\_\_\_ A.C.C. Sheet No. \_\_\_\_\_

RULE NO. 2

CERTIFICATED GAS SERVICE AREA  
(Continued)

HELD FOR FUTURE USE

Issued On August 29, 1997  
Docket No. U-1551-96-596

Issued by  
Edward S. Zub  
Senior Vice President

Effective September 1, 1997  
Decision No. 60352