

## RULE NO. 2

CERTIFICATED GAS SERVICE AREA

<u>County</u>	<u>A.C.C. Sheet No.</u>
<u>Cochise</u>	
County Map	123
Parcel 1 Map (Northwest Quadrant)	124
Parcel 1-A Map (Willcox Area)	125
Parcel 1-B Map (Benson Area)	126
Parcel 2 Map (East Central)	127
Legal Description	128 – 131
<u>Gila</u>	
County Map	132
Parcel 1 Map (Miami-Globe Area)	133
Parcel 2 Map (Hayden-Winkelman Area)	134
Legal Description	135 – 136
<u>Graham</u>	
County Map	137
Fort Grant Area Map	138
Legal Description	139
<u>Greenlee</u>	
County Map	140
Legal Description	141
<u>La Paz</u>	
County Map	142
Legal Description	143 – 145

Issued On August 29, 1997  
 Docket No. U-1551-96-596

Issued by  
 Edward S. Zub  
 Senior Vice President

Effective September 1, 1997  
 Decision No. 60352

## RULE NO. 2

CERTIFICATED GAS SERVICE AREA*(Continued)*

<u>County</u>	<u>A.C.C. Sheet No.</u>
<u>Maricopa</u>	
County Map	146
Metrophoenix Area	147
Legal Description	148 – 151
<u>Mohave</u>	
County Map	152
Legal Description	153
<u>Pima</u>	
County Map	154
Parcel 1 Map (Tucson Area)	155
Parcel 2 Map (Ajo Area)	156
Legal Description	157 – 159
<u>Pinal</u>	
County Map	160
Legal Description	161 – 163
<u>Yuma</u>	
County Map	164
Parcel 1 Map (Yuma-Somerton Area)	165
Parcel 2 Map (Mohawk Valley)	166
Parcel 3 Map (Hyder Area)	167
Legal Description	168 – 171

SOUTHWEST GAS CORPORATION  
 P.O. Box 98510  
 Las Vegas, Nevada 89193-8510  
 Arizona Gas Tariff No. 7  
 Arizona Division

Canceling First Revised A.C.C. Sheet No. 123  
Original A.C.C. Sheet No. 123

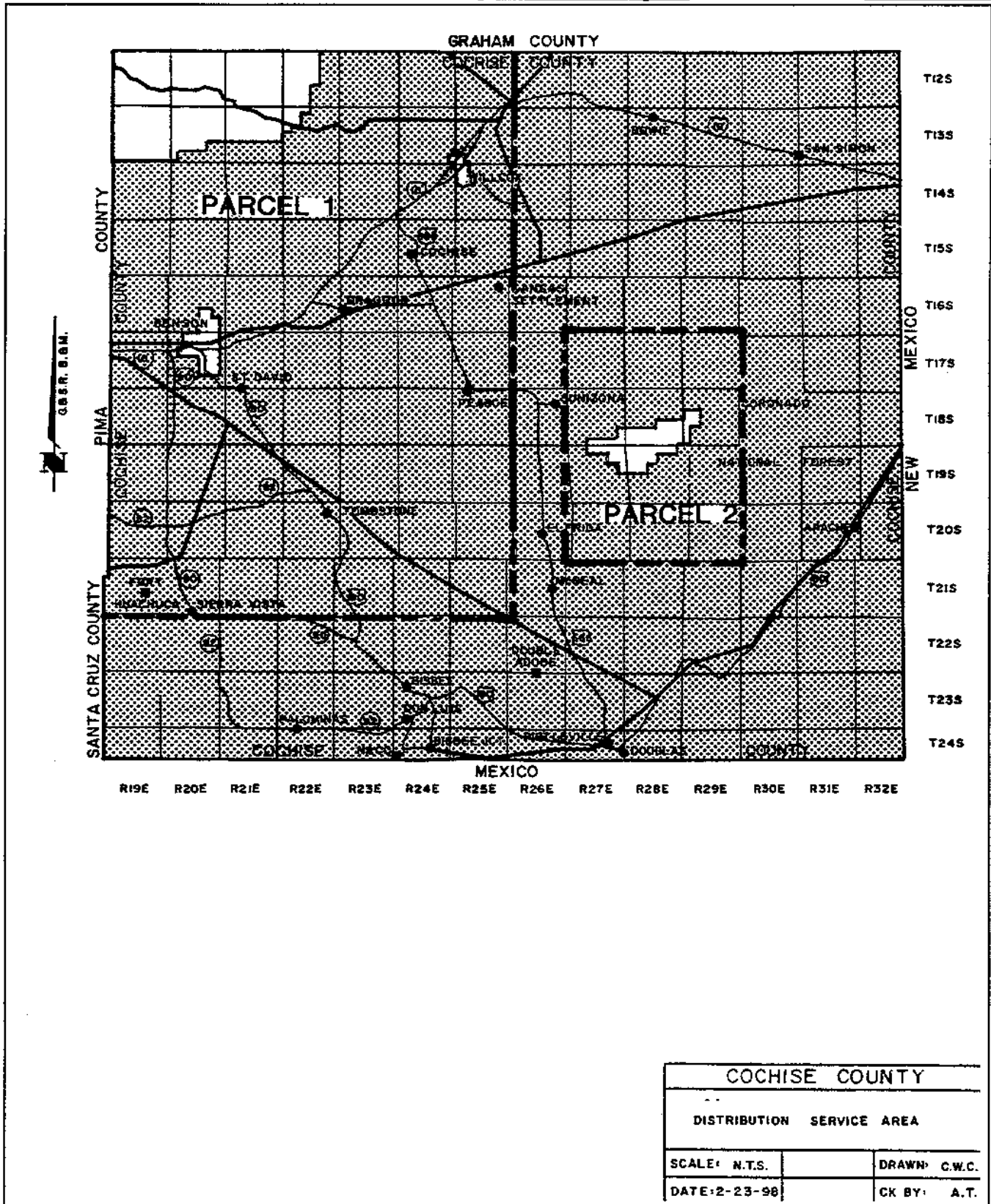

Issued On March 2, 1998  
 Docket No. G-01551A-97-0226

Issued by  
 Edward S. Zub  
 Senior Vice President

Effective March 4, 1998  
 Decision No. 60591

SOUTHWEST GAS CORPORATION  
P.O. Box 98510  
Las Vegas, Nevada 89193-8510  
Arizona Gas Tariff No. 7  
Arizona Division

First Revised \_\_\_\_\_ A.C.C. Sheet No. 124  
Original \_\_\_\_\_ A.C.C. Sheet No. 124  
Cancelling \_\_\_\_\_

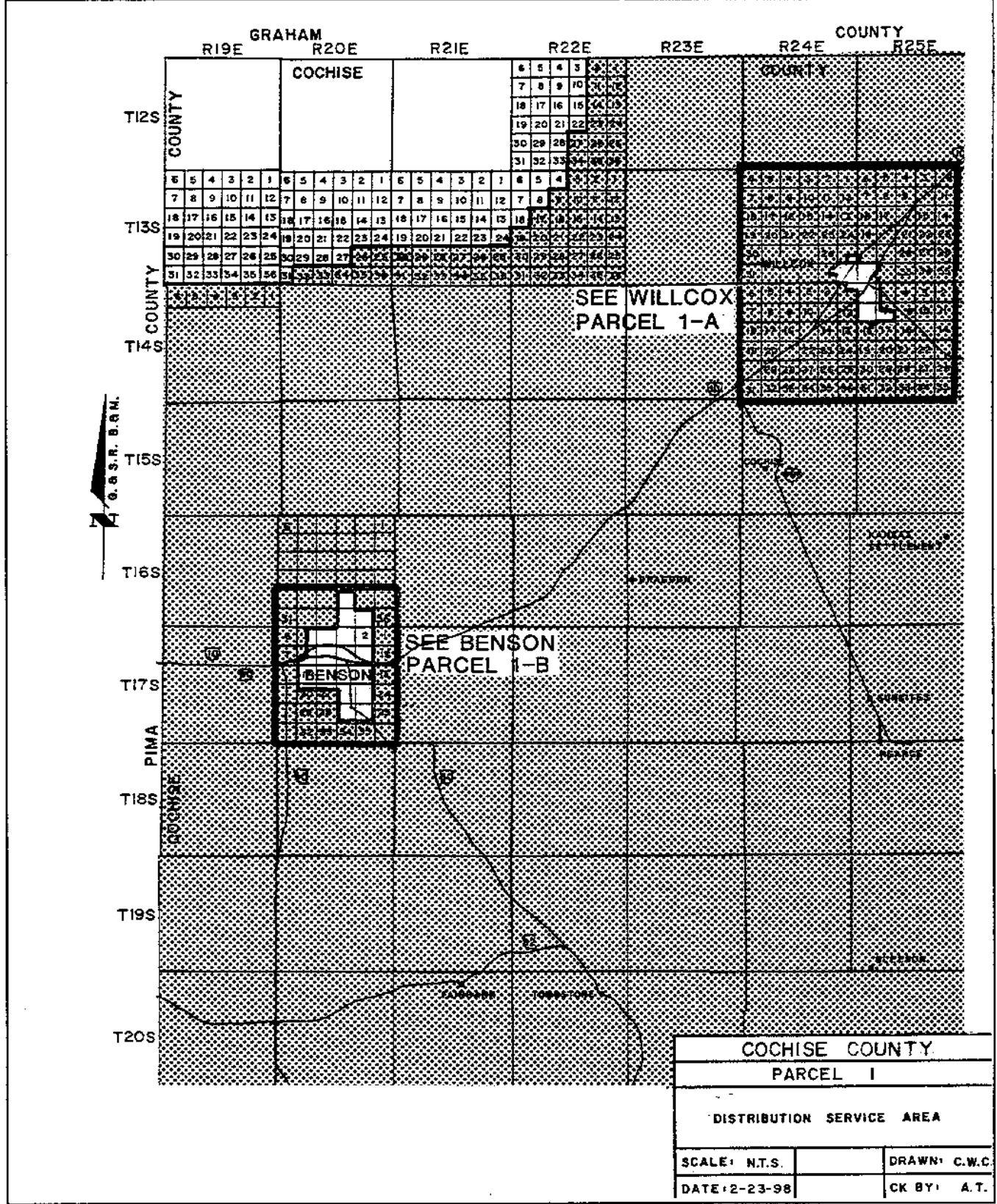

Issued On March 2, 1998 Issued by Edward S. Zub Effective March 4, 1998  
Docket No. G-01551A-97-0226 Senior Vice President Decision No. 60591

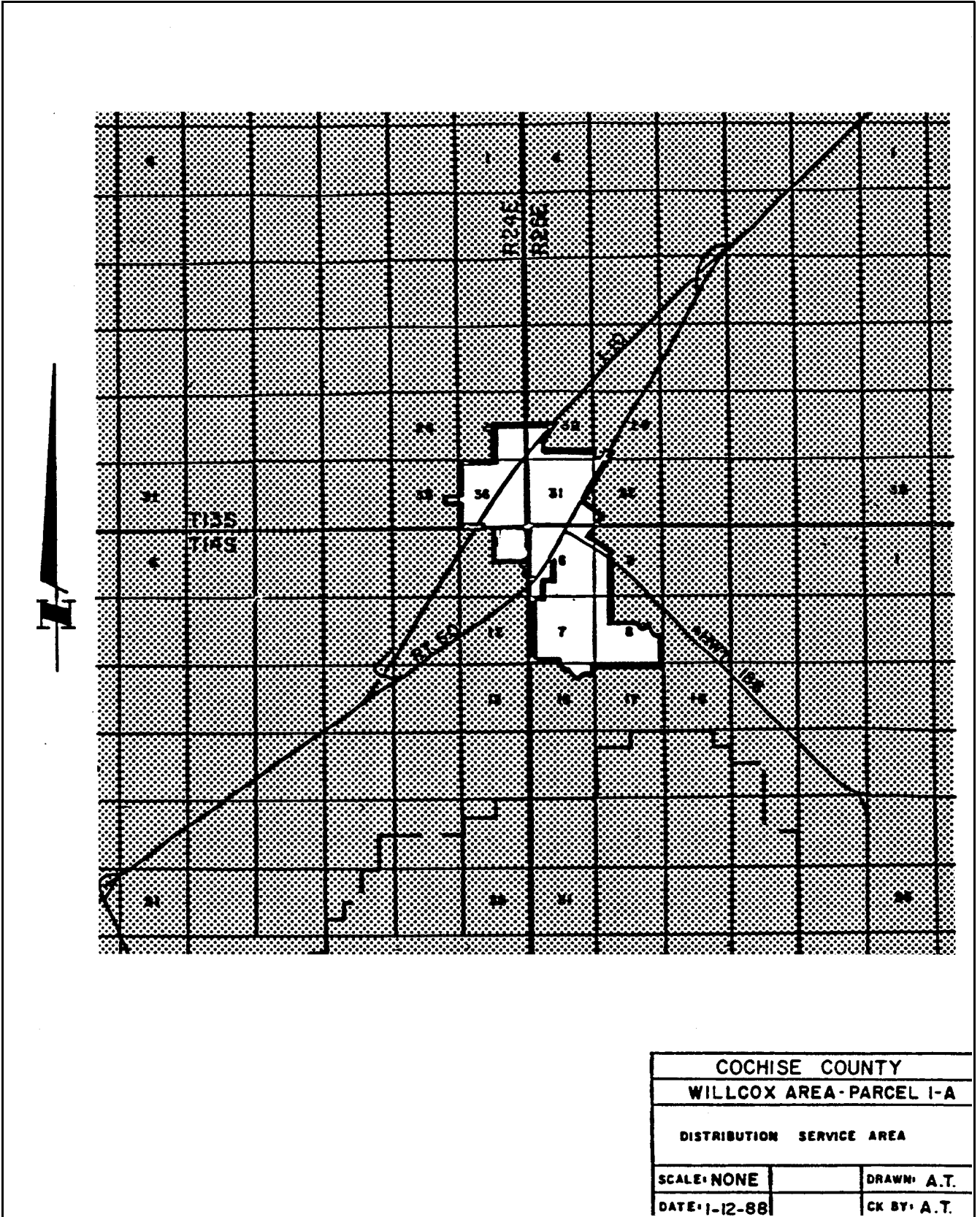

Issued On August 29, 1997  
Docket No. U-1551-96-596

Issued by  
Edward S. Zub  
Senior Vice President

Effective September 1, 1997  
Decision No. 60352

SOUTHWEST GAS CORPORATION  
 P.O. Box 98510  
 Las Vegas, Nevada 89193-8510  
 Arizona Gas Tariff No. 7  
 Arizona Division

Canceling                      First Revised                      A.C.C. Sheet No. 126  
                     Original                      A.C.C. Sheet No. 126

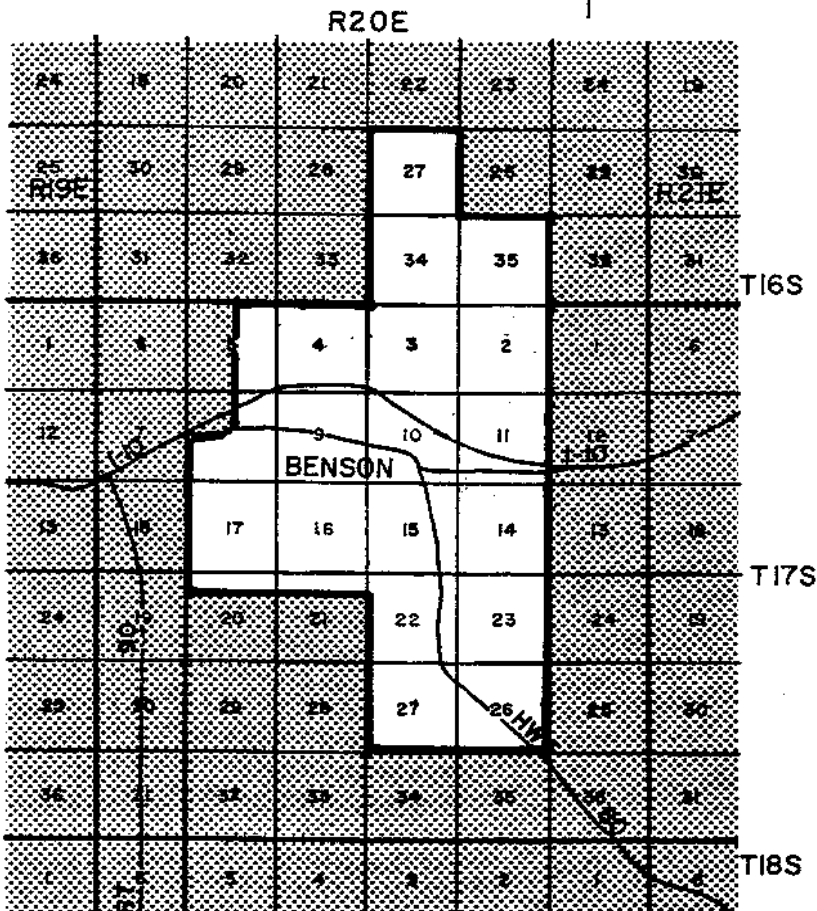

COCHISE COUNTY		
BENSON AREA-PARCEL I-B		
DISTRIBUTION SERVICE AREA		
SCALE: N.T.S.		DRAWN: C.W.C.
DATE: 2-4-98		CK BY: A.T.

Issued On March 2, 1998 Issued by Edward S. Zub Effective March 4, 1998  
 Docket No. G-01551A-97-0226 Senior Vice President Decision No. 60591

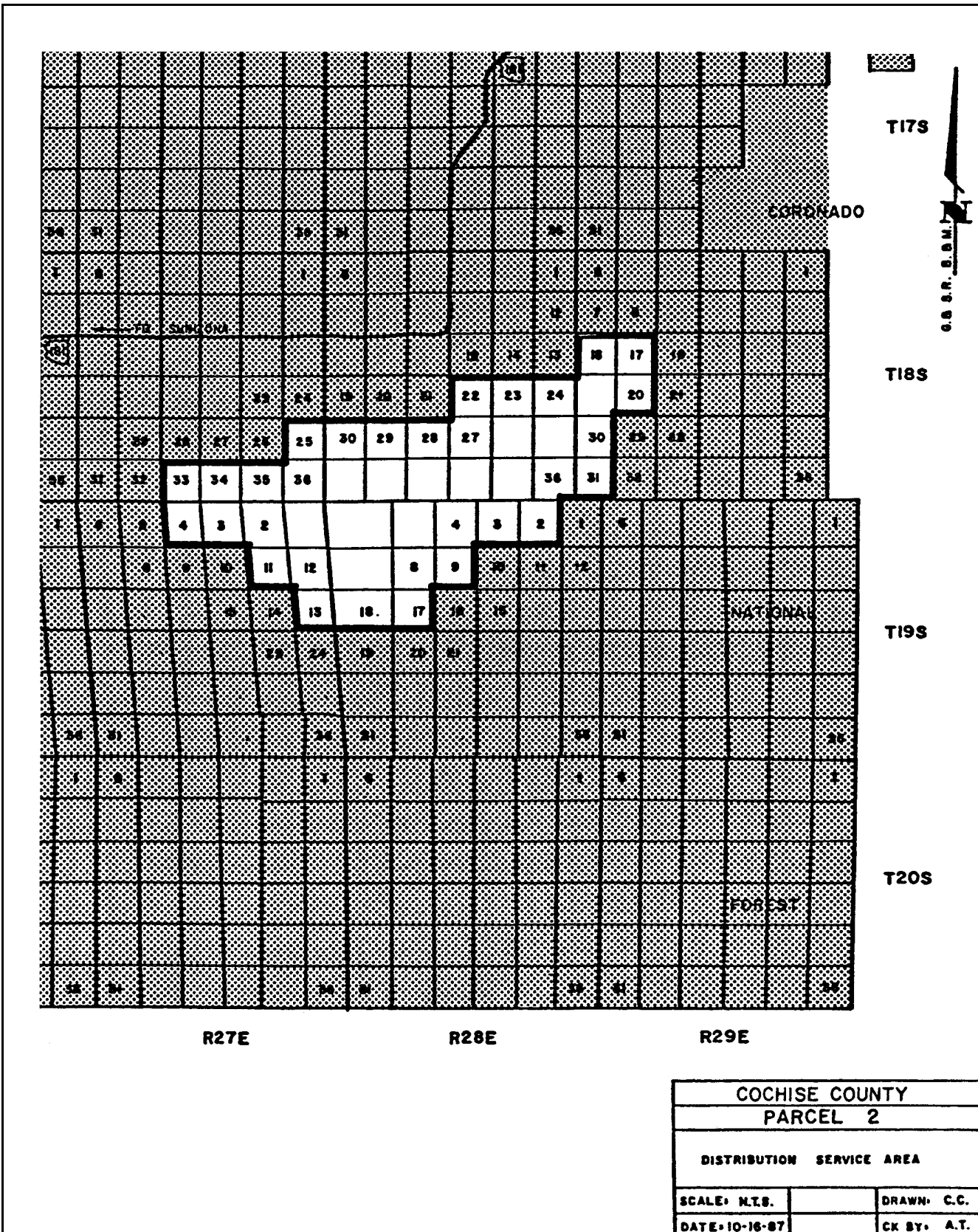

Issued On August 29, 1997  
 Docket No. U-1551-96-596

Issued by  
 Edward S. Zub  
 Senior Vice President

Effective September 1, 1997  
 Decision No. 60352

RULE NO. 2

CERTIFICATED GAS SERVICE AREA

The service area of Southwest Gas Corporation within the County of Cochise, State of Arizona, Gila and Salt River Baseline and Meridian, includes the following described area:

1. Township 12 South, Range 22 East, All of Sections 1, 2, 11, 12, 13, 14, 23, 24, 25, 26, 27, 34, 35 and 36.
2. Township 12 South, Ranges 23, 24, 25, 26, 27, 28, 29, 30, 31 and 32 East.
3. Township 13 South, Range 20 East, All of Sections 25, 26, 32, 33, 34, 35 and 36.
4. Township 13 South, Range 21 East, All of Sections 25, 26, 27, 28, 29, 30, 31, 32, 33, 34, 35 and 36.
5. Township 13 South, Range 22 East, All of Sections 1, 2, 3, 9, 10, 11, 12, 13, 14, 15, 16, 17, 19, 20, 21, 22, 23, 24, 25, 26, 27, 28, 29, 30, 31, 32, 33, 34, 35 and 36.
6. Township 13 South, Ranges 23, 24, 25, 26, 27, 28, 29, 30, 31 and 32 East.
7. Township 14 South, Ranges 19, 20, 21, 22, 23, 24, 25, 26, 27, 28, 29, 30, 31 and 32 East.
8. Township 15 South, Ranges 19, 20, 21, 22, 23, 24, 25, 26, 27, 28, 29, 30, 31 and 32 East.
9. Township 16 South, Ranges 19, 20, 21, 22, 23, 24, 25, 26, 27, 28, 29, 30, 31 and 32 East.
10. Township 17 South, Ranges 19, 20, 21, 22, 23, 24, 25, 26, 27, 28, 29, 30, 31 and 32 East.
11. Township 18 South, Ranges 19, 20, 21, 22, 23, 24, 25, 26, 30, 31 and 32 East.
12. Township 18 South, Range 27 East, All of Sections 1, 2, 3, 4, 5, 6, 7, 8, 9, 10, 11, 12, 13, 14, 15, 16, 17, 18, 19, 20, 21, 22, 23, 24, 26, 27, 28, 29, 30, 31 and 32.



RULE NO. 2

CERTIFICATED GAS SERVICE AREA

*(Continued)*

- 13. Township 18 South, Range 28 East, All of Sections 1, 2, 3, 4, 5, 6, 7, 8, 9, 10, 11, 12, 13, 14, 15, 16, 17, 18, 19, 20 and 21.
- 14. Township 18 South, Range 29 East, All of Sections 1, 2, 3, 4, 5, 6, 7, 8, 9, 10, 11, 12, 13, 14, 15, 16, 21, 22, 23, 24, 25, 26, 27, 28, 29, 32, 33, 34, 35 and 36.
- 15. Township 19 South, Ranges 19, 20, 21, 22, 23, 24, 25, 26, 29, 30, 31 and 32 East.
- 16. Township 19 South, Range 27 East, All of Sections 5, 6, 7, 8, 9, 10, 14, 15, 16, 17, 18, 19, 20, 21, 22, 23, 24, 25, 26, 27, 28, 29, 30, 31, 32, 33, 34, 35 and 36.
- 17. Township 19 South, Range 28 East, All of Sections 1, 10, 11, 12, 13, 14, 15, 16, 19, 20, 21, 22, 23, 24, 25, 26, 27, 28, 29, 30, 31, 32, 33, 34, 35 and 36.
- 18. Township 20 South, Ranges 19, 20, 21, 22, 23, 24, 25, 26, 27, 28, 29, 30, 31 and 32 East.
- 19. Township 21 South, Ranges 19, 20, 21, 22, 23, 24, 25, 26, 27, 28, 29, 30, 31 and 32 East.
- 20. Township 22 South, Ranges 19, 20, 21, 22, 23, 24, 25, 26, 27, 28, 29, 30, 31 and 32 East.
- 21. Township 23 South, Ranges 19, 20, 21, 22, 23, 24, 25, 26, 27, 28, 29, 30, 31 and 32 East.
- 22. Township 24 South, Ranges 19, 20, 21, 22, 23, 24, 25, 26, 27, 28, 29, 30, 31 and 32 East.
- 23. Areas adjacent to the EL Paso Natural Gas Company gas transmission main in Township 12 South, Range 19 East; Township 12 South, Range 20 East; Township 12 South, Range 21 East; Township 13 South, Range 21 East; and Township 13 South, Range 22 East.

RULE NO. 2

CERTIFICATED GAS SERVICE AREA

*(Continued)*

EXCEPTING

The city limits of Willcox, Arizona, more particularly described as follows:

- 1. Township 13 South, Range 24 East.

Section 25, SE 1/4

Section 35, N 1/2 NE 1/4 SE 1/4

Section 36, All

- 2. Township 13 South, Range 25 East.

Section 29, S 1/2 SW 1/4 SW 1/4

Section 30, W 1/2 SW 1/4, W 1/2 NE 1/4 SW 1/4, S 1/2 SE 1/4, SW 1/4, S 1/2 S 1/2 SE 1/4

Section 31, W 1/2, NE 1/4, W 1/2 SE 1/4, W 1/2 NE 1/4 SE 1/4, SE 1/4, SE 1/4

Section 32, NW 1/4 NW 1/4, W 1/2 SW 1/4 NW 1/4, W 1/2 SW 1/4 SW 1/4

- 3. Township 14 South, Range 24 East.

Section 1, NE 1/4.

- 4. Township 14 South, Range 25 East.

Section 5, SW 1/4 NW 1/4, W 1/2 SW 1/4

Section 6, E 1/2, NW 1/4, NW 1/4 SW 1/4, E 1/2 NE 1/4 SW 1/4, SE 1/4 SW 1/4

Section 7, All

Section 8, W 1/2 NW 1/4, S 1/2 SE 1/4 NW 1/2, S 1/2 SW 1/4 NE 1/4, SW 1/4, W 1/2 SE 1/4, W 1/2 E 1/2 SE 1/4

Section 18, N 1/2 NE 1/4

RULE NO. 2

CERTIFICATED GAS SERVICE AREA

*(Continued)*

ALSO EXCEPTING

The city limits of Benson, Arizona, more particularly described as follows:

1. Township 16 South, Range 20 East.

Sections 27, 34 and 35, All

2. Township 17 South, Range 20 East.

Sections 2, 3 and 4, All

Section 5, E 1/2

Section 8, E 1/2 and all that portion south of the south right-of-way of Highway 80 in the NW 1/4 and SW 1/4

Sections 9, 10, 11, 14, 15, 16 and 17, All

Section 20, N 1/2 N 1/2

Section 21, N 1/2 N 1/2

Sections 22, 23, 26 and 27, All

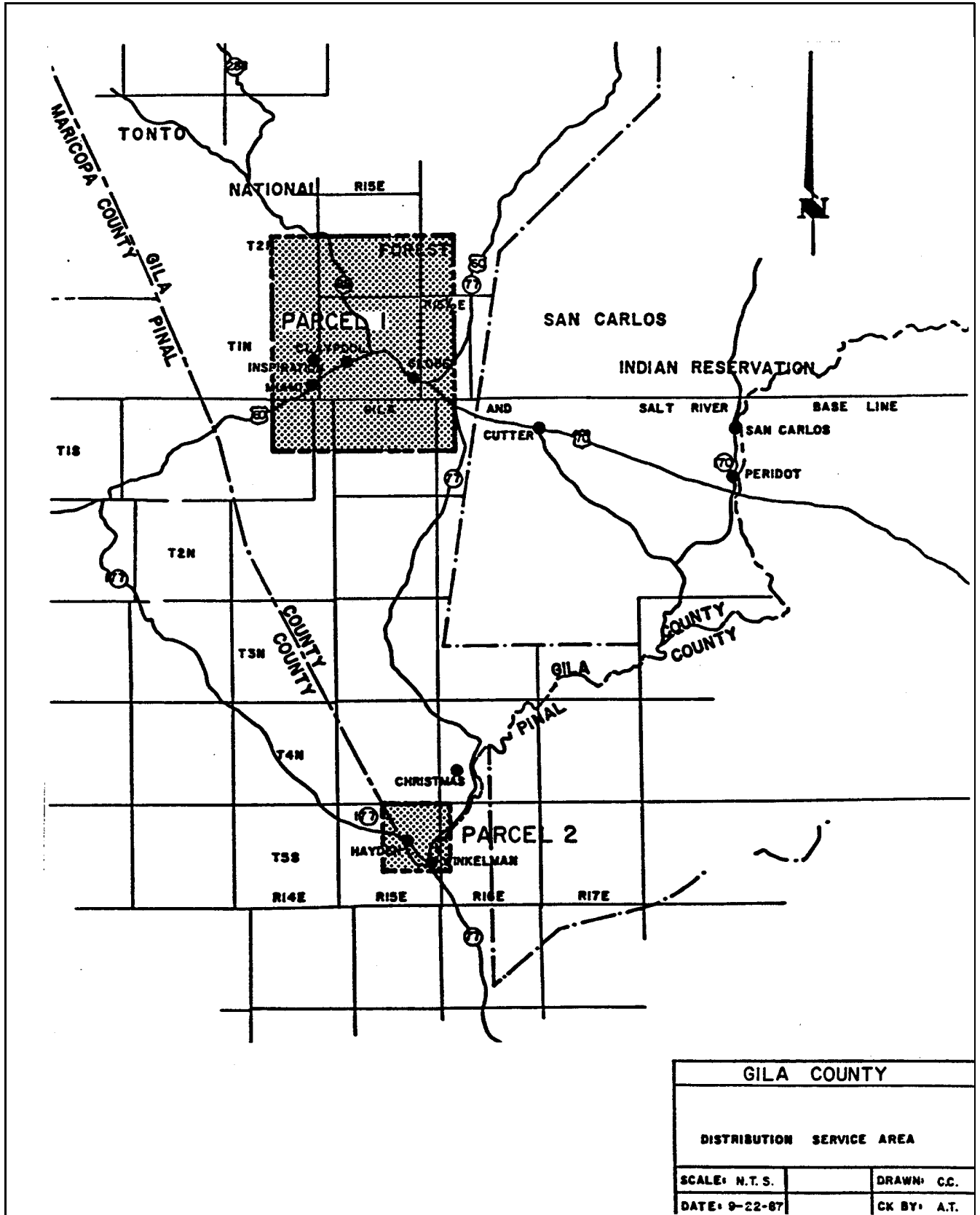

Issued On August 29, 1997  
Docket No. U-1551-96-596

Issued by  
Edward S. Zub  
Senior Vice President

Effective September 1, 1997  
Decision No. 60352

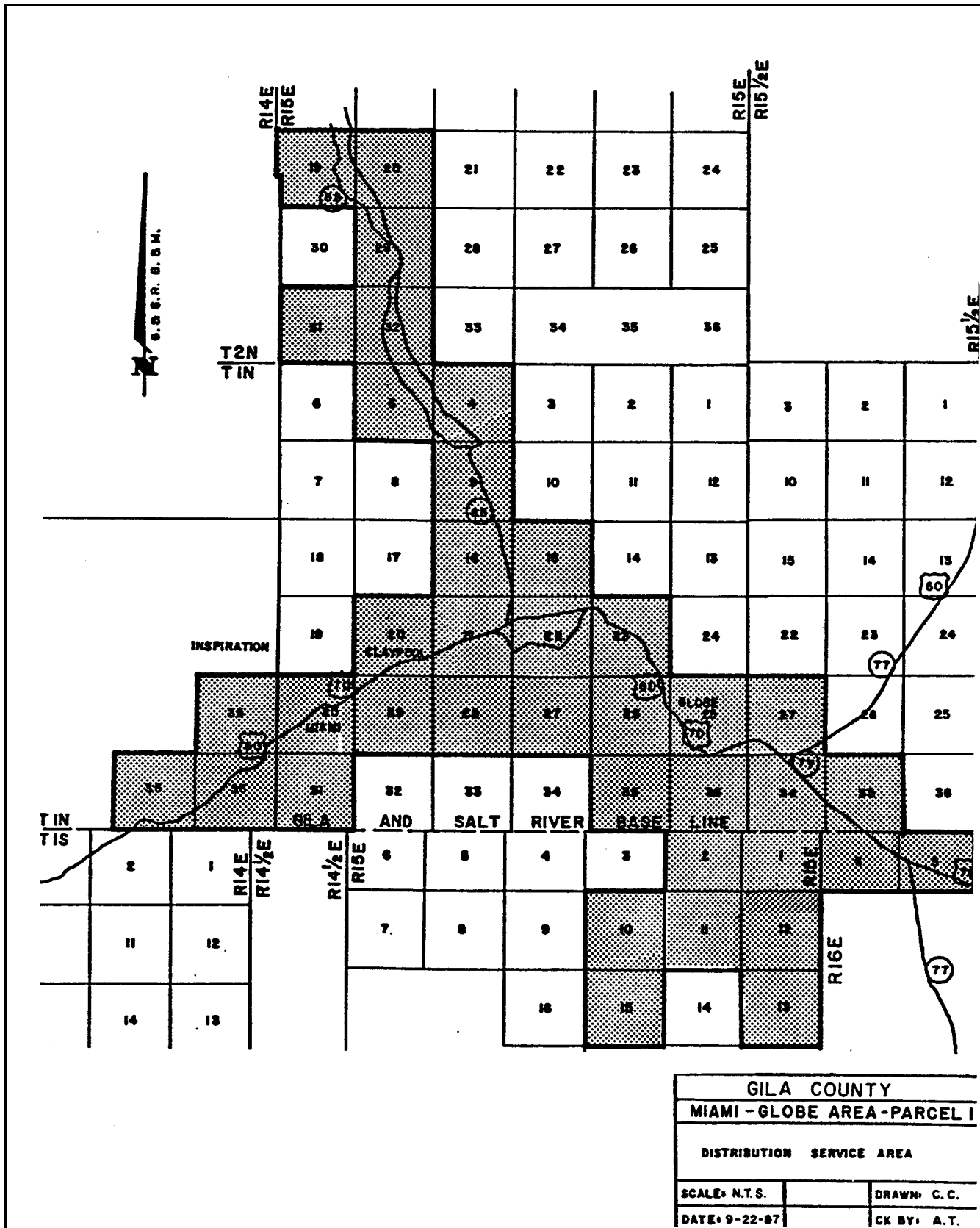

Issued On August 29, 1997  
 Docket No. U-1551-96-596

Issued by  
 Edward S. Zub  
 Senior Vice President

Effective September 1, 1997  
 Decision No. 60352

SOUTHWEST GAS CORPORATION

P.O. Box 98510

Las Vegas, Nevada 89193-8510

Arizona Gas Tariff No. 7

Original A.C.C. Sheet No. 134

Canceling A.C.C. Sheet No.

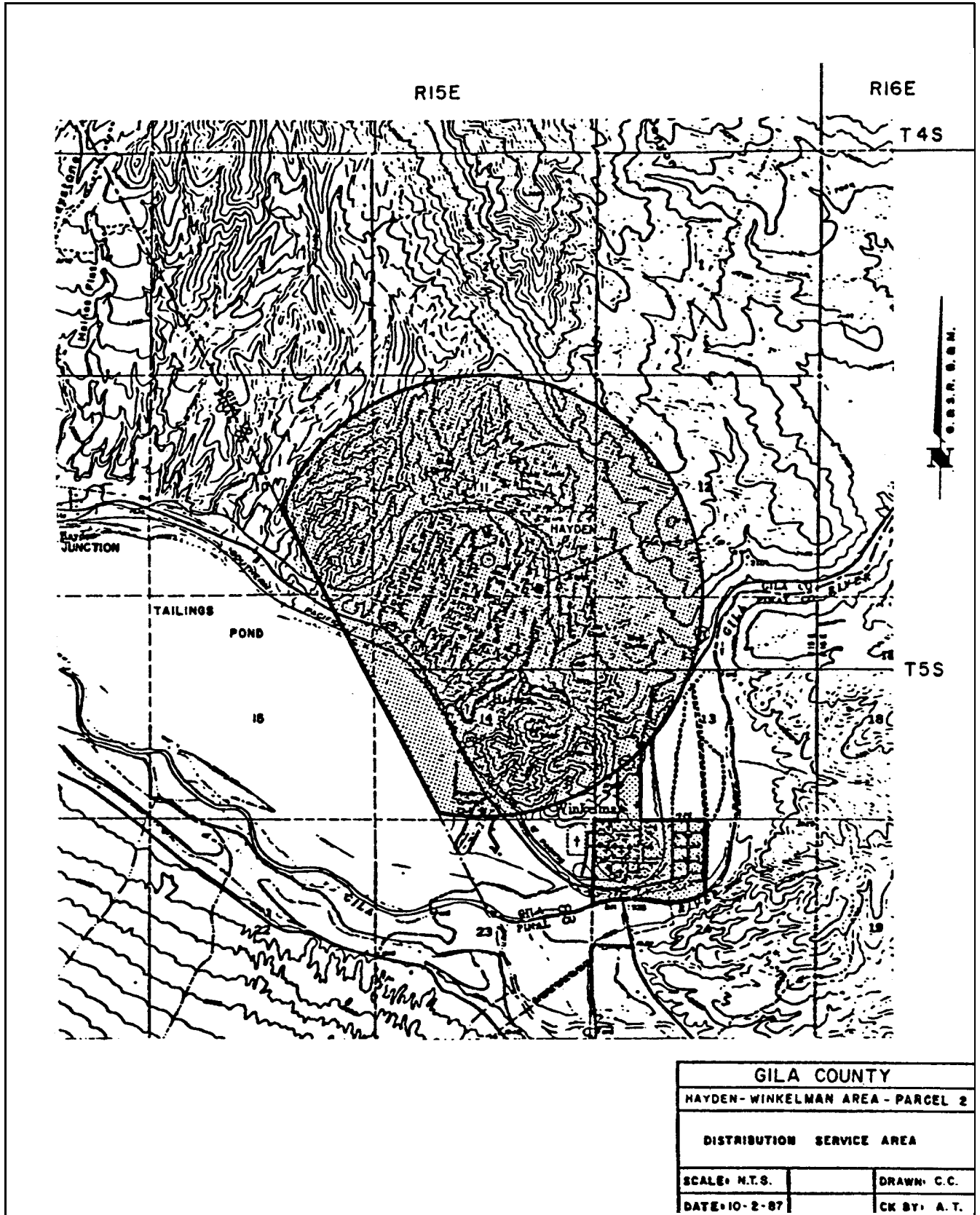

<b>GILA COUNTY</b>	
<b>HAYDEN-WINKELMAN AREA - PARCEL 2</b>	
<b>DISTRIBUTION SERVICE AREA</b>	
SCALE: N.T.S.	DRAWN: C.C.
DATE: 10-2-87	CK BY: A.T.

Issued On August 29, 1997  
Docket No. U-1551-96-596

Issued by  
Edward S. Zub  
Senior Vice President

Effective September 1, 1997  
Decision No. 60352

RULE NO. 2

CERTIFICATED GAS SERVICE AREA

The service area of Southwest Gas Corporation within Miami-Globe, County of Gila, State of Arizona, Gila and Salt River Baseline and Meridian, includes the following described area:

1. Township 2 North, Range 15 East, All of Sections 19, 20, 29, 31 and 32.
2. Township 1 North, Range 14 East, All of Sections 25, 35 and 36.
3. Township 1 North, Range 15 East, All of Sections 4, 5, 9, 15, 16, 20, 21, 22, 23, 25, 26, 27, 28, 29, 30, 31, 35 and 36.
4. Township 1 North, Range 15½ East, All of Sections 27, 34 and 35.
5. Township 1 South, Range 15 East, All of Sections 1, 2, 10, 11, 12, 13 and 15.
6. Township 1 South, Range 16 East, All of Sections 5 and 6.

Issued On August 29, 1997  
Docket No. U-1551-96-596

Issued by  
Edward S. Zub  
Senior Vice President

Effective September 1, 1997  
Decision No. 60352

RULE NO. 2

CERTIFICATED GAS SERVICE AREA

The service area of Southwest Gas Corporation within Hayden-Winkleman, County of Gila, State of Arizona, Gila and Salt River Baseline and Meridian, includes the following described area:

1. Township 5 South, Range 15 East, All of that portion of Sections 10, 11, 12, 13, 14 and 15 lying within a circle, one (1) mile in radius, centered at the southeast corner of the southwest quarter (SW 1/4) of said Section 11, and lying within Gila County, Arizona. Also, that portion of said Section 13 easterly from the west line of said Section 13 and along the south line thereof to Lobo Lane; thence north on Lobo Lane to Thorne Avenue; thence east and south on Thorne Avenue to the south line of said Section 13.
2. Township 5 South, Range 15 East, That portion of the northwest quarter (NW 1/4) of Section 24, lying within Gila County. Bounded on the south by the Gila River and on the east by the east line of said northwest quarter (NW 1/4) of Section 24.

Issued On August 29, 1997  
Docket No. U-1551-96-596

Issued by  
Edward S. Zub  
Senior Vice President

Effective September 1, 1997  
Decision No. 60352



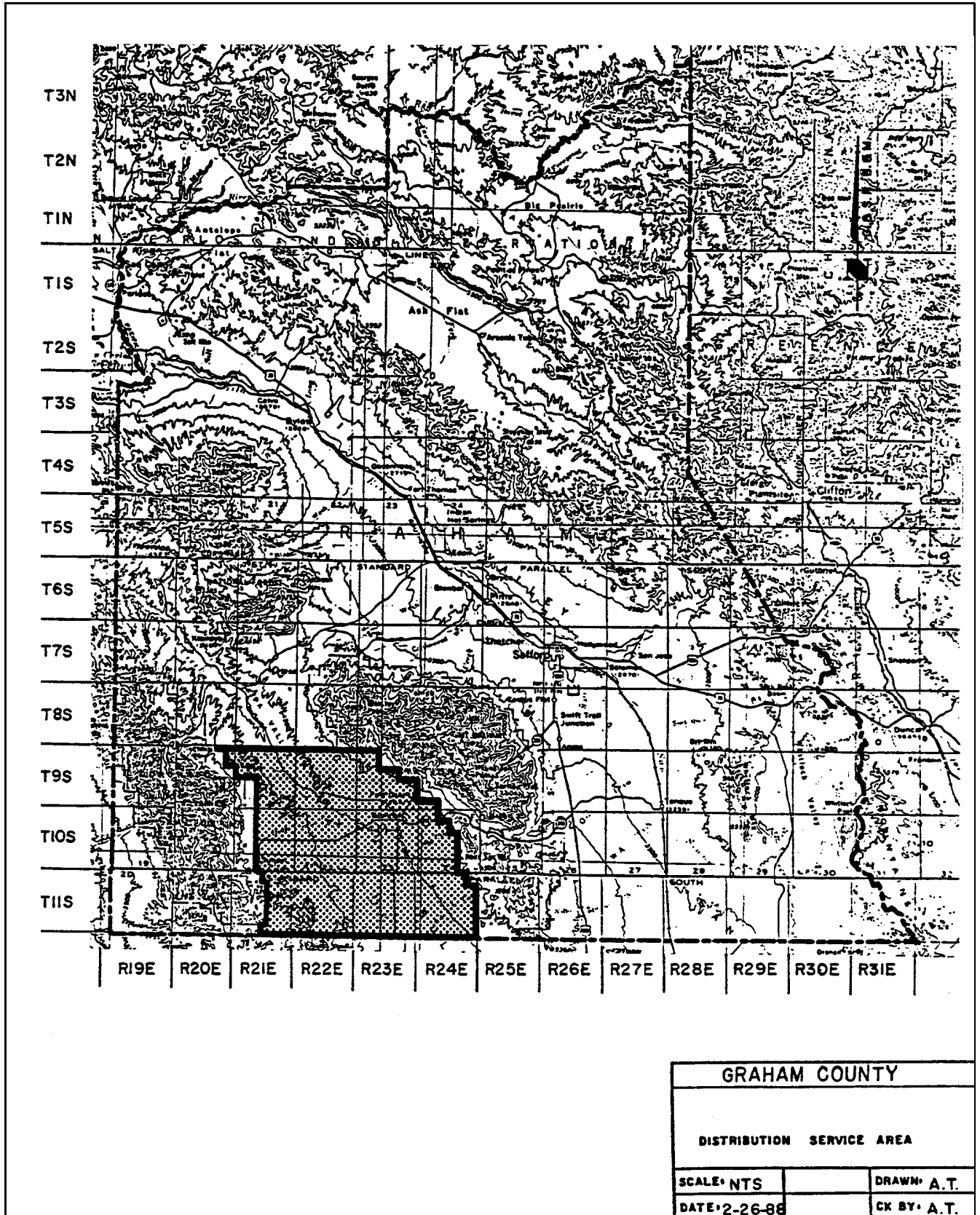

Issued On August 29, 1997  
 Docket No. U-1551-96-596

Issued by  
 Edward S. Zub  
 Senior Vice President

Effective September 1, 1997  
 Decision No. 60352

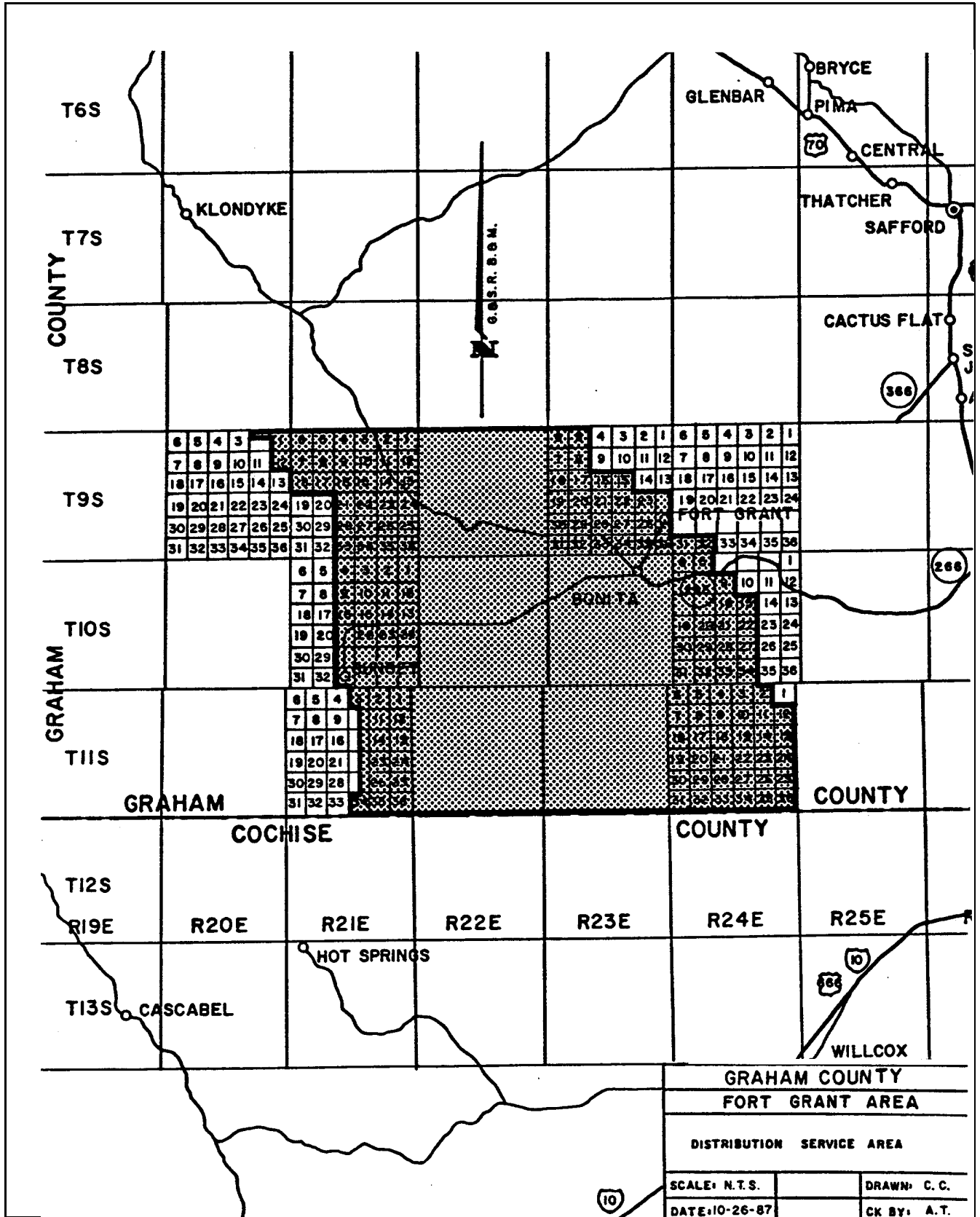

RULE NO. 2

CERTIFICATED GAS SERVICE AREA

The service area of Southwest Gas Corporation within the County of Graham, State of Arizona, Gila and Salt River Baseline and Meridian, includes the following described area:

1. Township 9 South, Range 20 East, All of Sections 1 and 12 and the north half (N 1/2) of Section 2.
2. Township 9 South, Range 21 East, All of Sections 1, 2, 3, 4, 5, 6, 7, 8, 9, 10, 11, 12, 13, 14, 15, 16, 17, 18, 21, 22, 23, 24, 25, 26, 27, 28, 33, 34, 35 and 36.
3. Township 9 South, Range 22 East.
4. Township 9 South, Range 23 East, All of Sections 5, 6, 7, 8, 15, 16, 17, 18, 19, 20, 21, 22, 23, 24, 25, 26, 27, 28, 29, 30, 31, 32, 33, 34, 35 and 36.
5. Township 9 South, Range 24 East, Sections 31 and 32.
6. Township 10 South, Range 21 East, All of Sections 1, 2, 3, 4, 9, 10, 11, 12, 13, 14, 15, 16, 21, 22, 23, 24, 25, 26, 27, 28, 33, 34, 35 and 36.
7. Township 10 South, Range 22 and 23 East.
8. Township 10 South, Range 24 East, All of Sections 5, 6, 7, 8, 9, 15, 16, 17, 18, 19, 20, 21, 22, 27, 28, 29, 30, 31, 32, 33 and 34.
9. Township 11 South, Range 21 East, All of Sections 1, 2, 3, 11, 12, 13, 14, 23, 24, 25, 26, 34, 35 and 36 and the east half (E 1/2) of Sections 10, 15, 22 and 27.
10. Township 11 South, Range 22 and 23 East.
11. Township 11 South, Range 24 East, All of Sections 2, 3, 4, 5, 6, 7, 8, 9, 10, 11, 12, 13, 14, 15, 16, 17, 18, 19, 20, 21, 22, 23, 24, 25, 26, 27, 28, 29, 30, 31, 32, 33, 34, 35 and 36.

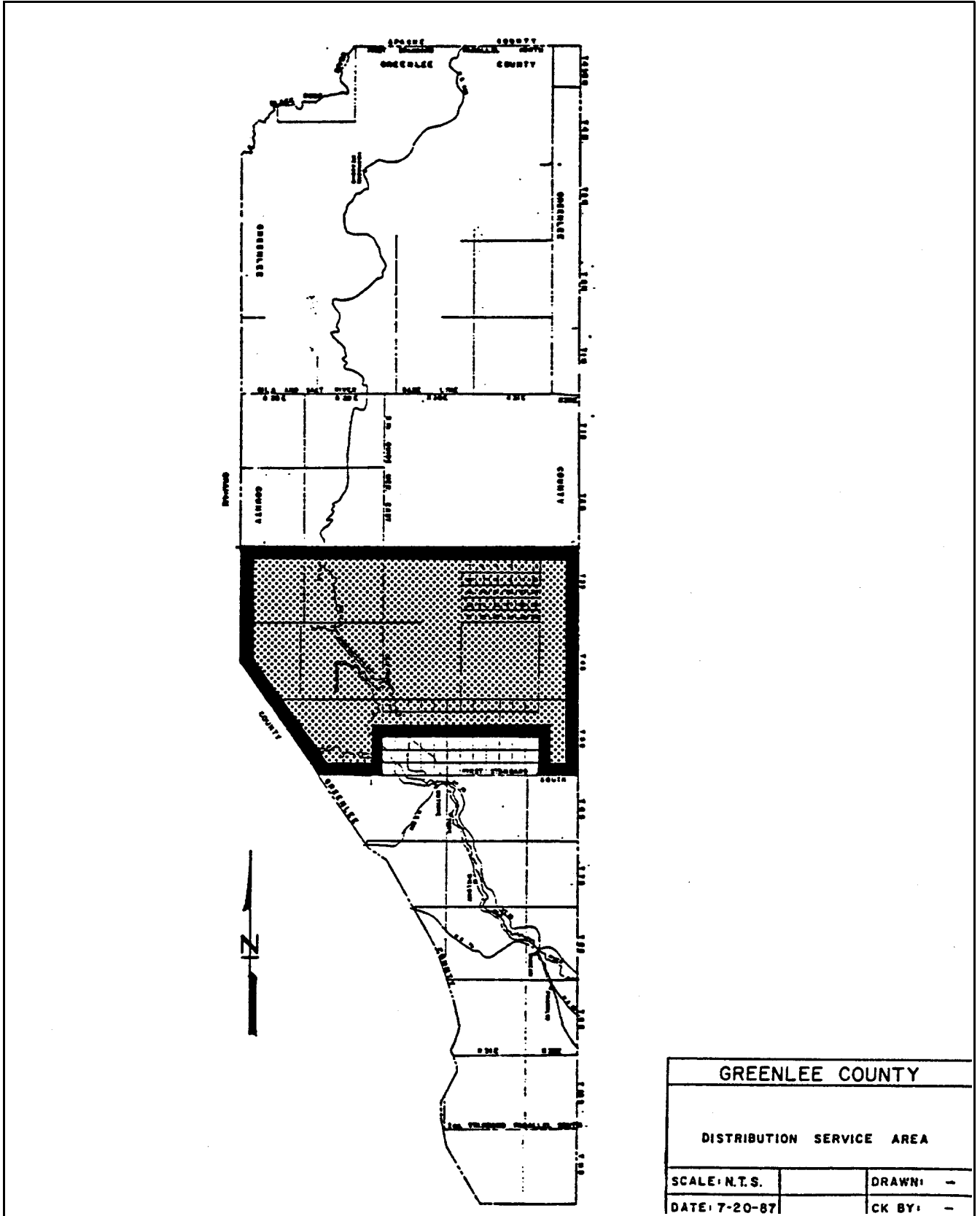

<b>GREENLEE COUNTY</b>	
<b>DISTRIBUTION SERVICE AREA</b>	
SCALE: N.T.S.	DRAWN: -
DATE: 7-20-87	CK BY: -

Issued On August 29, 1997  
Docket No. U-1551-96-596

Issued by  
Edward S. Zub  
Senior Vice President

Effective September 1, 1997  
Decision No. 60352

RULE NO. 2

CERTIFICATED GAS SERVICE AREA

The service area of Southwest Gas Corporation within the County of Greenlee, Gila and Salt River Baseline and Meridian, State of Arizona, includes the following described area:

1. Township 3 South, Range 28 East, All that portion lying within Greenlee County.
2. Township 3 South, Ranges 29, 30 and 31 East.
3. Township 3 South, Range 32 East, All that portion lying within Greenlee County.
4. Township 4 South, Range 28 East, All that portion lying within Greenlee County.
5. Township 4 South, Ranges 29, 30 and 31 East.
6. Township 4 South, Range 32 East, All that portion lying within Greenlee County.
7. Township 5 South, Range 28 East, All that portion lying within Greenlee County.
8. Township 5 South, Range 29 East, All that portion lying within Greenlee County.
9. Township 5 South, Range 30 East, All of Sections 1, 2, 3, 4, 5, 6, 7, 8, 9, 10, 11, 12, 13, 14, 15, 16, 17 and 18.
10. Township 5 South, Range 31 East, All of Sections 1, 2, 3, 4, 5, 6, 7, 8, 9, 10, 11, 12, 13, 14, 15, 16, 17 and 18.
11. Township 5 South, Range 32 East, All that portion lying within Greenlee County.

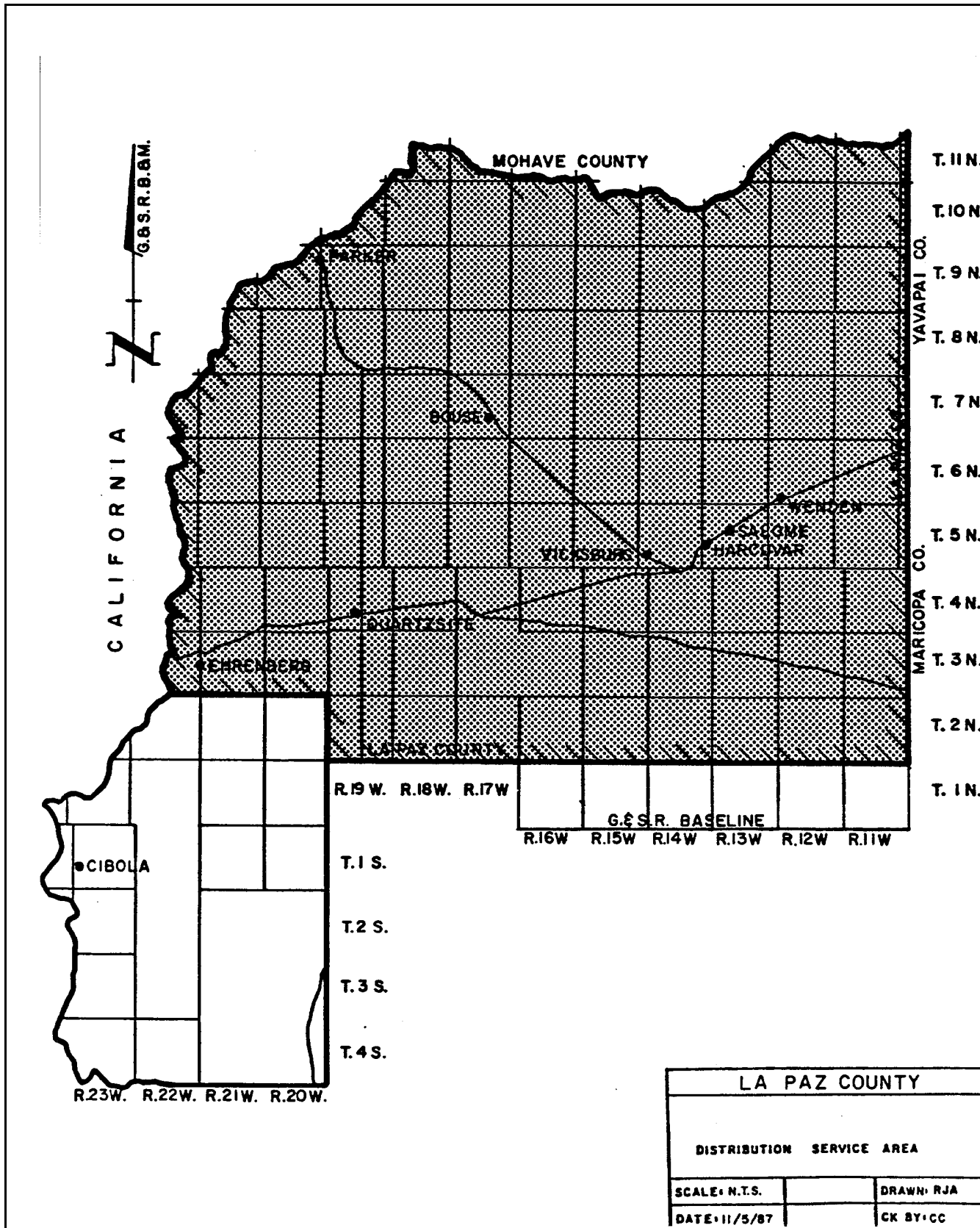

RULE NO. 2

CERTIFICATED GAS SERVICE AREA

The service area of Southwest Gas Corporation within the County of La Paz, State of Arizona, Gila and Salt River Baseline and Meridian, includes the following described area:

1. Township 11 North, Range 10 West, All that portion lying within La Paz County.
2. Township 11 North, Range 11 West, All that portion lying within La Paz County.
3. Township 11 North, Range 12 West, All that portion lying within La Paz County.
4. Township 11 North, Range 13 West, All that portion lying within La Paz County.
5. Township 11 North, Range 15 West, All that portion lying within La Paz County.
6. Township 11 North, Range 16 West, All that portion lying within La Paz County.
7. Township 11 North, Range 17 West, All that portion lying within La Paz County.
8. Township 11 North, Range 18 West, All that portion lying within La Paz County.
9. Township 10 North, Range 10 West, All that portion lying within La Paz County.
10. Township 10 North, Ranges 11, 12 and 17 West.
11. Township 10 North, Range 13 West, All that portion lying within La Paz County.
12. Township 10 North, Range 14 West, All that portion lying within La Paz County.
13. Township 10 North, Range 15 West, All that portion lying within La Paz County.

RULE NO. 2

CERTIFICATED GAS SERVICE AREA

*(Continued)*

14. Township 10 North, Range 16 West, All that portion lying within La Paz County.
15. Township 10 North, Range 18 West, All that portion lying within La Paz County.
16. Township 10 North, Range 19 West, All that portion lying within La Paz County.
17. Township 10 North, Range 20 West, All that portion lying within La Paz County.
18. Township 9 North, Range 10 West, All that portion lying within La Paz County.
19. Township 9 North, Ranges 11, 12, 13, 14, 15, 16, 17, 18 and 19 West.
20. Township 9 North, Range 20 West, All that portion lying within La Paz County.
21. Township 9 North, Range 21 West, All that portion lying within La Paz County.
22. Township 8 North, Range 10 West, All that portion lying within La Paz County.
23. Township 8 North, Ranges 11, 12, 13, 14, 15, 16, 17, 18, 19 and 20 West.
24. Township 8 North, Range 21 West, All that portion lying within La Paz County.
25. Township 7 North, Range 10 West, All that portion lying within La Paz County.
26. Township 7 North, Ranges 11, 12, 13, 14, 15, 16, 17, 18, 19 and 20 West.

Issued On August 29, 1997  
Docket No. U-1551-96-596

Issued by  
Edward S. Zub  
Senior Vice President

Effective September 1, 1997  
Decision No. 60352



RULE NO. 2

CERTIFICATED GAS SERVICE AREA

*(Continued)*

- 27. Township 7 North, Range 21 West, All that portion lying within La Paz County.
- 28. Township 7 North, Range 22 West, All that portion lying within La Paz County.
- 29. Township 6 North, Range 10 West, All that portion lying within La Paz County.
- 30. Township 6 North, Ranges 11, 12, 13, 14, 15, 16, 17, 18, 19, 20 and 21 West.
- 31. Township 6 North, Range 22 West, All that portion lying within La Paz County.
- 32. Township 5 North, Range 10 West, All that portion lying within La Paz County.
- 33. Township 5 North, Ranges 11, 12, 13, 14, 15, 16, 17, 18, 19, 20 and 21 West.
- 34. Township 5 North, Range 22 West, All that portion lying within La Paz County.
- 35. Township 4 North, Ranges 11, 12, 13, 14, 15, 16, 17, 18, 19, 20 and 21 West.
- 36. Township 4 North, Range 22 West, All that portion lying within La Paz County.
- 37. Township 3 North, Ranges 11, 12, 13, 14, 15, 16, 17, 18, 19, 20 and 21 West.
- 38. Township 3 North, Range 22 West, All that portion lying within La Paz County.
- 39. Township 2 North, Ranges 11, 12, 13, 14, 15, 16, 17, 18 and 19 West.

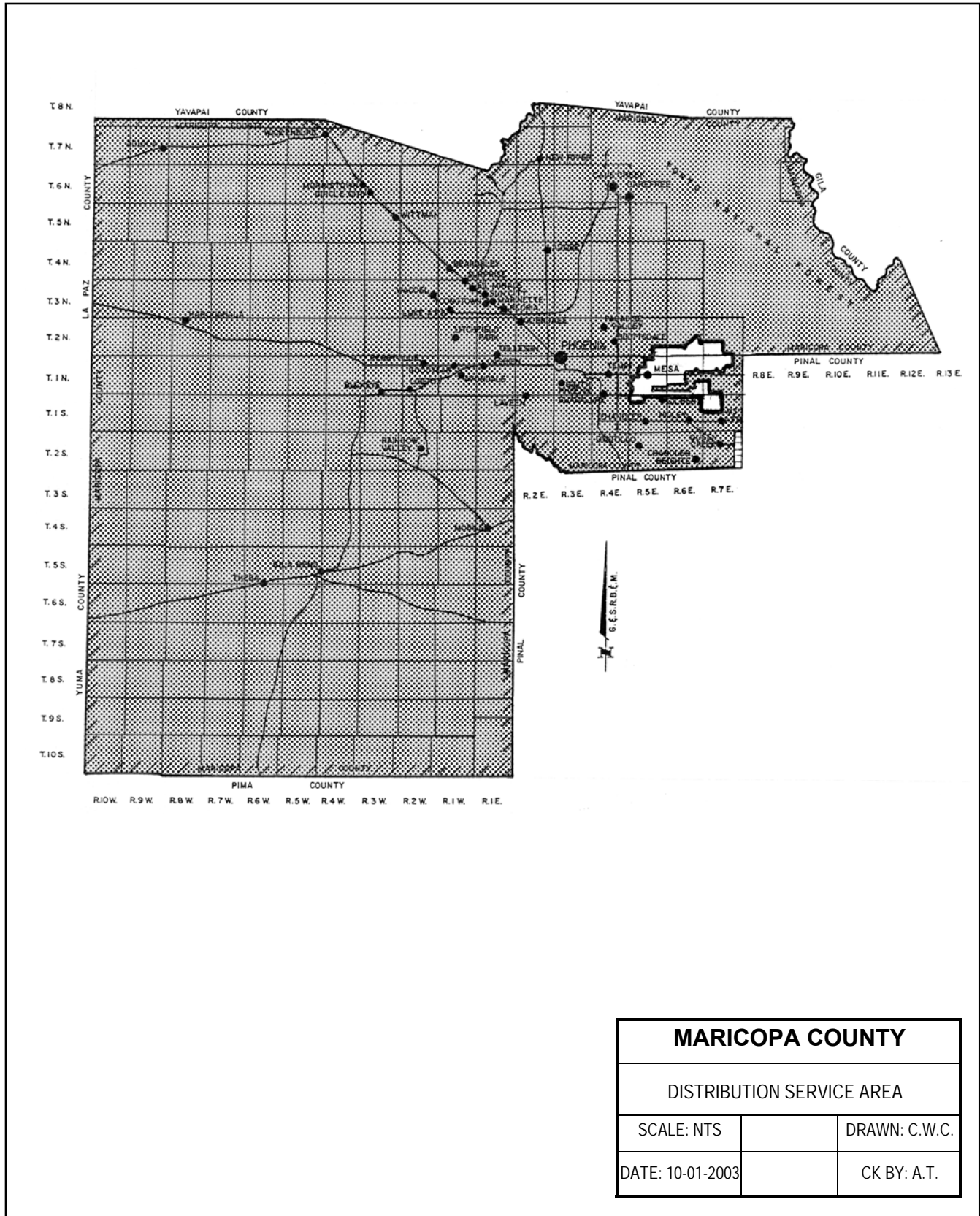

<b>MARICOPA COUNTY</b>	
DISTRIBUTION SERVICE AREA	
SCALE: NTS	DRAWN: C.W.C.
DATE: 10-01-2003	CK BY: A.T.

SOUTHWEST GAS CORPORATION  
P.O. Box 98510  
Las Vegas, Nevada 89193-8510  
Arizona Gas Tariff No. 7  
Arizona Division

Canceling Second Revised A.C.C. Sheet No. 147  
First Revised A.C.C. Sheet No. 147

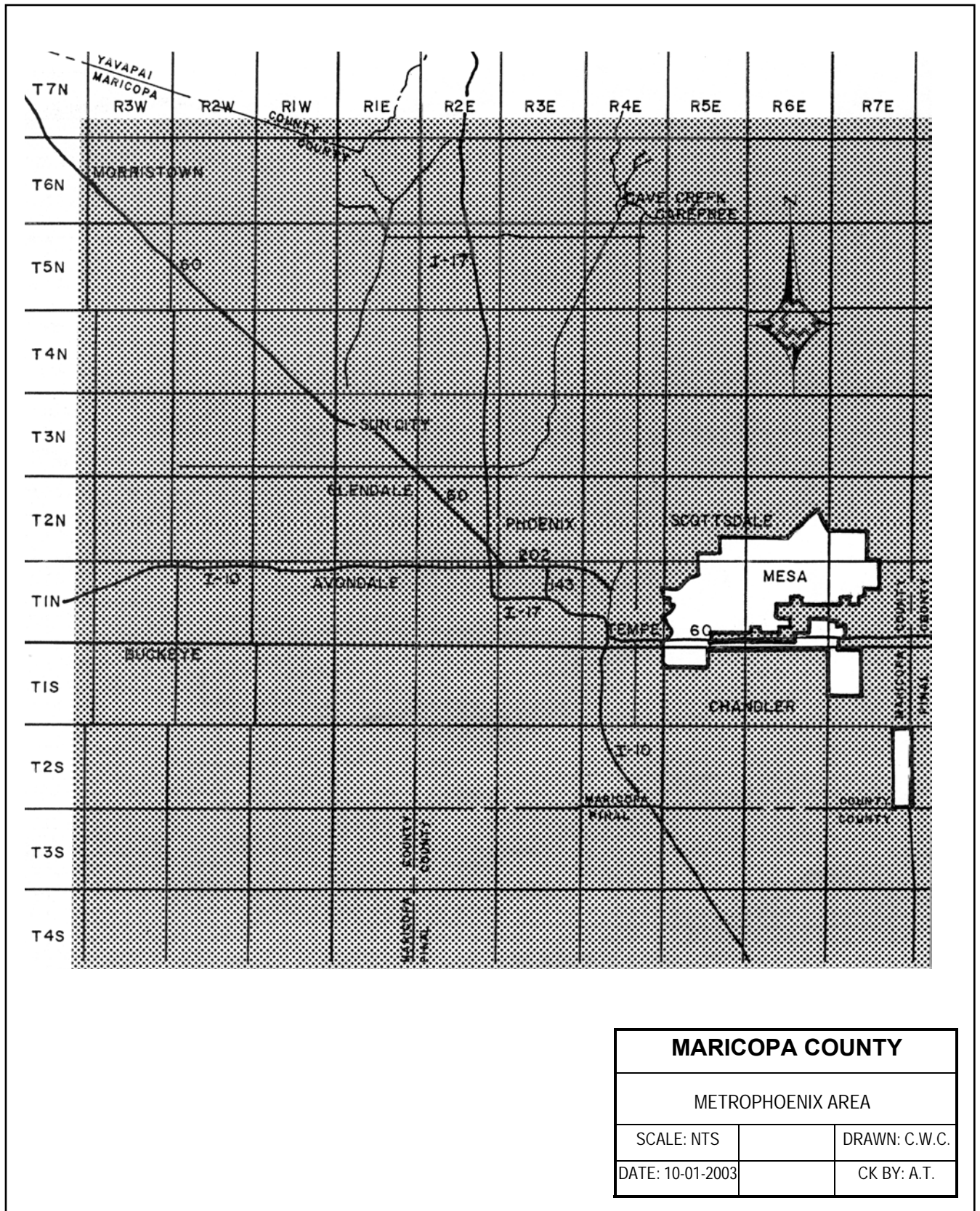

<b>MARICOPA COUNTY</b>		
METROPHOENIX AREA		
SCALE: NTS		DRAWN: C.W.C.
DATE: 10-01-2003		CK BY: A.T.

Issued On October 16, 2003 Issued by Edward S. Zub Effective October 21, 2003  
Docket No. G-01551A-02-0425 Executive Vice President Decision No. 66101

RULE NO. 2

CERTIFICATED GAS SERVICE AREA

The service area of Southwest Gas Corporation within the County of Maricopa, State of Arizona, Gila and Salt River Baseline and Meridian, includes all of Maricopa County,

EXCEPTING:

1. Township 2 North, Range 5 East,  
     Sections 25, 26 and 34, S 1/2.  
     Section 33, SE 1/4.  
     All of Sections 35 and 36.
2. Township 2 North, Range 6 East,  
     Section 13, All that portion south of the Salt River Indian Reservation Boundary and west of the C.A.P. canal.  
     Sections 14, 22, 23, and 27, All that portion south of the Salt River Indian Reservation Boundary.  
     Section 24, All that portion west of the C.A.P. canal.  
     All of Sections 25, 26, 31, 32, 33, 34, 35, and 36.  
     Sections 28, 29 and 30, S 1/2.
3. Township 2 North, Range 7 East,  
     All of Sections 28, 29, 30, 31, 32, and 33.
4. Township 1 North, Range 5 East,  
     All of Sections 1, 2, 3, 10, 11, 12, 13, 14, 15, 16, 17, 20, 21, 22, 23, 24, 28, 29, 32, and 33.  
     Section 4, E 1/2.  
     Section 18, N 1/2, SE 1/4.  
     Sections 19, 30 and 31, All that portion east of the Tempe Canal/City of Mesa Boundary.  
     Sections 25 and 26, N 1/2, N 1/2 S 1/2, N 1/2 S 1/2 S 1/2.  
     Section 27, N 1/2, SW 1/4, N 1/2 SE 1/4, N 1/2 S 1/2 SE 1/4.  
     Section 34, S 1/2, NW 1/4, S 1/2 NE 1/4, S 1/2 N 1/2 NE 1/4.  
     Sections 35 and 36, S 1/2, S 1/2 N 1/2, S 1/2 N 1/2 N 1/2.



SOUTHWEST GAS CORPORATION

P.O. Box 98510

Las Vegas, Nevada 89193-8510

Arizona Gas Tariff No. 7

Arizona Division

Canceling \_\_\_\_\_ First Revised \_\_\_\_\_ A.C.C. Sheet No. 150  
Original \_\_\_\_\_ A.C.C. Sheet No. 150

RULE NO. 2

CERTIFICATED GAS SERVICE AREA

*(Continued)*

8. Township 1 South, Range 7 East,

Sections 4, 9, 16, and 21, All that portion west of the centerline of the proposed Santan Freeway (Southeast Loop Highway).

All of Sections 5, 6, 7, 8, 17, and 18.

Sections 19, 20 and 21, All that portion north of the centerline of the proposed Santan Freeway (Southwest Loop Highway).

9. Township 2 South, Range 7 East,

All of Sections 1, 12, 13, 24, 25, and 36.

Issued On October 16, 2003  
Docket No. G-01551A-02-0425

Issued by  
Edward S. Zub  
Executive Vice President

Effective October 21, 2003  
Decision No. 66101



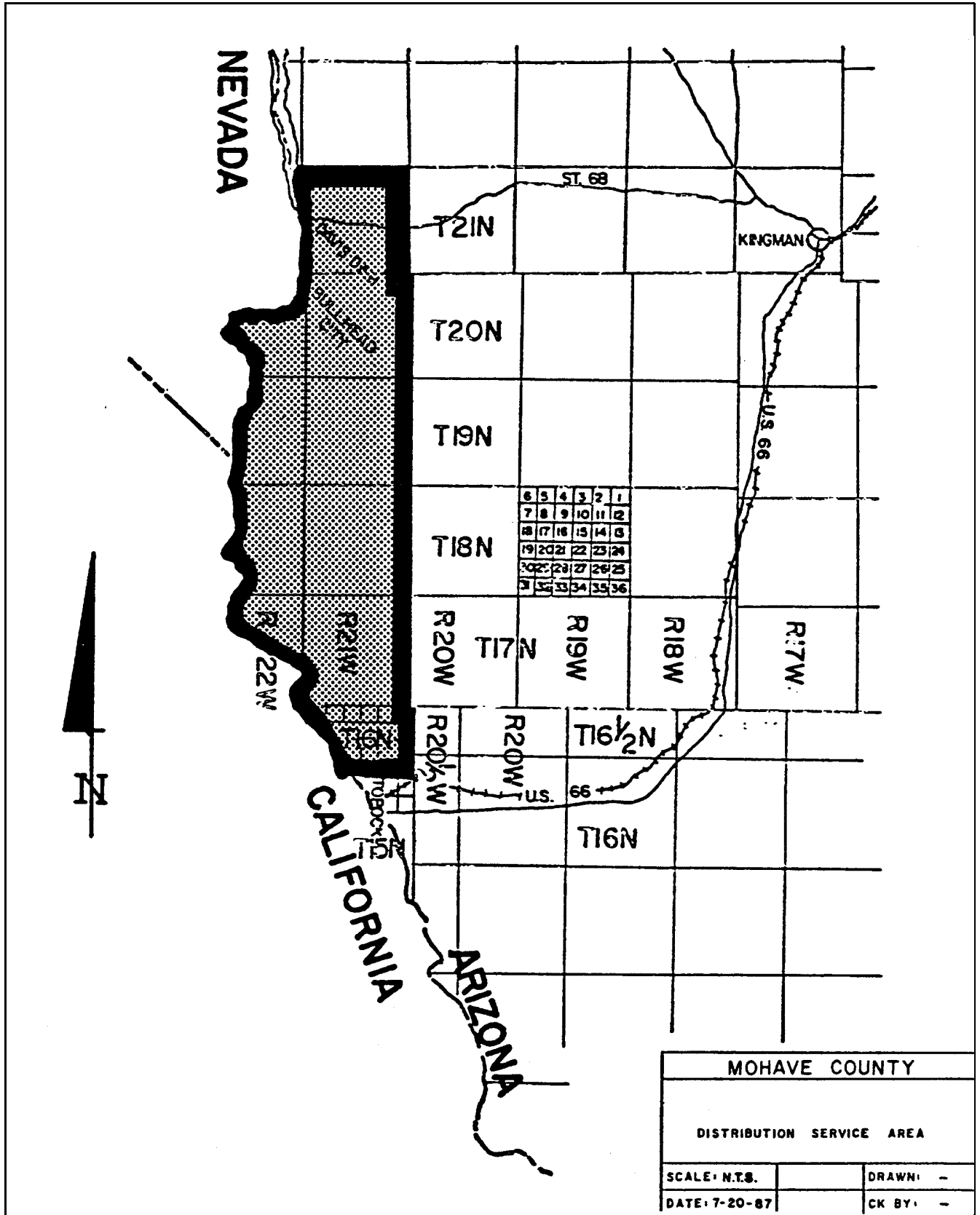

Issued On August 29, 1997  
Docket No. U-1551-96-596

Issued by  
Edward S. Zub  
Senior Vice President

Effective September 1, 1997  
Decision No. 60352



RULE NO. 2

CERTIFICATED GAS SERVICE AREA

The service area of Southwest Gas Corporation within the County of Mohave, State of Arizona, Gila and Salt River Baseline and Meridian, includes the following described area:

1. Township 16 North, Range 21 West, All of Sections 1, 2, 3, 4, 5, 6, 7, 8, 9, 10, 11, 12, 13, 14, 15, 16, 17, 18, 21, 22, 23 and 24 and those portions of Sections 19 and 20 lying within Mohave County.
2. Township 16 North, Range 22 West, All that portion lying within Mohave County.
3. Township 17 North, Range 21 West, All that portion lying within Mohave County.
4. Township 17 North, Range 22 West, All that portion lying within Mohave County.
5. Township 18 North, Range 21 West.
6. Township 18 North, Range 22 West, All that portion lying within Mohave County.
7. Township 19 North, Range 21 West.
8. Township 19 North, Range 22 West, All that portion lying within Mohave County.
9. Township 20 North, Range 21 West.
10. Township 20 North, Range 22 West, All that portion lying within Mohave County.
11. Township 21 North, Range 21 West, All that portion lying within Mohave County.
12. Township 21 North, Range 22 West, All that portion lying within Mohave County.

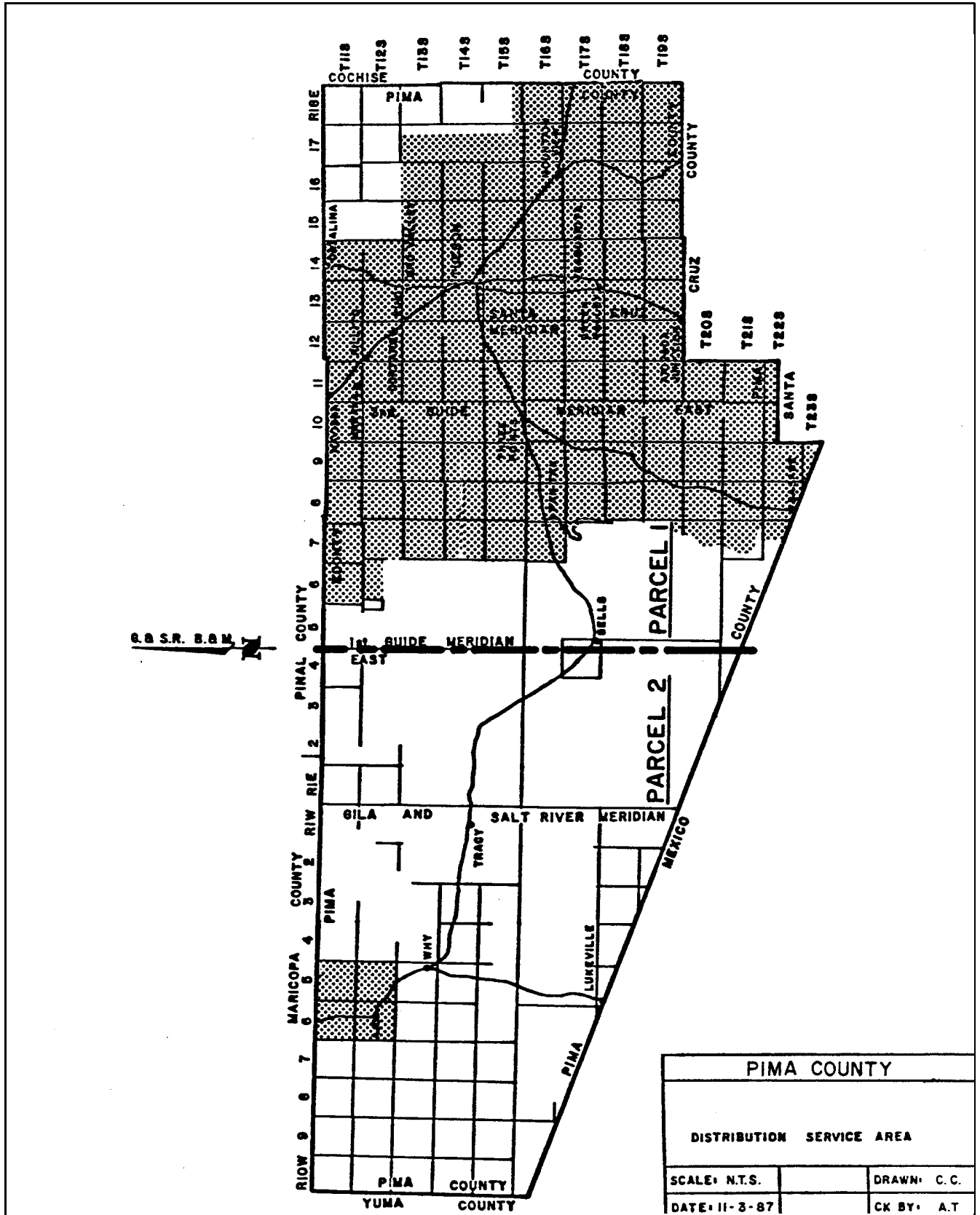

Issued On August 29, 1997  
Docket No. U-1551-96-596

Issued by  
Edward S. Zub  
Senior Vice President

Effective September 1, 1997  
Decision No. 60352

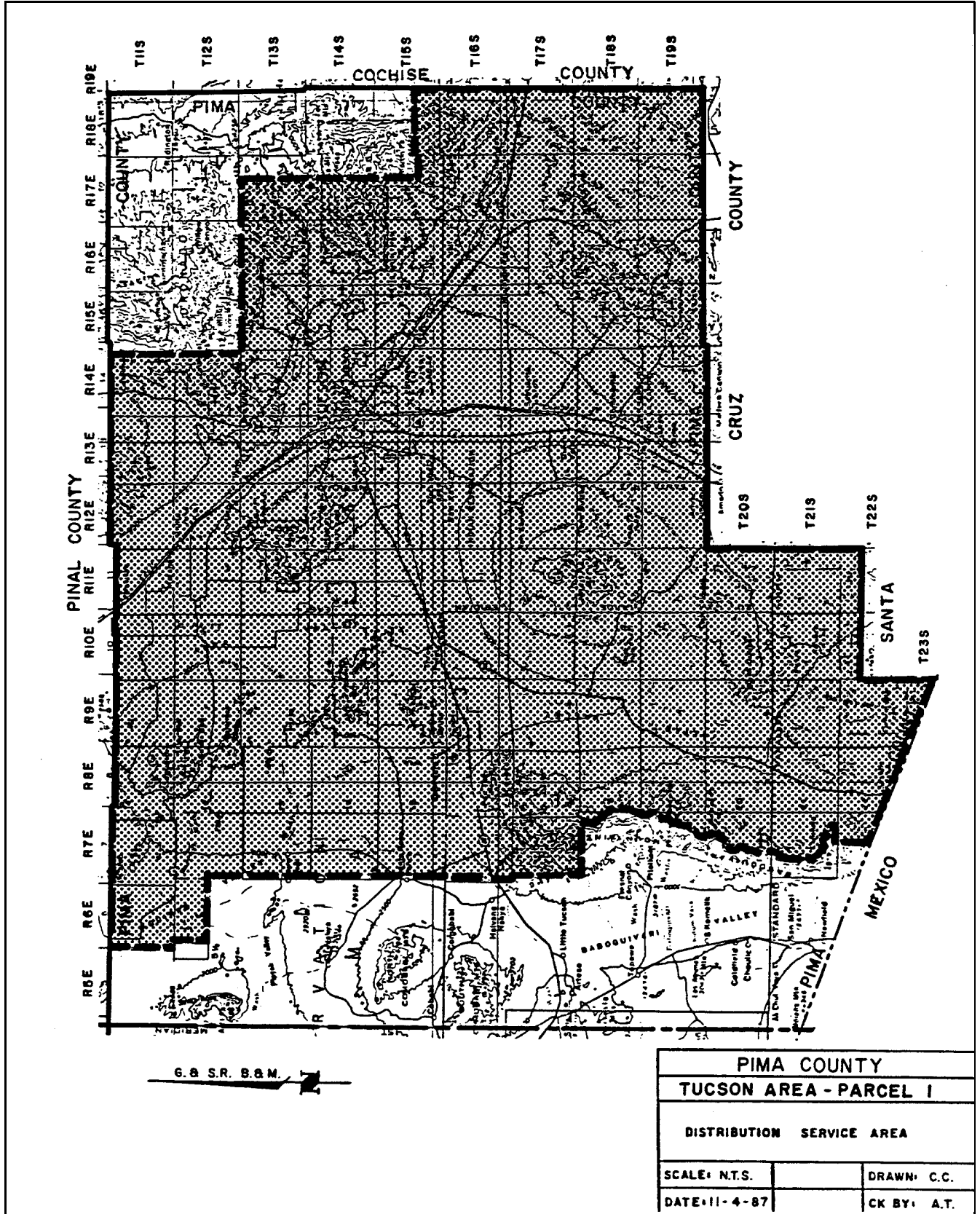

Issued On August 29, 1997  
Docket No. U-1551-96-596

Issued by  
Edward S. Zub  
Senior Vice President

Effective September 1, 1997  
Decision No. 60352

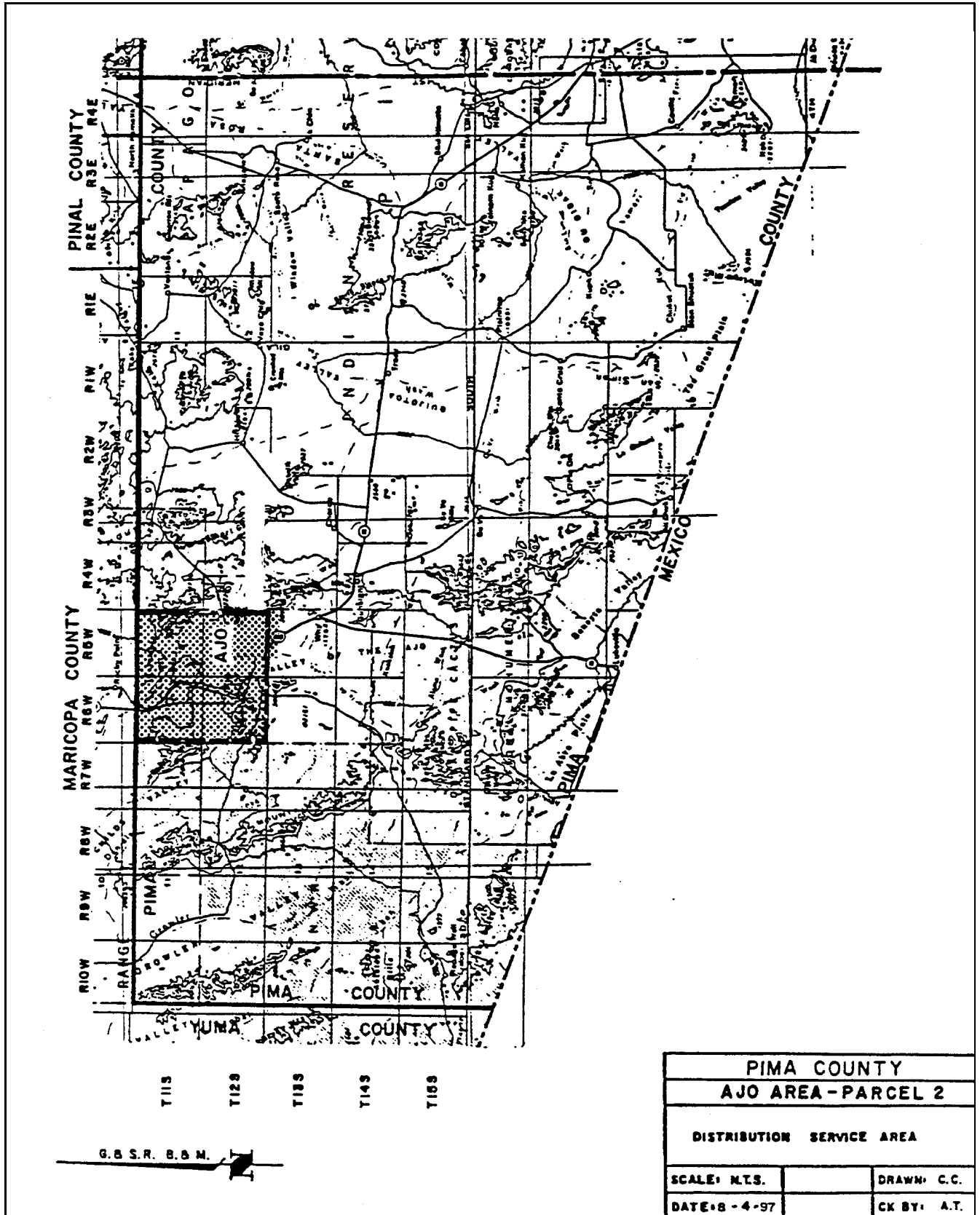

<b>PIMA COUNTY</b>	
<b>AJO AREA - PARCEL 2</b>	
<b>DISTRIBUTION SERVICE AREA</b>	
SCALE: N.T.S.	DRAWN: C.C.
DATE: 8-4-97	CK BY: A.T.

Issued On August 29, 1997  
 Docket No. U-1551-96-596

Issued by  
 Edward S. Zub  
 Senior Vice President

Effective September 1, 1997  
 Decision No. 60352

RULE NO. 2

CERTIFICATED GAS SERVICE AREA

The service area of Southwest Gas Corporation within the County of Pima, State of Arizona, Gila and Salt River Baseline and Meridian, includes the following described area:

1. Township 11 South, Ranges 5 and 6 West.
2. Township 11 South, Ranges 6, 7, 8, 9, 10, 11, 12, 13 and 14 East.
3. Township 12 South, Ranges 5 and 6 West.
4. Township 12 South, Range 6 East, All of Sections 1, 2, 3, 4, 5, 6, 7, 8, 9, 10, 11, 12, 13, 14, 15, 16, 17 and 18.
5. Township 12 South, Ranges 7, 8, 9, 10, 11, 12, 13 and 14 East.
6. Township 13 South, Ranges 7, 8, 9, 10, 11, 12, 13, 14, 15 and 16 East.
7. Township 13 South, Range 17 East, All of Sections 3, 4, 5, 6, 7, 8, 9, 10, 15, 16, 17, 18, 19, 20, 21, 22, 27, 28, 29, 30, 31, 32, 33 and 34.
8. Township 14 South, Ranges 7, 8, 9, 10, 11, 12, 13, 14, 15 and 16, East.
9. Township 14 South, Range 17 East, All of Sections 3, 4, 5, 6, 7, 8, 9, 10, 15, 16, 17, 18, 19, 20, 21, 22, 27, 28, 29, 30, 31, 32, 33 and 34.
10. Township 15 South, Ranges 7, 8, 9, 10, 11, 12, 13, 14, 15 and 16 East.
11. Township 15 South, Range 17 East, All of Sections 3, 4, 5, 6, 7, 8, 9, 10, 15, 16, 17, 18, 19, 20, 21, 22, 25, 26, 27, 28, 29, 30, 31, 32, 33, 34, 35 and 36.
12. Township 15 South, Range 18 East, All of Sections 25, 26, 27, 28, 29, 30, 31, 32, 33, 34 35 and 36.
13. Township 16 South, Ranges 7, 8, 9, 10, 11, 12, 13, 14, 15, 16, 17 and 18 East.

RULE NO. 2

CERTIFICATED GAS SERVICE AREA

*(Continued)*

14. Township 17 South, Ranges 7, 8, 9, 10, 11, 12, 13, 14, 15, 16, 17 and 18 East.
15. Township 18 South, Range 7 East, All that portion lying east of the easterly boundary of the Tohono O'Odham Indian Reservation.
16. Township 18 South, Range 8 East, All that portion lying east of the easterly boundary of the Tohono O'Odham Indian Reservation.
17. Township 18 South, Ranges 9, 10, 11, 12, 13, 14, 15, 16, 17 and 18 East.
18. Township 19 South, Range 7 East, All that portion lying east of the easterly boundary of the Tonono O'Odham Indian Reservation.
19. Township 19 South, Ranges 8, 9, 10, 11, 12, 13, 14, 15, 16, 17 and 18 East.
20. Township 20 South, Range 7 East, All that portion lying east of the easterly boundary of the Tohono O'Odham Indian Reservation.
21. Township 20 South, Ranges 8, 9, 10 and 11 East.
22. Township 21 South, Range 7 East, All that portion lying east of the easterly boundary of the Tohono O'Odham Indian Reservation.
23. Township 21 South, Ranges 8, 9, 10 and 11 East.
24. Township 22 South, Range 7 East, All that portion lying east of the easterly boundary of the Tohono O'Odham Indian Reservation and lying within Pima County.
25. Township 22 South, Range 8 East, All that portion lying within Pima County.
26. Township 22 South, Range 9 East.

RULE NO. 2

CERTIFICATED GAS SERVICE AREA  
(Continued)

27. Township 22 South, Range 10 East, All of Sections 1, 2, 3, 4, 5, 6, 7, 8, 9, 10, 11 and 12, All that portion lying within Pima County.
28. Township 22 South, Range 11 East, All of Sections 1, 2, 3, 4, 5, 6, 7, 8, 9, 10, 11 and 12, All that portion lying within Pima County.
29. Township 23 South, Range 8 East, All that portion lying within Pima County.
30. Township 23 South, Range 9 East, All that portion lying within Pima County.

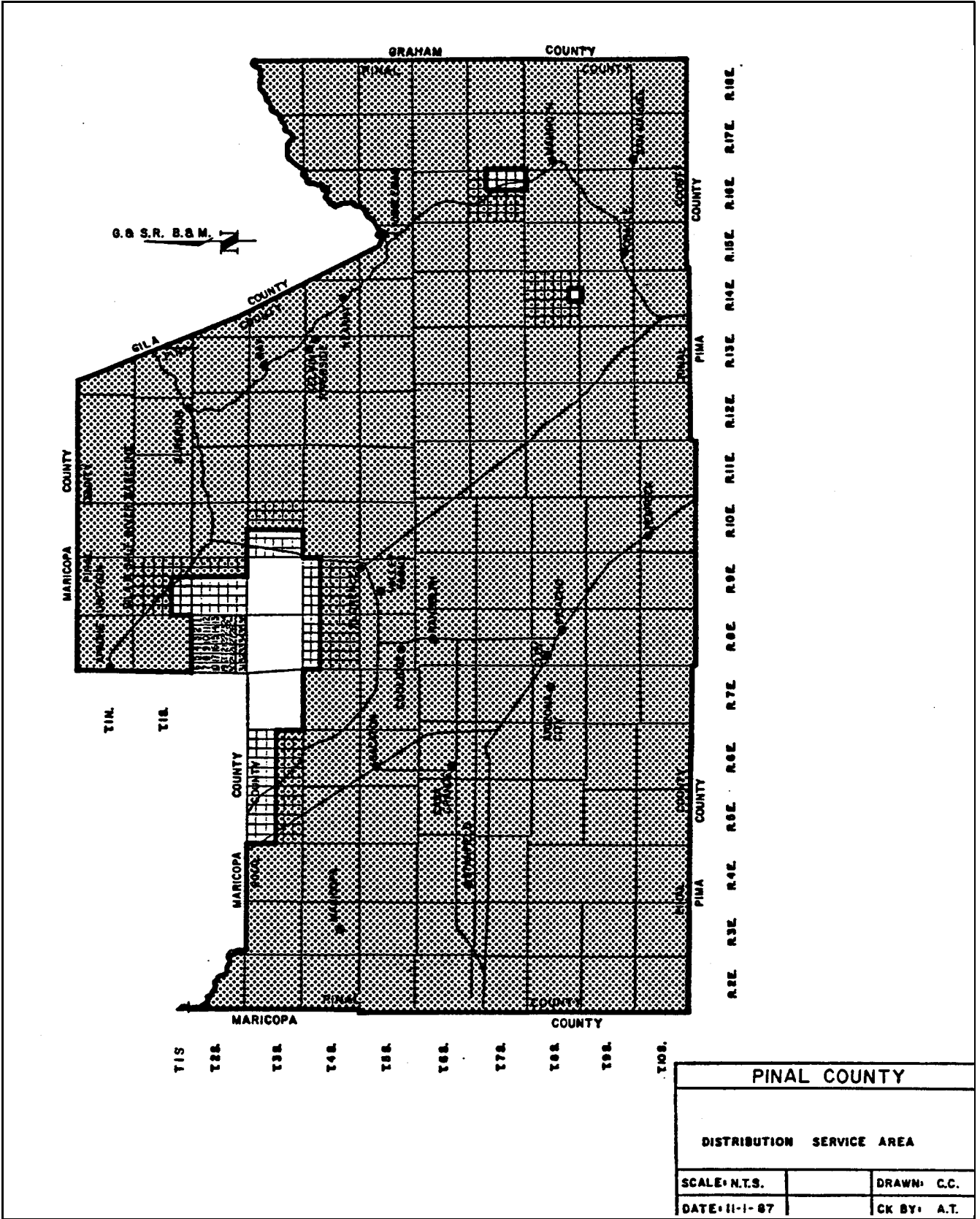

Issued On August 29, 1997  
Docket No. U-1551-96-596

Issued by  
Edward S. Zub  
Senior Vice President

Effective September 1, 1997  
Decision No. 60352



RULE NO. 2

CERTIFICATED GAS SERVICE AREA

The service area of Southwest Gas Corporation within County of Pinal, State of Arizona, Gila and Salt River Baseline and Meridian, includes the following described area:

1. Township 1 North, Ranges 8, 9, 10, 11 and 12 East.
2. Township 1 North, Range 13 East, All that portion lying within Pinal County, Arizona.
3. Township 1 South, Range 2 East, All that portion lying within Pinal County, Arizona.
4. Township 1 South, Ranges 8, 10, 11 and 12 East.
5. Township 1 South, Range 9 East, All of Sections 1, 2, 3, 4, 5, 6, 7, 8, 9, 10, 11, 12, 13, 14, 15, 16, 17, 18, 19, 20, 21, 22, 23, 24, 25, 26, 35 and 36.
6. Township 1 South, Range 13 East, All that portion lying within Pinal County.
7. Township 1 South, Range 14 East, All that portion lying within Pinal County.
8. Township 2 South, Range 2 East, All that portion lying within Pinal County.
9. Township 2 South, Range 3 East, All of Section 31 lying within Pinal County.
10. Township 2 South, Range 9 East, All of Sections 1, 2, 11, 12, 13, 14, 23, 24, 25, 26, 35 and 36.
11. Township 2 South, Ranges 10, 11, 12 and 13 East.
12. Township 2 South, Range 14 East, All that portion within Pinal County.
13. Township 3 South, Ranges 2, 3, 4, 11, 12 and 13 East.
14. Township 3 South, Range 5 East, All of Sections 19, 20, 21, 22, 23, 24, 25, 26, 27, 28, 29, 30, 31, 32, 33, 34, 35 and 36.

RULE NO. 2

CERTIFICATED GAS SERVICE AREA

*(Continued)*

- 15. Township 3 South, Range 6 East, All of Sections 19, 20, 21, 22, 23, 24, 25, 26, 27, 28, 29, 30, 31, 32, 33, 34, 35 and 36.
- 16. Township 3 South, Range 10 East, All of Sections 1, 2, 3, 10, 11, 12, 13, 14, 15, 22, 23, 24, 25, 26, 27, 34, 35 and 36.
- 17. Township 3 South, Range 14 East, All that portion lying within Pinal County.
- 18. Township 3 South, Range 17; East, All that portion lying within Pinal County.
- 19. Township 3 South, Range 18 East, All that portion lying within Pinal County.
- 20. Township 4 South, Ranges 2, 3, 4, 5, 6, 7, 10, 11, 12, 13 and 18, East.
- 21. Township 4 South, Range 8 East, All of Sections 13, 14, 15, 16, 17, 18, 19, 20, 21, 22, 23, 24, 25, 26, 27, 28, 29, 30, 31, 32, 33, 34, 35 and 36.
- 22. Township 4 South, Range 9 East, All of Sections 13, 14, 15, 16, 17, 18, 19, 20, 21, 22, 23, 24, 25, 26, 27, 28, 29, 30, 31, 32, 33, 34, 35 and 36.
- 23. Township 4 South, Range 14 East, All that portion lying within Pinal County.
- 24. Township 4 South, Range 15 East, All that portion lying within Pinal County.
- 25. Township 4 South, Range 16 East, All that portion lying within Pinal County.
- 26. Township 4 South, Range 17 East, All that portion lying within Pinal County.
- 27. Township 5 South, Ranges 2, 3, 4, 5, 6, 7, 8, 9, 10, 11, 12, 13, 14, 17 and 18 East.
- 28. Township 5 South, Range 15 East, All that portion lying within Pinal County.
- 29. Township 5 South, Range 16 East, All that portion lying within Pinal County.

RULE NO. 2

CERTIFICATED GAS SERVICE AREA

*(Continued)*

- 30. Township 6 South, Ranges 2, 3, 4, 5, 6, 7, 8, 9, 10, 11, 12, 13, 14, 15, 16, 17 and 18, East.
- 31. Township 7 South, Ranges 2, 3, 4, 5, 6, 7, 8, 9, 10, 11, 12, 13, 14, 15, 17 and 18, East.
- 32. Township 7 South, Range 16 East, All of Sections 1, 2, 3, 4, 5, 6, 7, 8, 9, 10, 11, 12, 15, 16, 17, 18, 19, 20, 21, 22, 27, 28, 29, 30, 31, 32, 33 and 34.
- 33. Township 8 South, Ranges 2, 3, 4, 5, 6, 7, 8, 9, 10, 11, 12, 13, 15, 16, 17 and 18 East.
- 34. Township 8 South, Range 14 East, All of Sections 1, 2, 3, 4, 5, 6, 7, 8, 9, 10, 11, 12, 13, 14, 15, 16, 17, 18, 19, 20, 21, 22, 23, 24, 25, 26, 27, 28, 29, 30, 31, 32, 33, 35 and 36.
- 35. Township 9 South, Ranges 2, 3, 4, 5, 6, 7, 8, 9, 10, 11, 12, 13, 14, 15, 16, 17 and 18 East.
- 36. Township 10 South, Ranges 2, 3, 4, 5, 6, 7, 8, 9, 10, 11, 12, 13, 14, 15, 16, 17 and 18 East.

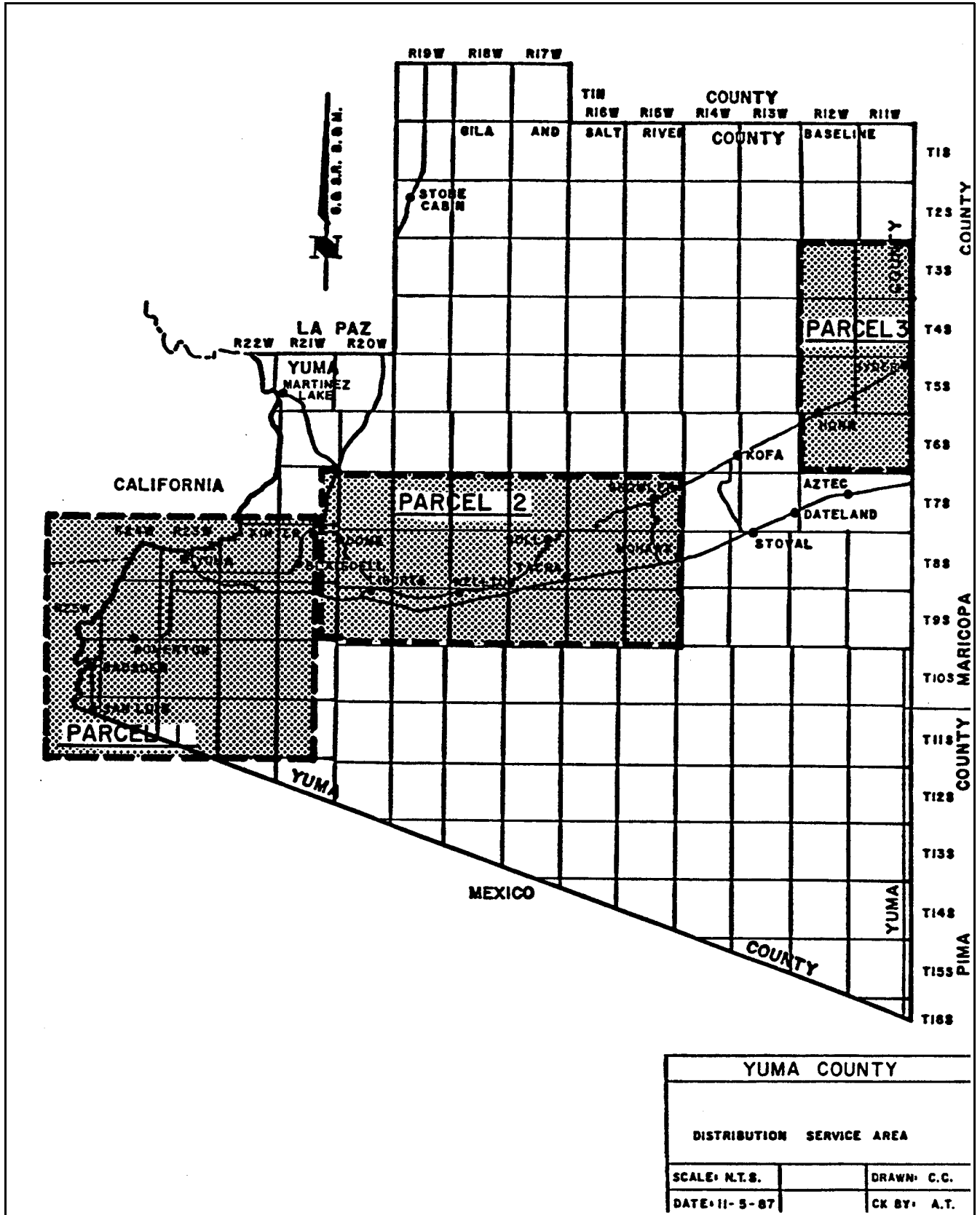

SOUTHWEST GAS CORPORATION  
 P.O. Box 98510  
 Las Vegas, Nevada 89193-8510  
 Arizona Gas Tariff No. 7  
 Arizona Division

Canceling First Revised A.C.C. Sheet No. 165  
Original A.C.C. Sheet No. 165

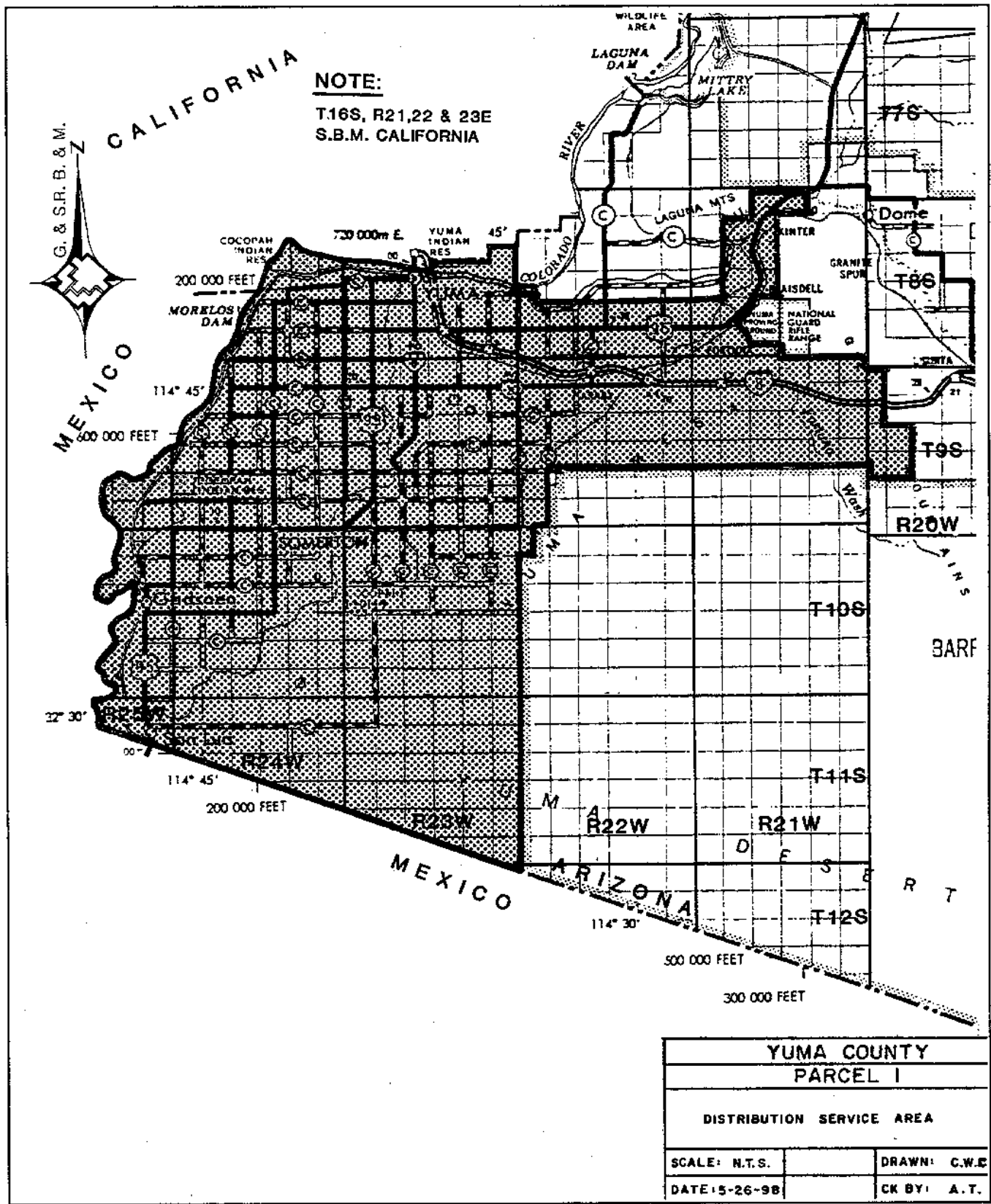

Issued On May 29, 1998      Issued by Edward S. Zub      Effective June 3, 1998  
 Docket No. U-1551-87-098      Senior Vice President      Decision No. 56074

SOUTHWEST GAS CORPORATION  
 P.O. Box 98510  
 Las Vegas, Nevada 89193-8510  
 Arizona Gas Tariff No. 7  
 Arizona Division

Canceling \_\_\_\_\_ First Revised \_\_\_\_\_ A.C.C. Sheet No. 166  
 Original \_\_\_\_\_ A.C.C. Sheet No. 166

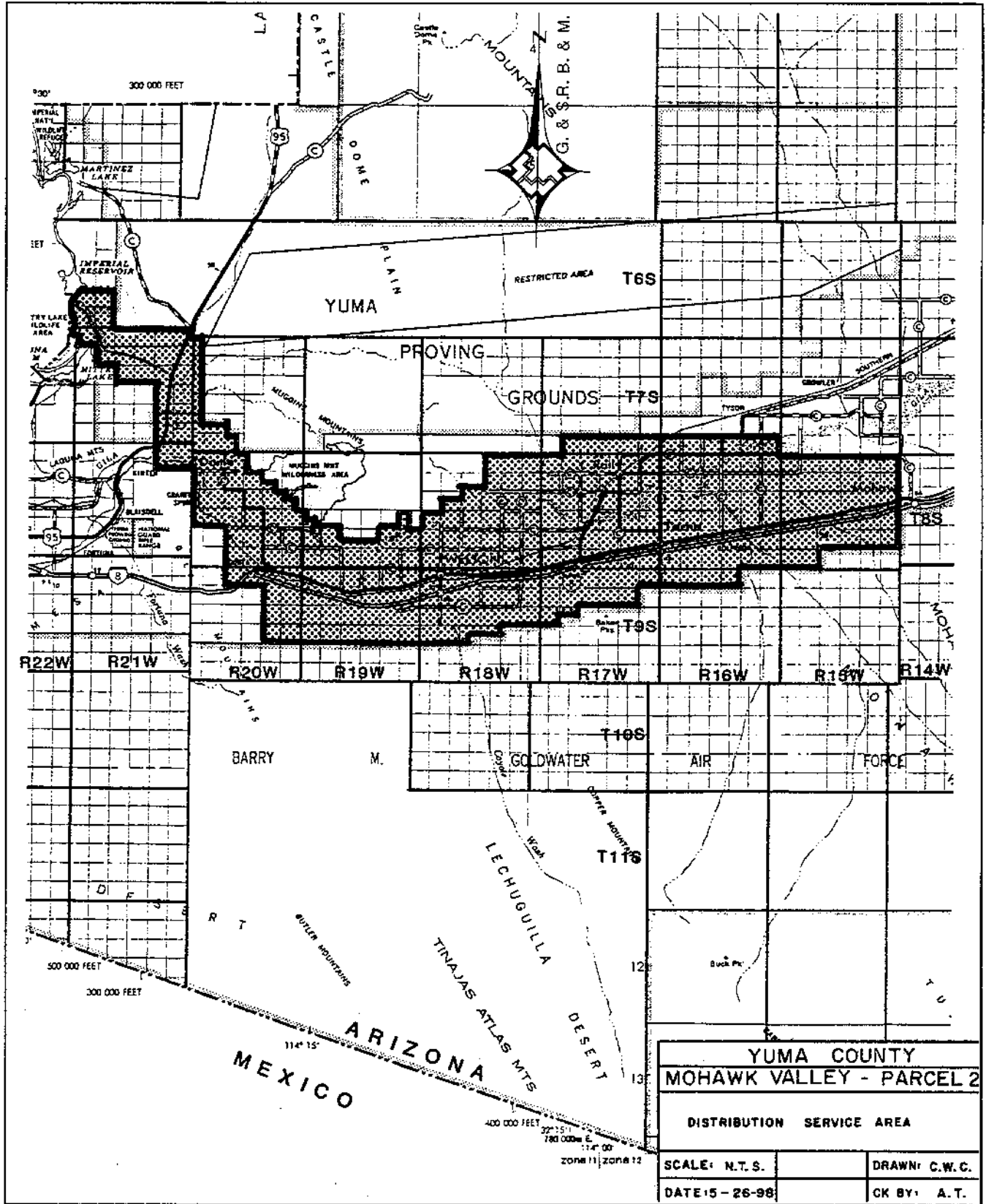

Issued On May 29, 1998 Issued by Edward S. Zub Effective June 3, 1998  
 Docket No. U-1551-87-098 Senior Vice President Decision No. 56074

SOUTHWEST GAS CORPORATION

P.O. Box 98510

Las Vegas, Nevada 89193-8510

Arizona Gas Tariff No. 7

Original A.C.C. Sheet No. 167

Canceling A.C.C. Sheet No.

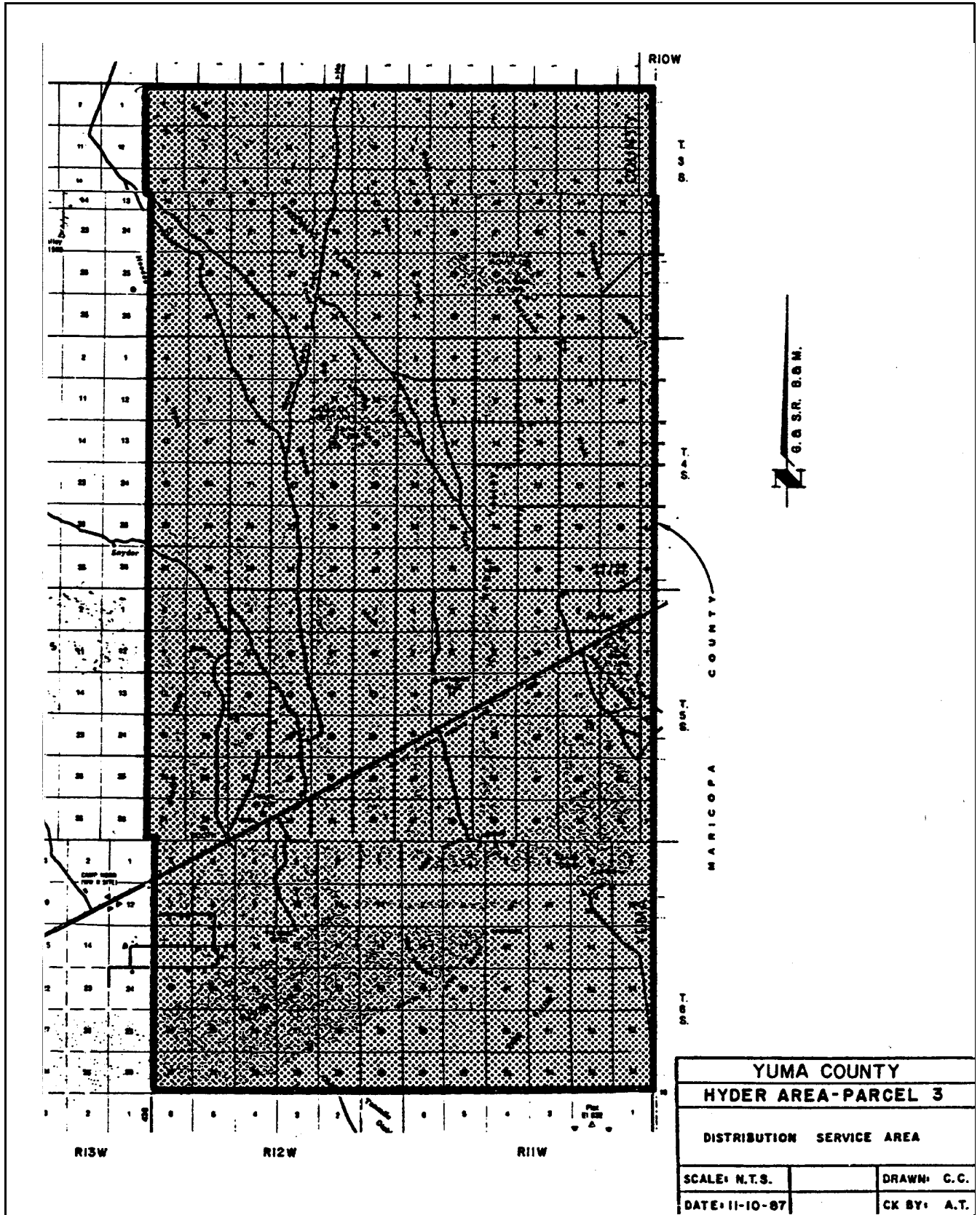

Issued On August 29, 1997  
Docket No. U-1551-96-596

Issued by Edward S. Zub  
Senior Vice President

Effective September 1, 1997  
Decision No. 60352

RULE NO. 2

CERTIFICATED GAS SERVICE AREA

The service area of Southwest Gas Corporation in or near Yuma, County of Yuma, State of Arizona, Gila and Salt River Baseline and Meridian and County of San Bernardino, State of California, San Bernardino Baseline and Meridian, includes the following described area:

PARCEL 1

1. Township 8 South, Range 21 West, All of Sections 3, 4, 8, 9, 16, 17, 20, 21, 30 and 31, All that portion of Sections 29 and 32 west and Section 33 south of the Yuma Proving Grounds.
2. Township 8 South, Range 22 West, All of Sections 25, 26, 27, 28, 29, 30, 31, 32, 33, 34, 35 and 36, All of the southwest quarter (SW 1/4) of Section 19.
3. Township 8 South, Range 23 West, All of Sections 25,26,27,28,29,30,31,32,33,34,35 and 36, All that portion of Sections 19, 20, 21, 22, 23 and 24 south of the Arizona/California Boundary Line.
4. Township 8 South, Range 24 West, All of Sections 25, 26, 27, 34, 35 and 36, All that portion of Sections 22, 23, 24, 28, 32 and 33 east and south of the Arizona/California Boundary Line.
5. Township 9 South, Range 21 West, All of Sections 2, 3, 4, 5, 6, 7, 8, 9, 10, 11, 13, 14, 15, 16, 17, 18, 19, 20, 21, 22, 23 and 24.
6. Township 9 South, Range 22 West, All of Sections 1, 2, 3, 4, 5, 6, 7, 8, 9, 10, 11, 12, 13, 14, 15, 16, 17, 18, 19, 20, 21, 22, 23, 24, 30 and 31.
7. Township 9 South, Range 23 West.
8. Township 9 South, Range 24 West, All of Sections 1, 2, 3, 4, 9, 10, 11, 12, 13, 14, 15, 16, 17, 20, 21, 22, 23, 24, 25, 26, 27, 28, 29, 30, 31, 32, 33, 34, 35 and 36, All that portion of Sections 5, 7, 8, 18 and 19 east of the Arizona/California Boundary Line.
9. Township 9 South, Range 25 West, All of Section 36, All that portion of Sections 24, 25, 26, 27, 34 and 35 east of the Arizona/California Boundary Line.



SOUTHWEST GAS CORPORATION

P.O. Box 98510

Las Vegas, Nevada 89193-8510

Arizona Gas Tariff No. 7

Arizona Division

Canceling First Revised A.C.C. Sheet No. 169  
Original A.C.C. Sheet No. 169

RULE NO. 2

CERTIFICATED GAS SERVICE AREA

*(Continued)*

10. Township 10 South, Range 22 West, the west half (W 1/2) of Section 6.
11. Township 10 South, Range 23 West.
12. Township 10 South, Range 24 West.
13. Township 10 South, Range 25 West, All of Sections 1, 12, 13, 24, 25 and 36, All that portion of Sections 2, 10, 11, 14, 23, 26, 27, 34 and 35 east of the Arizona/California Boundary Line/centerline of the Colorado River.
14. Township 11 South, Range 23 West, All of Sections 1, 2, 3, 4, 5, 6, 7, 8, 9, 10, 11, 12, 13, 14, 15, 16, 17, 18, 19, 20, 21, 22, 23, 24, 25, 26, 27, All that portion of Sections 28, 29, 30, 33, 34, 35 and 36 north of the U.S./Mexico Boundary Line.
15. Township 11 South, Range 24 West, All of Sections 1, 2, 3, 4, 5, 6, 8, 9, 10, 11, 12, 13, 14, All that portion of Sections 7, 15, 16, 17, 18, 22, 23 and 24 north of the U.S./Mexico Boundary Line.
16. Township 11 South, Range 25 West, All of Sections 1 and 2, All that portion of Section 3 and 10 east of the Arizona/California Boundary Line, All that portion of Sections 10, 11 and 12 north of the U.S./Mexico Boundary Line.
17. Township 12 South, Range 23 West, All that portion of Section 1 north of the U.S./Mexico Boundary Line.
18. Township 16 South, Range 21 East, S.B.B.M., All that portion of Sections 24, 25, 35 and 36 south of the Arizona/California Boundary Line.
19. Township 16 South, Range 22 East, S.B.B.M., All that portion of Sections 19, 25, 26, 27, 28, 29, 30, 31, 32, 33, 34, 35 and 36 south of the Arizona/California Boundary Line.
20. Township 16 South, Range 23 East, S.B.B.M., All that portion of Sections 29, 30 and 31 north of the Arizona/California Boundary Line.

Issued On May 29, 1998  
Docket No. U-1551-87-098

Issued by  
Edward S. Zub  
Senior Vice President

Effective June 3, 1998  
Decision No. 56074

RULE NO. 2

CERTIFICATED GAS SERVICE AREA

*(Continued)*

PARCEL 2

1. Township 6 South, Range 21 West, All of Sections 25 and 36, All that portion of Sections 26 and 35 east of the meander shore line of Mittry Lake.
2. Township 7 South, Range 16 West, All of Sections 31, 32, 33, 34, 35 and 36.
3. Township 7 South, Range 17 West, All of Sections 32, 33, 34, 35 and 36.
4. Township 7 South, Range 20 West, All of Sections 6, 7, 18, 19, 30, 31 and 32, the south half (S 1/2) of Section 29, and the west half (W 1/2) of Section 33.
5. Township 7 South, Range 21 West, All of Sections 1, 2, 3, 4, 5, 8, 9, 10, 11, 12, 13, 14, 15, 16, 23, 24, 25, 26, 35 and 36, All that portion of Section 6 east of the meander shore line of Mittry Lake.
6. Township 8 South, Range 15 West, All of Sections 1, 2, 3, 4, 5, 6, 7, 8, 9, 10, 11, 12, 13, 14, 15, 16, 17, 18, 19, 20, 21, 22, 23, 24, 25, 26, 27, 28, 29, 30, 31 and 32.
7. Township 8 South, Range 16 West.
8. Township 8 South, Range 17 West.
9. Township 8 South, Range 18 West, All of Sections 1, 2, 3, 10, 11, 12, 13, 14, 15, 16, 19, 20, 21, 22, 23, 24, 25, 26, 27, 28, 29, 30, 31, 32, 33, 34, 35 and 36, and the south half (S 1/2) of Section 17.
10. Township 8 South, Range 19 West, All of Sections 25, 26, 29, 30, 31, 32, 33, 34, 35 and 36, the southwest quarter (SW 1/4) of Section 19, the west half (W 1/2) of Section 24, and the south half (S 1/2) of Sections 27 and 28.
11. Township 8 South, Range 20 West, All of Sections 4, 5, 6, 7, 8, 9, 10, 14, 15, 16, 17, 18, 19, 20, 21, 22, 23, 24, 25, 26, 27, 28, 33, 34, 35 and 36, the south half (S 1/2) of Section 3, and the southwest quarter (SW 1/4) of Sections 11 and 13.

SOUTHWEST GAS CORPORATION

P.O. Box 98510

Las Vegas, Nevada 89193-8510

Arizona Gas Tariff No. 7

Arizona Division

Canceling                      First Revised A.C.C. Sheet No. 171  
                     Original A.C.C. Sheet No. 171

RULE NO. 2

CERTIFICATED GAS SERVICE AREA

*(Continued)*

12. Township 8 South, Range 21 West, All of Sections 1 and 2.
13. Township 9 South, Range 16 West, All of Sections 3, 4, 5 and 6.
14. Township 9 South, Range 17 West, All of Sections 1, 2, 3, 4, 5, 6, 7, 8, 9, 10, 11 and 18, and the north half (N 1/2) of Section 17.
15. Township 9 South, Range 18 West, All of Sections 1, 2, 3, 4, 5, 6, 7, 8, 9, 10, 11, 12, 13, 14, 15, 16, 17, 18, 19 and 20, the north half (N 1/2) and the southwest quarter (SW 1/4) of Section 21, and the north half (N 1/2) of Section 22.
16. Township 9 South, Range 19 West, All of Sections 1, 2, 3, 4, 5, 6, 7, 8, 9, 10, 11, 12, 13, 14, 15, 16, 17, 18, 19, 20, 21, 22, 23 and 24.
17. Township 9 South, Range 20 West, All of Sections 1, 2, 3, 4, 11, 12, 13, 14, 23 and 24.

PARCEL 3

1. Township 3 South, Range 10 West, All that portion lying within Yuma County.
2. Township 3 South, Ranges 11 and 12 West.
3. Township 4 South, Range 10 West, All that portion lying within Yuma County.
4. Township 4 South, Ranges 11 and 12 West.
5. Township 5 South, Range 10 West, All that portion lying within Yuma County.
6. Township 5 South, Ranges 11 and 12 West.
7. Township 6 South, Range 10 West, All that portion lying within Yuma County.
8. Township 6 South, Ranges 11 and 12 West.

Issued On May 29, 1998  
Docket No. U-1551-87-098

Issued by  
Edward S. Zub  
Senior Vice President

Effective June 3, 1998  
Decision No. 56074

**RULE NO. 2**

**CERTIFICATED GAS SERVICE AREA**

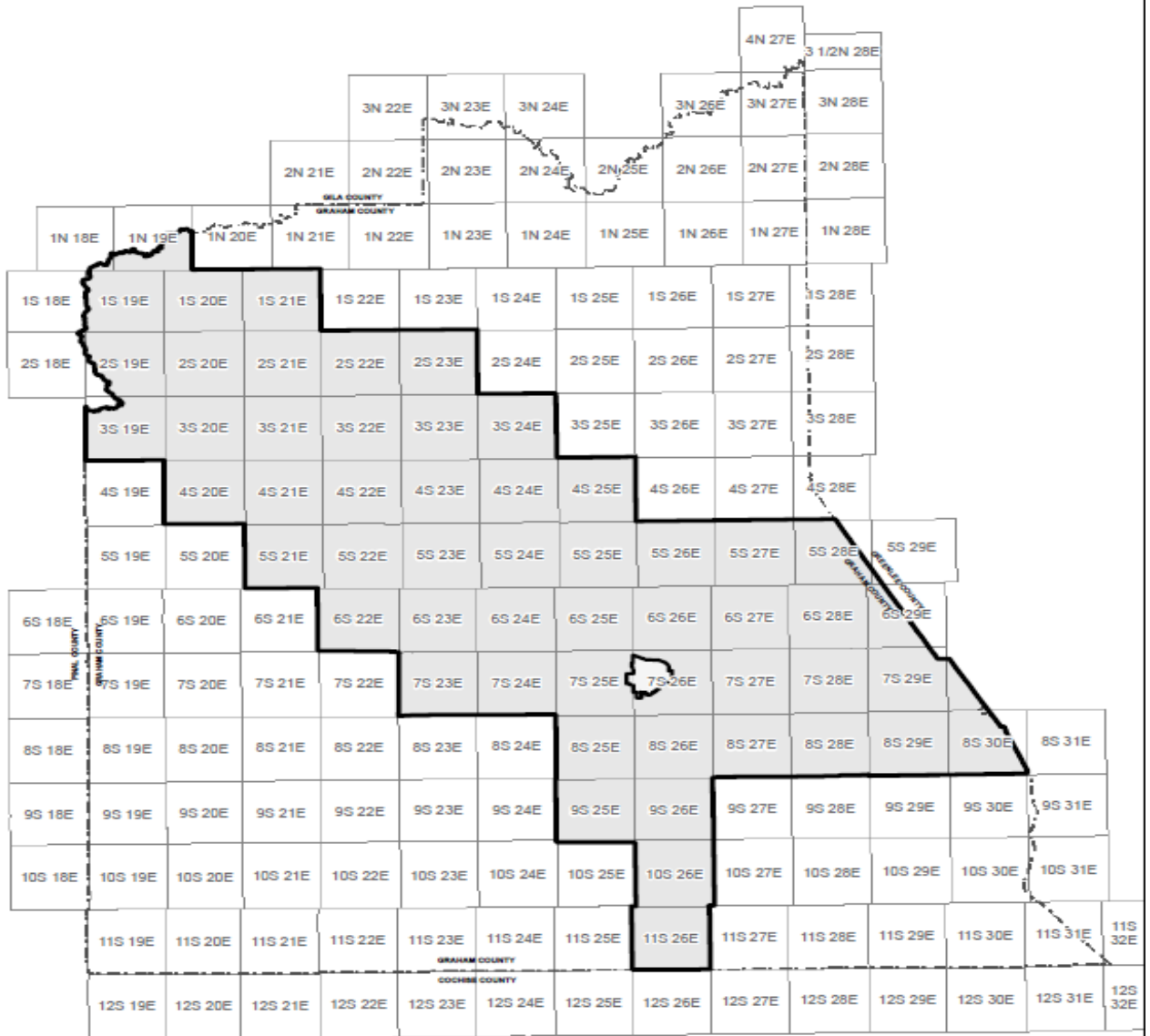

**GRAHAM COUNTY DISTRIBUTION  
SERVICE AREA**



0 5 10 20 Miles



RULE NO. 2

CERTIFICATED GAS SERVICE AREA  
(Continued)

18. Township 3 South, Range 24 East.
19. Township 4 South, Range 20 East.
20. Township 4 South, Range 21 East.
21. Township 4 South, Range 22 East.
22. Township 4 South, Range 23 East.
23. Township 4 South, Range 24 East.
24. Township 4 South, Range 25 East.
25. Township 5 South, Range 21 East.
26. Township 5 South, Range 22 East.
27. Township 5 South, Range 23 East.
28. Township 5 South, Range 24 East.
29. Township 5 South, Range 25 East.
30. Township 5 South, Range 26 East.
31. Township 5 South, Range 27 East.
32. Township 5 South, Range 28 East, All that portion lying within Graham County.
33. Township 6 South, Range 22 East.
34. Township 6 South, Range 23 East.
35. Township 6 South, Range 24 East.

RULE NO. 2

CERTIFICATED GAS SERVICE AREA  
(Continued)

36. Township 6 South, Range 25 East.
37. Township 6 South, Range 26 East.
38. Township 6 South, Range 27 East.
39. Township 6 South, Range 28 East.
40. Township 6 South, Range 29 East, All that portion lying within Graham County.
41. Township 7 South, Range 23 East.
42. Township 7 South, Range 24 East.
43. Township 7 South, Range 25 East, Except the City limits of Safford.
44. Township 7 South, Range 26 East, Except the City limits of Safford.
45. Township 7 South, Range 27 East.
46. Township 7 South, Range 28 East.
47. Township 7 South, Range 29 East, All that portion lying within Graham County.
48. Township 7 South, Range 30 East, All that portion lying within Graham County.
49. Township 8 South, Range 25 East.
50. Township 8 South, Range 26 East.
51. Township 8 South, Range 27 East.
52. Township 8 South, Range 28 East.
53. Township 8 South, Range 29 East.





SOUTHWEST GAS CORPORATION  
P.O. Box 98510  
Las Vegas, Nevada 89193-8510  
Arizona Gas Tariff No. 7  
Arizona Division

Canceling \_\_\_\_\_ 1st Revised \_\_\_\_\_ A.C.C. Sheet No. 177-181 T  
Original \_\_\_\_\_ A.C.C. Sheet No. \_\_\_\_\_

RULE NO. 2

CERTIFICATED GAS SERVICE AREA  
(Continued)

HELD FOR FUTURE USE

Issued On January 25, 2022  
Docket No. G-00000C-98-0568

Issued by  
Amy L. Timperley  
Vice President

Effective February 1, 2022  
Decision No. 62994