

DESCRIPTION OF SERVICE AREA

A. The service area of Southwest Gas Corporation within the County of San Bernardino, State of California, San Bernardino Baseline and Meridian, includes the following described area:

1. Township 11 North, Range 5 West, All of Sections 1, 2, 3, 10, 11, 12, 13, 14, 15, 22, 23, 24, 25, 26, 27, 34, 35, and 36.
2. Township 11 North, Range 4 West, All of Sections 4, 5, 6, 7, 8, 9, 16, 17, 18, 19, 20, 21, 28, 29, 30, 31, 32, and 33.
3. Township 10 North, Range 5 West, All of Sections 1, 2, 3, 10, 11, 12, 13, 14, 15, 22, 23, 24, 25, 26, 27, 34, 35, and 36.
4. Township 10 North, Ranges 4, 3, 2, and 1 West and Ranges 1 and 2 East.
5. Township 9 North, Range 5 West, All of Sections 1, 2, 3, 10, 11, 12, 13, 14, 15, 22, 23, 24, 25, 26, 27, 34, 35, and 36.
6. Township 9 North, Ranges 4, 3, 2, and 1 West and Ranges 1 and 2 East.
7. Township 8 North, Range 5 West, All of Sections 1, 2, 3, 10, 11, 12, 13, 14, 15, 22, 23, 24, 25, 26, 27, 34, 35, and 36.
8. Township 8 North, Ranges 4, 3, 2, and 1 West and Ranges 1 and 2 East.
9. Township 7 North, Range 5 West, All of Sections 1, 2, 3, 10, 11, 12, 13, 14, 15, 22, 23, 24, 25, 26, 27, 34, 35, and 36.
10. Township 7 North, Ranges 4, 3, 2, and 1 West and Ranges 1 and 2 East.
11. Township 6 North, Ranges 5, 4, 3, 2, and 1 West and Ranges 1 and 2 East.
12. Township 5 North, Range 5 West, All of that portion lying east of the existing Southern California Gas Company Transmission Pipeline No. 1185, and south of the southerly property line and east of the easterly property line, of the Southern California Gas Property known as the Adelanto Compressor Station in Section 6.
13. Township 5 North, Ranges 4, 3, 2, and 1 West and Ranges 1 and 2 East.
14. Township 4 North, Range 5 West, All of that portion lying east of the existing Southern California Gas Company Transmission Pipeline No. 1185.
15. Township 4 North, Ranges 4, 3, 2, and 1 West and Ranges 1 and 2 East.
16. Township 3 North, Range 6 West, All of that portion lying southerly, easterly and northerly of the centerline improvement line of Interstate Route 15 as shown on State of California, Transportation Agency, Department of Public Works, Division of Highways, Right-of-Way Map.

DESCRIPTION OF SERVICE AREA
(Continued)

17. Township 3 North, Range 5 West, All of that portion lying east of the existing Southern California Gas Company Transmission Pipeline No. 1185, and southerly of the centerline improvement line of Interstate Route 15 as shown on State of California, Transportation Agency, Department of Public Works, Division of Highways, Right-of-Way Map.
 18. Township 3 North, Ranges 4, 3, 2, and 1 West and Ranges 1 and 2 East.
 19. Township 2 North, Range 1 West and Ranges 1 and 2 East.
- B. The aforesaid Southern California service area of Southwest Gas Corporation is more particularly described as follows:

BEGINNING at the northwest corner of Section 3, Township 11 North, Range 5 West; thence easterly along the north line of Sections 3, 2, and 1, to the northeast corner of said Section 1, said Township and Range; thence continuing easterly along the north line of Sections 6, 5, and 4, Township 11 North, Range 4 West, to the northeast corner of said Section 4, said Township and Range; thence southerly along the east line of Sections 4, 9, 16, 21, 28, and 33, Township 11 North, Range 4 West, to the southeast corner of said Section 33, said Township and Range; thence easterly along the north line of Sections 3, 2, and 1, Township 10 North, Range 4 West, to the northeast corner of said Section 1, said Township and Range; thence continuing easterly along the north line of Township 10 North, Ranges 3, 2, and 1 West, and Ranges 1 and 2 East, to the northeast corner of said Township 10 North, Range 2 East; thence southerly along the east line of Townships 10, 9, 8, 7, 6, 5, 4, 3, and 2 North, Range 2 East, to the southeast corner of said Township 3 North, Range 2 East; thence westerly along the south line of Township 2 North, Ranges 1 and 2 East and Range 1 West, to the southwest corner of said Township 2 North, Range 1 West; thence northerly along the west line of said Township 2 North, Range 1 West, to the northwest corner of said Township and Range; thence westerly along westerly the south line of Township 3 North, Ranges 2, 3, 4, and 5 West, to the southwest corner of Township 3 North, Range 5 West; thence continuing westerly along the south line of Township 3 North, Range 6 West, to the intersection with the centerline improvement line of Interstate Route 15 as shown on State of California, Transportation Agency, Department of Public Works, Division of Highways, Right-of-Way Map; thence northwesterly, northerly, and northeasterly along said centerline improvement line of said Interstate Route 15, to its intersection with that certain line labeled "LL E. RD. BD." as shown on State of California, Transportation Agency, Department of Public Works, Division of Highways, Right-of-Way Number 909031 of said Township 3 North, Range 6 West; thence northeasterly along said "LL E. RD. BD." line to its intersection with the east edge of the existing Southern California Gas Company Transmission Pipeline No. 1185, being within Township 3

DESCRIPTION OF SERVICE AREA
(Continued)

North, Range 5 West; thence northerly along the east edge of said Southern California Gas Company Transmission Pipeline No. 1185, through its varying course within Townships 4 and 5 North, Range 5 West, to its intersection with the south line of the Southern California Gas Company Property, known as Adelanto Compressor Station in Section 6, Township 5 North, Range 5 West; thence easterly along the south line, to the southeast corner of said Property; thence northerly along the east line, to the north line of Township 5 North, Range 5 West; thence westerly along the south line of Township 6 North, Range 5 West, to the southwest corner of said Township and Range; thence northerly along the west line of Township 6 North, Range 5 West, to the northwest corner of said Township and Range; thence easterly along the north line of Sections 6, 5, and 4, said Township and Range, to the northeast corner of said Section 4, said Township and Range; thence northerly along the centerline of Townships 7, 8, 9, 10, and 11 North, Range 5 West, to the northwest corner of Section 3, Township 11 North, Range 5 West, to the POINT OF BEGINNING.

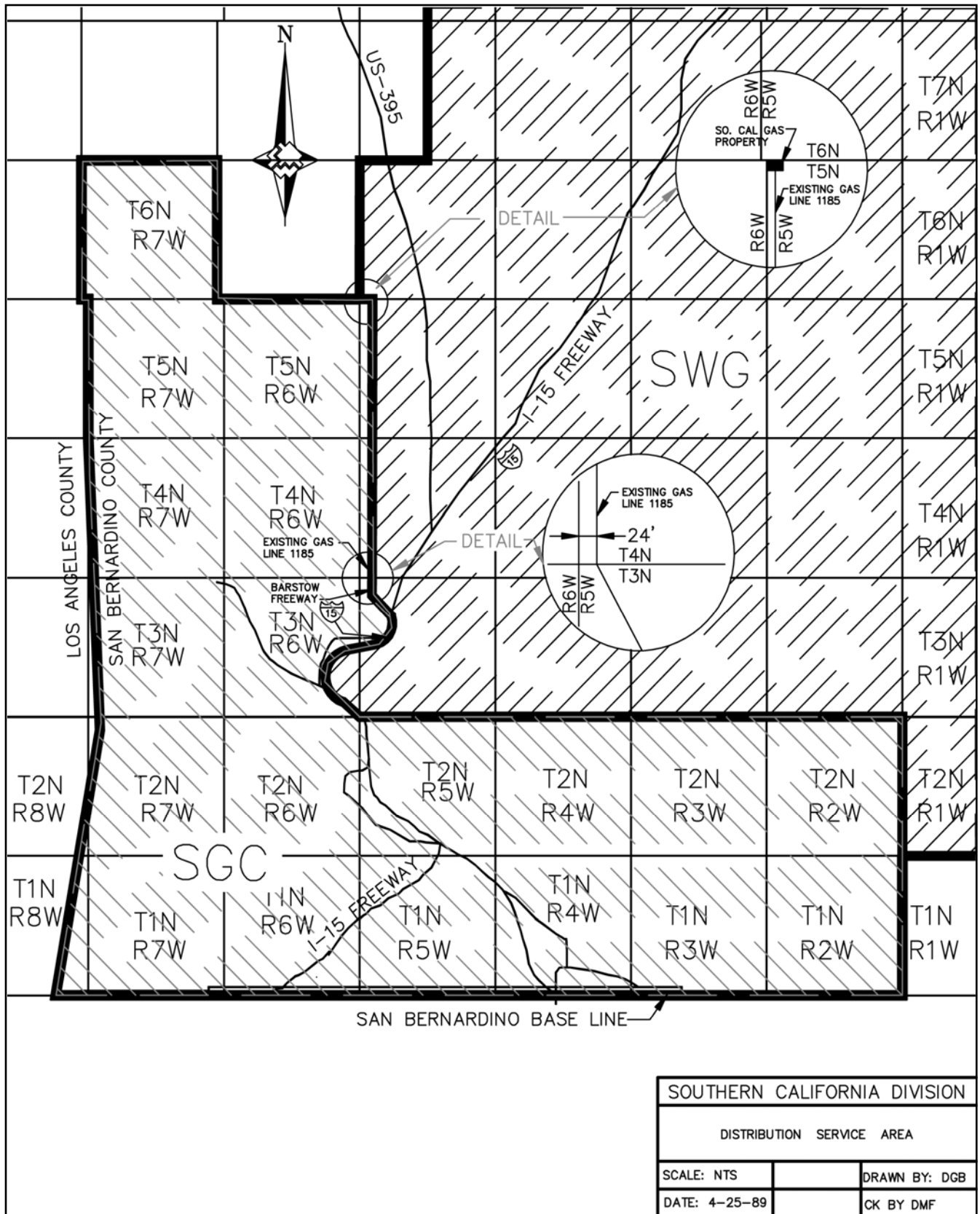

SOUTHERN CALIFORNIA DIVISION	
DISTRIBUTION SERVICE AREA	
SCALE: NTS	DRAWN BY: DGB
DATE: 4-25-89	CK BY DMF

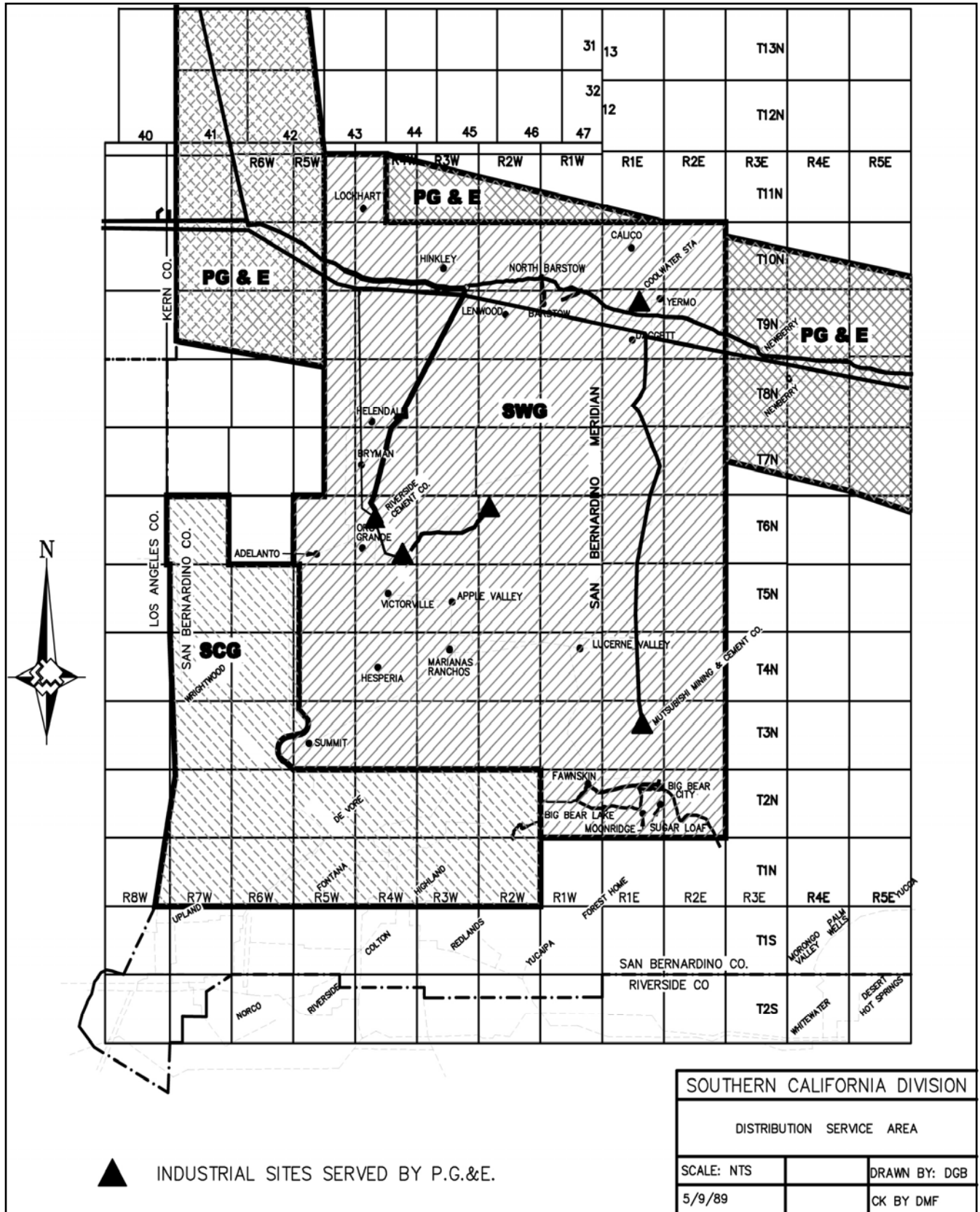

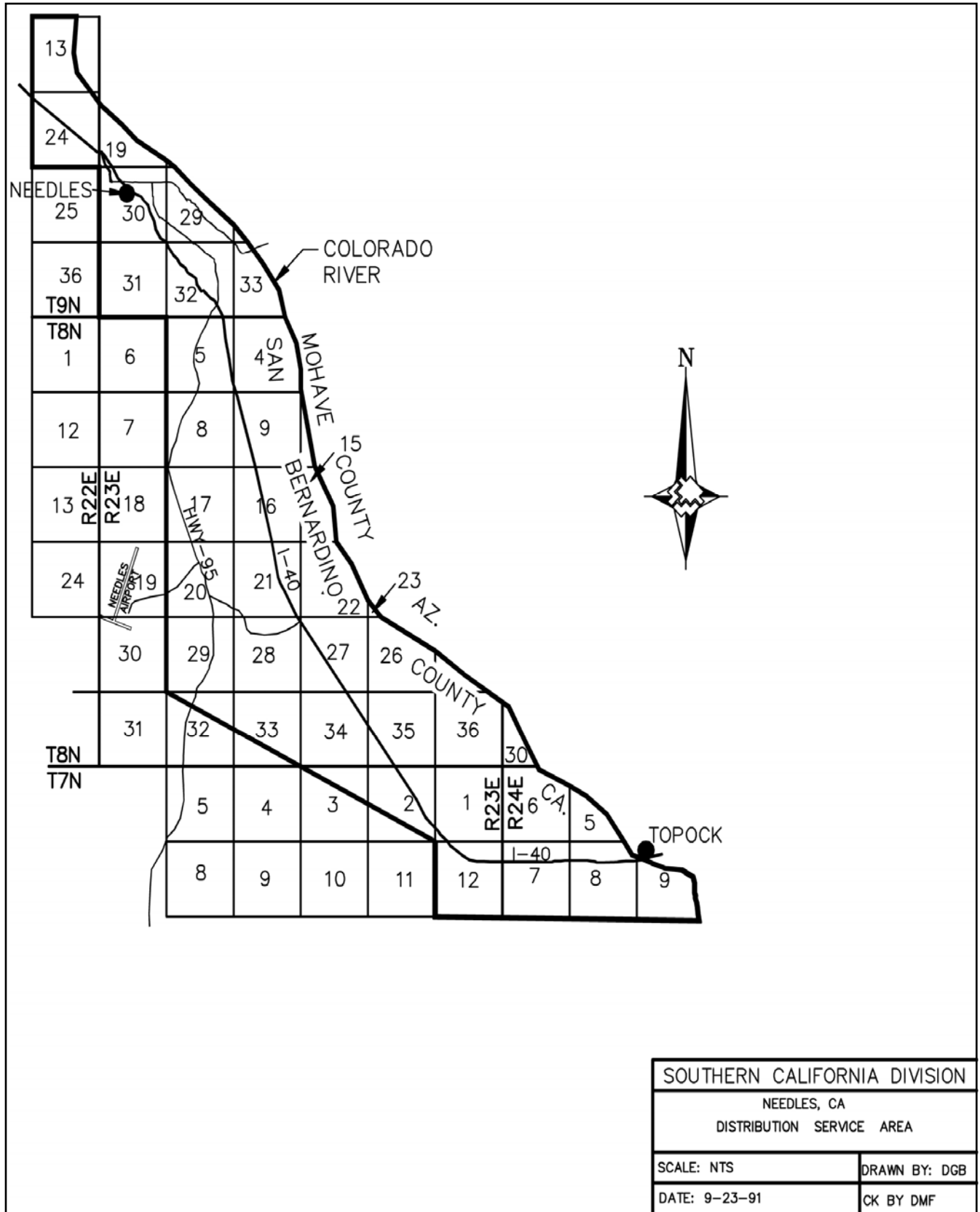

DESCRIPTION OF SERVICE AREA
NEEDLES, CALIFORNIA

- A. The service area of Southwest Gas Corporation within the County of San Bernardino, State of California, San Bernardino Baseline and Meridian, includes the following described area:
1. Township 7 North, Range 23 East, All of Sections 1 and 12; all of that portion of Sections 2 and 3 lying northerly of the prolongation of a line from the southeast corner of Section 2, to the northwest corner of Section 32, Township 8 North, Range 23 East.
 2. Township 7 North, Range 24 East, All of Section 7; all of that portion of Sections 5, 6, 8 and 9 lying west of the California/Arizona state boundary.
 3. Township 8 North, Range 23 East, All of Sections 5, 8, 16, 17, 20, 21, 27, 28, 29, 34 and 35; all of that portion of Sections 4, 9, 10, 11, 12, 13, 14, 15, 22, 23, 24, 25, 26 and 36 lying west of the California/Arizona state boundary; all of that portion of Sections 32, 33 and 34 lying northerly of the prolongation of a line from the southeast corner of Section 2, Township 7 North, Range 23 East, to the northwest corner of said Section 32.
 4. Township 8 North, Range 24 East, All of that portion of Section 31 lying west of the California/Arizona state boundary.
 5. Township 9 North, Range 23 East, All of Sections 30, 31 and 32; all of that portion of Sections 19, 20, 28, 29 and 33 lying west of the California/Arizona state boundary.
 6. Township 9 North, Range 22 East, All of Section 24; all of that portion of Section 13 lying west of the California/Arizona state boundary.

DESCRIPTION OF SERVICE AREA
NEEDLES, CALIFORNIA
(Continued)

- B. The aforesaid Southern California service area of Southwest Gas Corporation is more particularly described as follows:

BEGINNING at the southeast corner of Section 31, Township 9 North, Range 23 East; thence westerly along the south line of said Section 31, to the southwest corner thereof; thence northerly along the west line of Sections 30 and 31, to the northwest corner of said Section 30; thence westerly along the south line of Section 24, Township 9 North, Range 22 East, S.B.B. & M, to the southwest corner thereof; thence northerly along the west line of Sections 13 and 24, said Township and Range, to the northwest corner of said Section 13; thence easterly along the north line of said Section 13, to the California/Arizona state boundary; thence southeasterly along the California/Arizona state boundary to the south line of Section 9, Township 7 North, Range 24 East; thence westerly along the south line of Sections 7, 8 and 9 of Township 7 North, Range 24 West and Section 12, Township 7 North, Range 23 East, to the southwest corner of said Section 12; thence northerly along the west line of said Section 12, to the northwest corner thereof; thence northwesterly through Sections 2 and 3 of Township 7 North, Range 23 East, and Sections 32, 33 and 34, Township 8 North, Range 23 East, to the northwest corner of said Section 32; thence northerly along the west line of Sections 5, 8, 17, 20 and 29, to the southeast corner of Section 31, Township 9 North, Range 23 East; said southeast corner, also being the POINT OF BEGINNING.

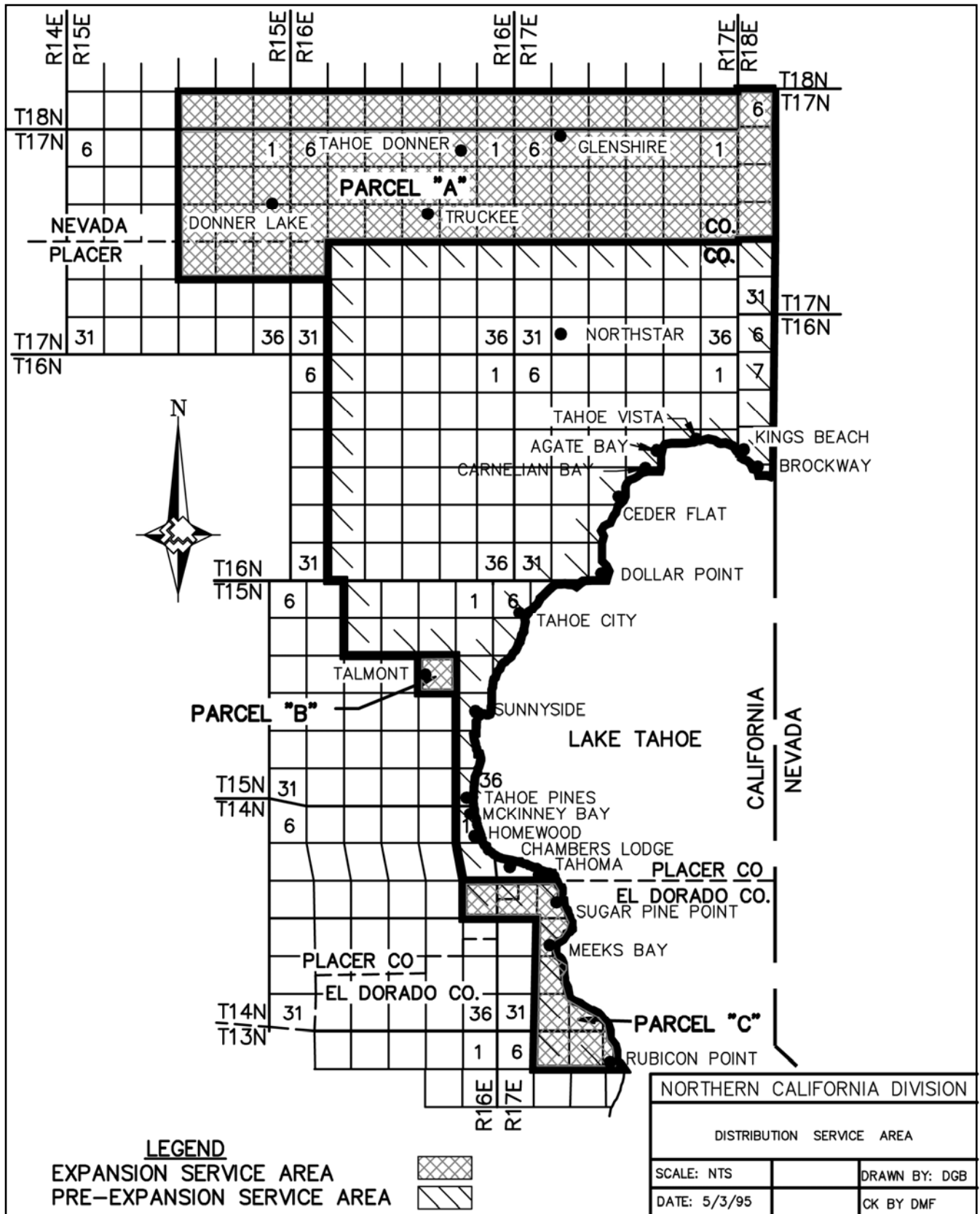

DESCRIPTION OF EXPANSION SERVICE AREA

- A. The expansion service area of Southwest Gas Corporation in or near Truckee, Counties of Nevada and Placer (Parcel "A"); Talmont, County of Placer (Parcel "B"); and El Dorado, Counties of El Dorado and Placer (Parcel "C"), State of California, Mount Diablo Baseline and Meridian, includes the following described area:

PARCEL "A":

1. Township 18 North, Range 15 East, All of Sections 34, 35 and 36.
2. Township 18 North, Range 16 East, All of Sections 31, 32, 33, 34, 35 and 36.
3. Township 18 North, Range 17 East, All of Sections 31, 32, 33, 34, 35 and 36.
4. Township 17 North, Range 15 East, All of Sections 1, 2, 3, 10, 11, 12, 13, 14, 15, 22, 23 and 24.
5. Township 17 North, Range 16 East, All of Sections 1, 2, 3, 4, 5, 6, 7, 8, 9, 10, 11, 12, 13, 14, 15, 16, 17 and 18.
6. Township 17 North, Range 17 East, All of Sections 1, 2, 3, 4, 5, 6, 7, 8, 9, 10, 11, 12, 13, 14, 15, 16, 17 and 18.
7. Township 17 North, Range 18 East, All that portion of Sections 6, 7, 18 and 19 west of the California/Nevada State Boundary Line.

PARCEL "B":

1. Township 15 North, Range 16 East, All of Section 14.

PARCEL "C":

1. Township 14 North, Range 16 East, All of Section 13.
2. Township 14 North, Range 17 East, All of Section 18; All that portion of Sections 16, 17, 20, 21, 28, 29, 32 and 33, west of the Lake Tahoe Shore Line.
3. Township 13 North, Range 17 East, All of Section 5; All that portion of Sections 3 and 4, west of the Lake Tahoe Shore Line.

DESCRIPTION OF EXPANSION SERVICE AREA
(Continued)

- B. The aforesaid Truckee (Parcel "A"); Talmont (Parcel "B"); and El Dorado (Parcel "C"), California, expansion service area of Southwest Gas Corporation is more particularly described area:

PARCEL "A":

BEGINNING at the northwest (NW) corner of Section 34, Township 18 North, Range 15 East, M.D.B.& M., Nevada County, California; thence easterly along the north line of Sections 34, 35 and 36, to the northeast (NE) corner of said Section 36; thence continuing easterly along the north line of Sections 31, 32, 33, 34, 35 and 36, Township 18 North, Range 16 East, M.D.B.& M., to the northeast (NE) corner of Section 36, said township and range; thence continuing easterly along the north line of Sections 31, 32, 33, 34, 35 and 36, Township 18 North, Range 17 East, M.D.B.& M., to the northeast (NE) corner of Section 36, said township and range; thence continuing easterly along the north line of Section 6, Township 17 North, Range 18 East, M.D.B.& M., to a point on the California/Nevada State Boundary Line; thence southerly along the California/Nevada State Boundary Line through Sections 6, 7, 18 and 19, said township and range, to the southeast (SE) corner of Section 19, on the Nevada/Placer County Line; thence westerly along the Nevada/Placer County Line to the southwest (SW) corner of Section 19, said township and range; thence continuing westerly along the south line of Sections 13, 14, 15, 16, 17 and 18, Township 17 North, Range 17 East, to the southwest (SW) corner of Section 18, said township and range; thence continuing westerly along the south line of Sections 13, 14, 15, 16 and 17, Township 17 North, Range 16 East, M.D.B.& M., to the southwest (SW) corner of Section 17, said township and range; thence southerly along the east line of Section 19, to the southeast (SE) corner of said Section 19; thence westerly along the south line of Section 19 to the southwest (SW) corner of said Section 19; thence continuing westerly along the south line of Sections 24, 23 and 22, Township 17 North, Range 15 East, M.D.B.& M., to the southwest (SW) corner of said Section 22; thence northerly through the Placer/Nevada County line along the west line of Sections 22, 15, 10 and 3, said township and range, to the northwest (NW) corner of Section 3; thence continuing northerly along the west line of Section 34, Township 18 North, Range 15 East, M.D.B.& M., to the northwest (NW) corner of said Section 34, said corner being the POINT OF BEGINNING.

DESCRIPTION OF EXPANSION SERVICE AREA
(Continued)

PARCEL "B":

BEGINNING at the northwest (NW) corner of Section 14, Township 15 North, Range 16 East, M.D.B.& M., Placer County, California; thence easterly along the north line to the northeast (NE) corner of said Section 14; thence southerly along the east line to the southeast (SE) corner of said Section 14; thence westerly along the south line to the southwest (SW) corner of said Section 14; thence northerly along the west line to the northwest (NW) corner of said section, township and range, said corner being the POINT OF BEGINNING.

PARCEL "C":

BEGINNING at the northwest (NW) corner of Section 13, Township 14 North, Range 16 East, M.D.B.& M., Placer County, California; thence easterly along the north line of Section 13, to the northeast (NE) corner of Section 13, said township and range; thence continuing easterly along the north line of Sections 18 and 17 (along the El Dorado and Placer County Line-north line of Sections 18 and 17), Township 14 North, Range 17 East, M.D.B.& M., to a point in Section 17, said point being the Shore Line of Lake Tahoe; thence continuing in a southeasterly direction along the meandering Lake Tahoe Shore Line through Sections 16, 17, 20, 21, 28, 29, 32 and 33, to a point on the southerly line of Section 33, said township and range; thence continuing in a southeasterly direction along the meandering of the Lake Tahoe Shore Line in Sections 4 and 3, Township 13 North, Range 17 East, M.D.B.& M., to a point in Section 3, said point being the south line of Section 3; thence westerly along the south line of Sections 3, 4 and 5, to the southwest (SW) corner of said Section 5; thence northerly along the west line of Section 5, to the northwest (NW) corner of Section 5, said township and range; thence continuing northerly along the west line of Sections 32, 29 and 20, Township 14 North, Range 17 East, M.D.B.& M., to the northwest (NW) corner of said Section 20, said township and range; thence westerly along the south line of Section 18, said township and range, to the southwest (SW) corner of Section 18, said township and range; thence continuing westerly (through the El Dorado/Placer County Line - Sections 18 and 13) along the south line of Section 13, Township 14 North, Range 16 East, M.D.B.& M., to the southwest (SW) corner of Section 13, said township and range; thence northerly along the west line of Section 13, to the northwest (NW) corner of said Section 13, said township and range, said corner being the POINT OF BEGINNING.

DESCRIPTION OF PRE-EXPANSION SERVICE AREA

A. The pre-expansion service area of Southwest Gas Corporation within the County of Placer, State of California, Mount Diablo Baseline and Meridian, includes the following described area:

1. Township 17 North, Range 16 East, All of Sections 20, 21, 22, 23, 24, 25, 26, 27, 28, 29, 32, 33, 34, 35 and 36.
2. Township 17 North, Range 17 East, All of Sections 19, 20, 21, 22, 23, 24, 25, 26, 27, 28, 29, 30, 31, 32, 33, 34, 35 and 36.
3. Township 17 North, Range 18 East, All that portion of Sections 30 and 31 west of the California/Nevada State Boundary Line.
4. Township 16 North, Range 16 East, All of Sections 1, 2, 3, 4, 5, 8, 9, 10, 11, 12, 13, 14, 15, 16, 17, 20, 21, 22, 23, 24, 25, 26, 27, 28, 29, 32, 33, 34, 35 and 36.
5. Township 16 North, Range 17 East, All of Sections 1, 2, 3, 4, 5, 6, 7, 8, 9, 10, 11, 12, 16, 17, 18, 19, 20, 29, 30, 31 and 32; All that portion of Sections 13, 14, 15, 21, 22, 28 and 33 north and west of the Lake Tahoe Shore Line.
6. Township 16 North, Range 18 East, All that portion of Sections 6, 7, 18, 19 and 30 west of the California/Nevada State Boundary Line; All that portion of Sections 19 and 30 east of the Lake Tahoe Shore Line.
7. Township 15 North, Range 16 East, All of Sections 1, 2, 3, 4, 9, 10, 11, 12 and 13; All that portion of Sections 24, 25 and 36 west of the Lake Tahoe Shore Line.
8. Township 15 North, Range 17 East, All that portion of Sections 4, 5, 6, 7, 18 and 19 west of the Lake Tahoe Shore Line.
9. Township 14 North, Range 16 East, All that portion of Sections 1 and 12 west of the Lake Tahoe Shore Line.
10. Township 14 North, Range 17 East, All that portion of Sections 7 and 8 south of the Lake Tahoe Shore Line.

DESCRIPTION OF PRE-EXPANSION SERVICE AREA
(Continued)

- B. The aforesaid Placer County, California, pre-expansion service area of Southwest Gas Corporation is more particularly described as follows:

BEGINNING at the northwest (NW) corner of Section 20, Township 17 North, Range 16 East, M.D.B.& M., Placer County, California; thence easterly along the north line of Sections 20, 21, 22, 23 and 24, to the northeast (NE) corner of said Section 24; thence continuing easterly along the north line of Sections 19, 20, 21, 22, 23 and 24, to the northeast (NE) corner of Section 24, Township 17 North, Range 17 East, M.D.B.& M.; thence continuing easterly along the north line of Section 30, Township 17 North, Range 18 East, M.D.B.& M., to a point on the California/Nevada State Boundary Line; thence southerly along the California/Nevada State Boundary Line through Sections 30 and 31, to the south line of said Section 31, said township and range; thence continuing southerly along the California/Nevada State Boundary Line through Sections 6, 7, 18, 19 and 30, Township 16 North, Range 18 East, M.D.B.& M., to a point, said point being the Shore Line of Lake Tahoe; thence in a northwesterly direction along the meandering Lake Tahoe Shore Line through Sections 30 and 19, to a point, said point being the west line of Section 19, said township and range; thence continuing in a southwesterly direction along the meandering Lake Tahoe Shore Line through Sections 13, 14, 15, 22, 21, 28 and 33, Township 16 North, Range 17 East, M.D.B.& M., to a point, said point being the south line of Section 33, said township and range; thence continuing in a southwesterly direction along the meandering Lake Tahoe Shore Line through Sections 4, 5, 6, 7, 18 and 19, Township 15 North, Range 17 East, M.D.B.& M., to a point, said point being the west line of Section 19, said township and range; thence continuing in a southerly direction along the meandering Lake Tahoe Shore Line through Sections 24, 25 and 36, Township 15 North, Range 16 East, M.D.B.& M., to a point, said point being the south line of Section 36, said township and range; thence continuing in a southeasterly direction along the meandering Lake Tahoe Shore Line through Sections 1 and 12, Township 14 North, Range 16 East, M.D.B.& M., to a point, said point being the east line of Section 12, said township and range; thence continuing in a southeasterly direction along the meandering Lake Tahoe Shore Line through Sections 7 and 8, Township 14 North, Range 17 East, M.D.B.& M., to a point, said point being the south line of Section 8, said township and range; thence westerly along the south line of Sections 8 and 7, to the southwest (SW) corner of Section 8, said township and range; thence continuing westerly along the south line of Section 12, Township 14 North, Range 16 East, M.D.B.& M., to the southwest (SW) corner of Section 12, said township and range;

DESCRIPTION OF PRE-EXPANSION SERVICE AREA
(Continued)

thence northerly along the west line of Sections 12 and 1, to the northwest (NW) corner of said Section 1, township and range; thence continuing northerly along the west line of Sections 36, 25, 24 and 13, to the northwest (NW) corner of said Section 13, Township 15 North, Range 16 East, M.D.B. & M.; thence westerly along the south line of Sections 11, 10 and 9, to the southwest (SW) corner of Section 9, said township and range; thence northerly along the west line of Sections 9 and 4, to the northwest (NW) corner of Section 4, said township and range; thence westerly along the south line of Section 32, to the southwest (SW) corner of Section 32, Township 16 North, Range 16 East, M.D.B. & M., thence northerly along the west line of Sections 32, 29, 20, 17, 8 and 5, to the northwest (NW) corner of Section 5, said township and range; thence continuing northerly along the west line of Sections 32, 29 and 20, to the northwest (NW) corner of Section 20, Township 17 North, Range 16 East, M.D.B. & M., said corner being the POINT OF BEGINNING.

SOUTHWEST GAS CORPORATION
 P.O. Box 98510
 Las Vegas, Nevada 89193-8510
 California Gas Tariff

Original _____ Cal. P.U.C. Sheet No. 62
 Canceling _____ Cal. P.U.C. Sheet No. _____

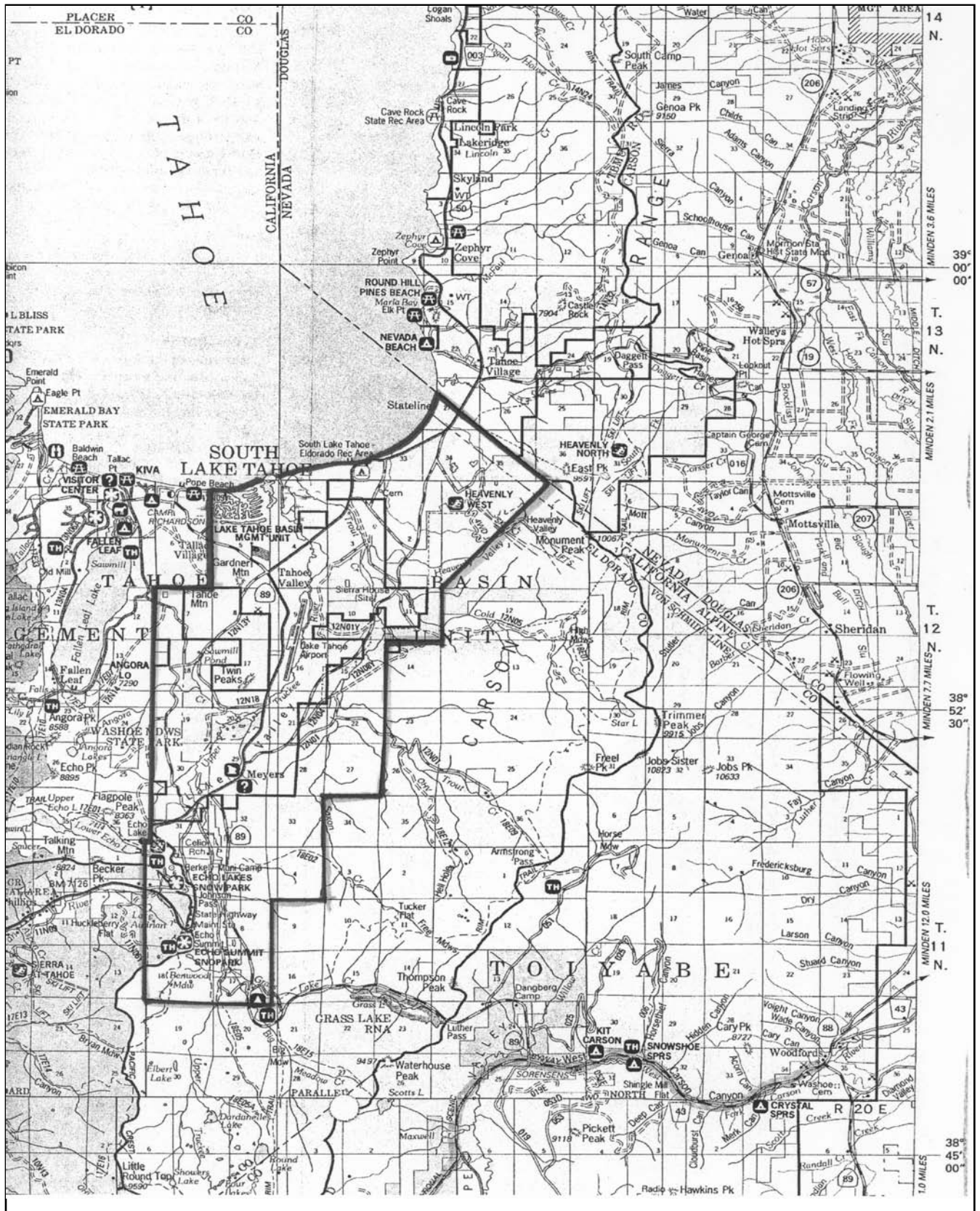

Advice Letter No. 864
 Decision No. _____

Issued by
 John P. Hester
 Senior Vice President

Date Filed March 23, 2011
 Effective April 24, 2011
 Resolution No. _____

DESCRIPTION OF SERVICE AREA

1. The expansion service area of Southwest Gas Corporation in or near South Lake Tahoe, County of El Dorado, State of California, Mount Diablo Baseline and Meridian, includes the following described area:
 - A. Township 13 North, Range 18 East, All of Section 34; All that portion of fractional Sections 28, 31, 32 and 33 southeast of the Lake Tahoe Shore Line; All that portion of Sections 26, 35 and 36 west of the California/Nevada State Boundary Line. All that portion of fractional Section 27 southeast of the Lake Tahoe Shore Line and west of the California/Nevada State Boundary Line.
 - B. Township 12 North, Range 18 East, All of Sections 2, 3, 4, 7, 8, 9, 10, 11, 15, 16, 17, 18, 19, 20, 21, 22, 27, 28, 29, 30, 31, 32 and 33; All that portion of fractional Section 5, south of the Lake Tahoe Shore Line; all that portion of Section 1 southwest of the California/ Nevada State Boundary Line and northwest of a line from the intersection of the California/Nevada State Boundary Line with the El Dorado/Alpine County Line and the southwest corner of said Section 1.
 - C. Township 11 North, Range 18 East, All of Sections 4, 5, 6, 7, 8, 17 and 18.

DESCRIPTION OF SERVICE AREA
(Continued)

2. The aforesaid South Lake Tahoe, California, expansion service area of Southwest Gas Corporation is more particularly described as follows:

BEGINNING at the intersection of the southeast Lake Tahoe Shore Line and the California/Nevada State Boundary Line in fractional Section 27, Township 13 North, Range 18 East, M.D.B. & M., El Dorado County, California; thence southeasterly along said State Boundary Line through said fractional Section 27, Sections 26, 35 and 36, said township and range, to a point on the north line of Section 1, Township 12 North, Range 18 East, M.D.B.& M.; thence continuing southeasterly along said State Boundary Line to a point on the El Dorado/Alpine County Line; thence southwesterly to the northeast corner of Section 11, said township and range; thence south along the east line of said Section 11 to the southeast corner of said Section 11; thence west along the south line of said Section 11 to the northeast corner of Section 15, said township and range; thence south along the east lines of Sections 15, 22 and 27, said township and range, to the southeast corner of said Section 27; thence west along the south line of said Section 27, to the northeast corner of Section 33, said township and range; thence south along the east line of said Section 33, and the east line of Section 4, Township 11 North, Range 18 East, M.D.B.& M., to the southeast corner of said Section 4; thence west along the south line of said Section 4 to the northeast corner of Section 8, said township and range; thence south along the east lines of Sections 8 and 17, said township and range, to the southeast corner of said Section 17; thence west along the south lines of Sections 17 and 18, said township and range, to the southwest corner of said Section 18; thence north along the west lines of Sections 18, 7 and 6, said township and range, and the west lines of Sections 31, 30, 19, 18 and 7, Township 12 North, Range 18 East, M.D.B.& M., to the northwest corner of said Section 7; thence east along the north line of said Section 7 to the southwest corner of Section 5, said township and range; thence north along the west line of fractional Section 5, said township and range, to the southerly Shore Line of Lake Tahoe; thence in an easterly direction along the meandering of the Lake Tahoe Shore Line coincident with the north lines of fractional Section 5, Township 12 North, Range 18 East, M.D.B.& M., fractional Sections 31, 32, 33, 28 and 27, in Township 13 North, Range 18 East, M.D.B.&M., to the POINT OF BEGINNING.