

Issued:  
September 27, 1996

Effective:  
October 27, 1996

Advice Letter No.:  
345

Issued by  
Edward S. Zub  
Senior Vice President

DESCRIPTION OF SERVICE AREA

- A. The service area of Southwest Gas Corporation within the County of Clark, State of Nevada, includes the following described area:
1. Township 17 South, Range 59 East, M.D.B. & M.
  2. Township 18 South, Ranges 59, 60, 61, 62, 63 and 64 East, M.D.B. & M.
  3. Township 19 South, Ranges 59, 60, 61, 62, 63 and 64 East, M.D.B. & M.
  4. Township 20 South, Ranges 59, 60, 61, 62, 63 and 64 East, M.D.B. & M.
  5. Township 21 South, Ranges 59, 60, 61, 62, 63 and 64 East, M.D.B. & M.
  6. Township 22 South, Ranges 59, 60, 61, 62 and 63 East, M.D.B. & M.
  7. In Township 23 South, Range 61 East, M.D.B. & M., all of Sections 1, 2, 3, 4, 5, 8, 9, 10, 11, 12, 16, 17, 19 and 20.

Issued:  
September 27, 1996

Effective:  
October 27, 1996

Advice Letter No.:  
345

Issued by  
Edward S. Zub  
Senior Vice President

DESCRIPTION OF SERVICE AREA  
(Continued)

B. The aforesaid Clark County, Nevada, service area of Southwest Gas Corporation is more particularly described as follows:

Commencing at the southwest (SW) corner of Township 22 South, Range 59 East; thence northerly along the west lines of Township 22 South, Range 59 East, Township 21 South, Range 59 East, Township 20 South, Range 59 East, Township 19 South, Range 59 East, Township 18 South, Range 59 East and Township 17 South, Range 59 East, to the northwest (NW) corner of Township 17 South, Range 59 East; thence easterly along the north line of Township 17 South, Range 59 East, to the northeast (NE) corner of Township 17 South, Range 59 East; thence southerly along the east line of Township 17 South, Range 59 East, to the southeast (SE) corner of Township 17 South, Range 59 East; thence easterly along the north lines of Township 18 South, Range 60 East, Township 18 South, Range 61 East, Township 18 South, Range 62 East, Township 18 South, Range 63 East and Township 18 South, Range 64 East, to the northeast (NE) corner of Township 18 South, Range 64 East; thence southerly along the east lines of Township 18 South, Range 64 East, Township 19 South, Range 64 East, Township 20 South, Range 64 East and Township 21 South, Range 64 East, to the southeast (SE) corner of Township 21 South, Range 64 East; thence westerly along the south line of Township 21 South, Range 64 East, to the southwest (SW) corner of said Township 21 South, Range 64 East; thence southerly along the east line of Township 22 South, Range 63 East, to the southeast (SE) corner of said Township 22 South, Range 63 East; thence westerly along the south line of Township 22 South, Range 63 East and Township 22 South, Range 62 East, to the southwest (SW) corner of said Township 22 South, Range 62 East; thence southerly along the east line of Sections 1 and 12 to the southeast (SE) corner of said Section 12, Township 23 South, Range 61 East; thence westerly along the south lines of Sections 10, 11 and 12 to the southwest (SW) corner of said Section 10, Township 23 South, Range 61 East; thence southerly along the east line of Section 16, Township 23 South, Range 61 East, to the southeast (SE) corner of said Section 16; thence westerly along the south line of said Section 16 to the southwest (SW) corner of said Section 16; thence southerly along the

<p><b>Issued:</b> September 27, 1996</p> <p><b>Effective:</b> October 27, 1996</p> <p><b>Advice Letter No.:</b> <u>345</u></p>	<p><b>Issued by</b> Edward S. Zub Senior Vice President</p>	
--	---	--

DESCRIPTION OF SERVICE AREA  
*(Continued)*

east line of Section 20, Township 23 South, Range 61 East, to the southeast (SE) corner of said Section 20; thence westerly along the south lines of Sections 19 and 20, Township 23 South, Range 61 East, to the southwest (SW) corner of said Section 19; thence northerly along the west line of said Section 19 to the northwest (NW) corner of said Section 19; thence easterly along the north line of said Section 19 to the northeast (NE) corner of said Section 19; thence northerly along the west lines of Sections 5, 8 and 17, Township 23 South, Range 61 East, to the northwest (NW) corner of said Section 5, Township 23 South, Range 61 East; thence westerly along the south lines of Section 31, Township 22 South, Range 61 East, Township 22 South, Range 60 East and Township 22 South, Range 59 East, to the point of beginning in the southwest (SW) corner of Township 22 South, Range 59 East, all M.D.B. & M.

<p>Issued: September 27, 1996</p> <p>Effective: October 27, 1996</p> <p>Advice Letter No.: <u>345</u></p>	<p>Issued by Edward S. Zub Senior Vice President</p>	
---	--	--

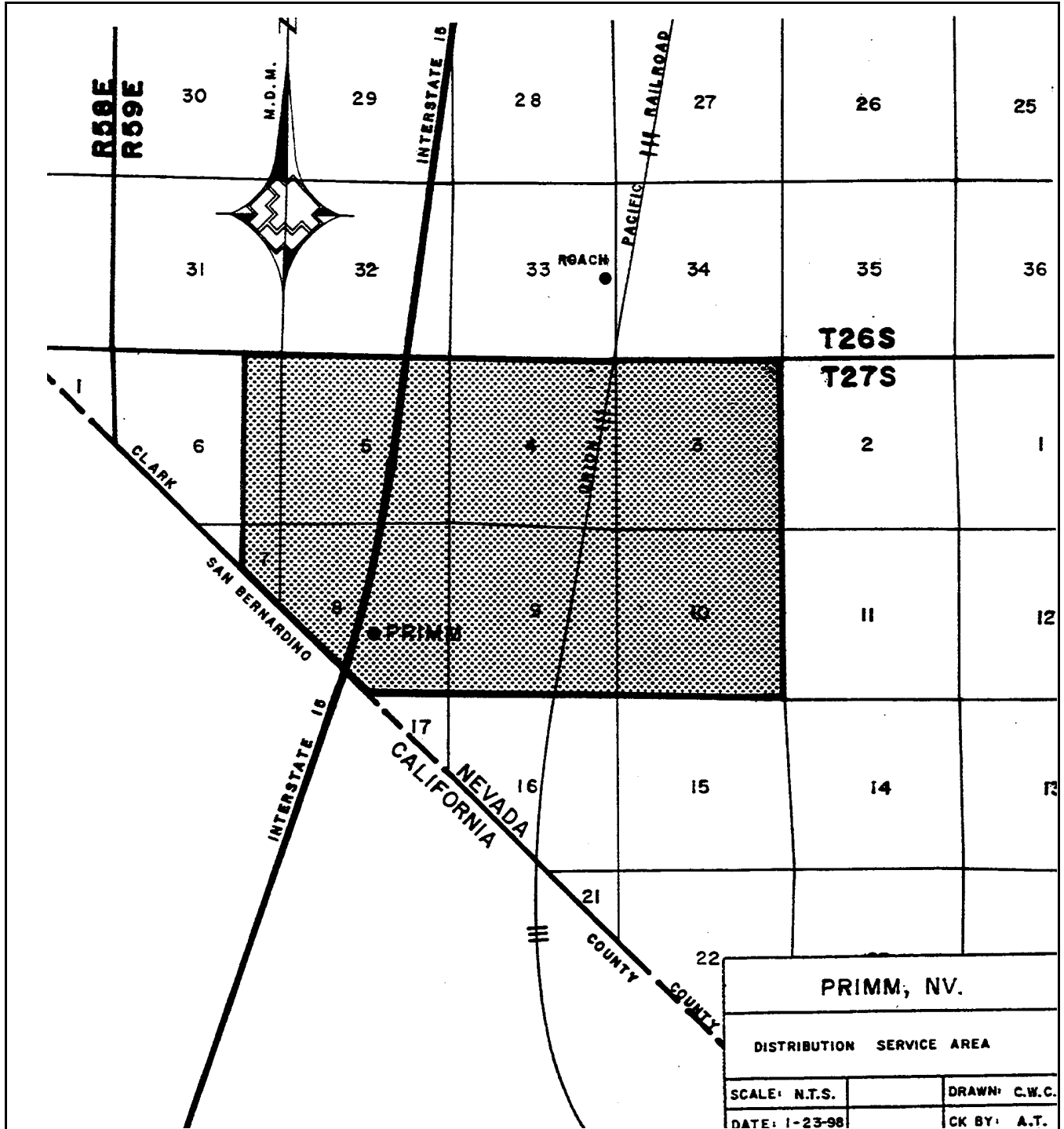

Issued:  
January 27, 1998

Effective:  
May 21, 1998

Advice Letter No.:  
355

Issued by  
Edward S. Zub  
Senior Vice President

DESCRIPTION OF SERVICE AREA

A. The service area of Southwest Gas Corporation in or near Primm, County of Clark, State of Nevada, includes the following described area:

Township 27 South, Range 59 East, M.D.B. & M. All of Sections 3, 4, 5, 9 and 10; all of that portion of the east half of the east half (E $\frac{1}{2}$  E $\frac{1}{2}$ ) of Sections 6 and 7, and all of that portion of Section 8, northeast of the Nevada/California State Boundary Line.

B. The aforesaid Primm, Nevada, service area of Southwest Gas Corporation is more particularly described as follows:

Beginning at the northeast (NE) corner of Section 3, Township 27 South, Range 59 East, M.D.B. & M., Clark County, Nevada; thence southerly along the east line of Sections 3 and 10, to the southeast (SE) corner of Section 10, said township and range; thence westerly along the south line of Sections 10, 9 and 8, to a point, said point being the Nevada/California State Boundary Line; thence in a northwesterly direction along said boundary line to a point, said point being the west line of the east half of the east half (E $\frac{1}{2}$  E $\frac{1}{2}$ ) of Section 7, said township and range; thence northerly along the west line of the east half of the east half (E $\frac{1}{2}$  E $\frac{1}{2}$ ) of Sections 7 and 6, to the northwest (NW) corner of said east half of the east half (E $\frac{1}{2}$  E $\frac{1}{2}$ ) of Section 6; thence easterly along the north line of Sections 6, 5, 4 and 3, to the northeast (NE) corner of Section 3, said township and range, said corner being the point of beginning.

Issued:  
January 27, 1998

Effective:  
May 21, 1998

Advice Letter No.:  
355

Issued by  
Edward S. Zub  
Senior Vice President

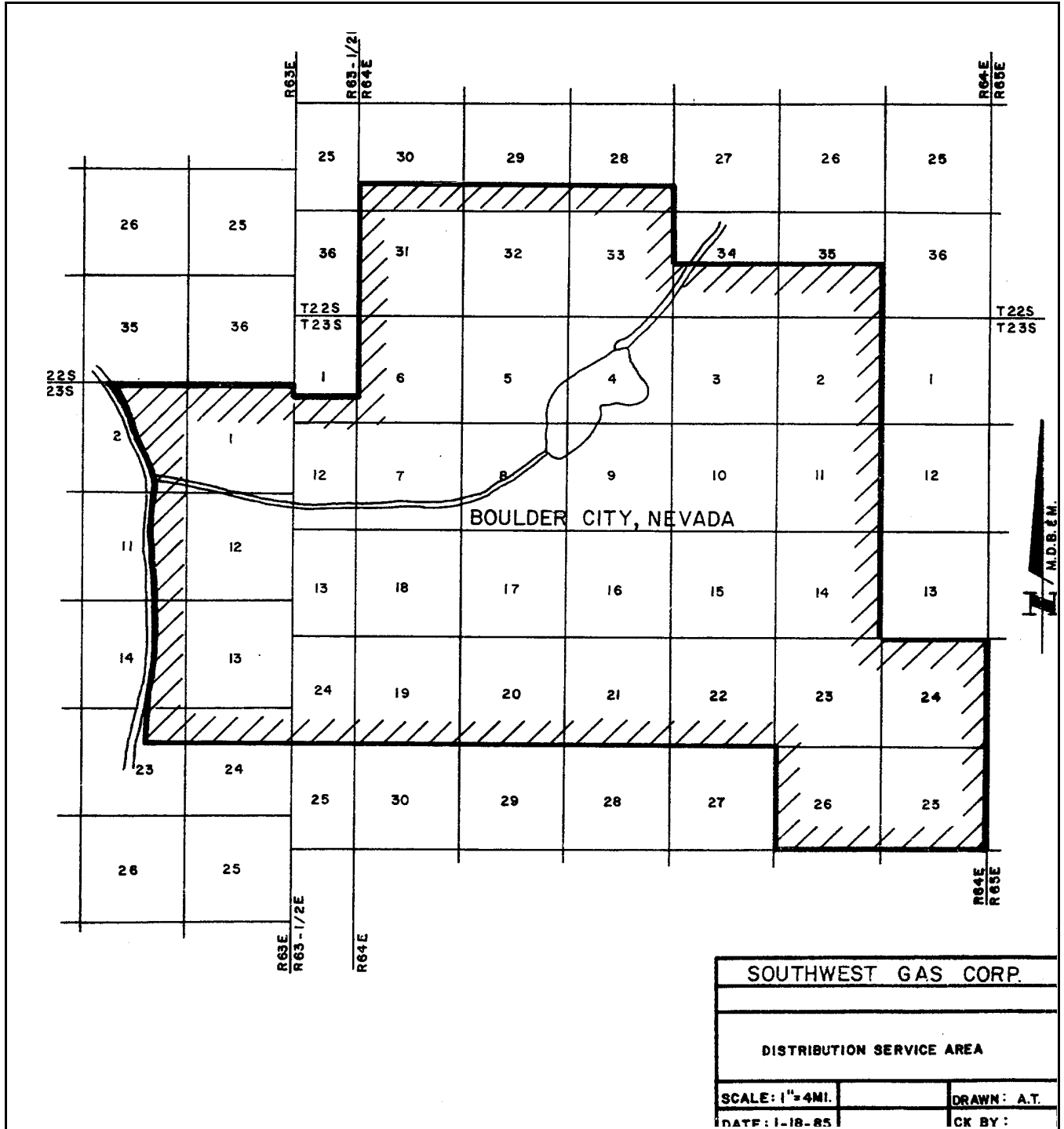

SOUTHWEST GAS CORP.	
DISTRIBUTION SERVICE AREA	
SCALE: 1"=4MI.	DRAWN: A.T.
DATE: 1-18-85	CK BY:

Issued:  
September 27, 1996

Effective:  
October 27, 1996

Advice Letter No.:  
345

Issued by  
Edward S. Zub  
Senior Vice President

DESCRIPTION OF SERVICE AREA

The service area of Southwest Gas Corporation in or near Boulder City, County of Clark, State of Nevada, includes the following described area:

1. Township 23 South, Range 63 East, M.D.B. & M. All of Section 1; that portion of Section 2 lying easterly of the right-of-way of United States Highway 95; that portion of Section 11 lying easterly of the right-of-way of Highway 95 (now abandoned); all of Section 12; all of Section 13; that portion of Section 14 lying easterly of said right-of-way of Highway 95 (now abandoned) to a point being near the south boundary of said Section 14, said point being on the west line of Lot 8 and the easterly right-of-way line of said Highway; thence south along the west boundary of said Lot 8 to a point on the south boundary of said Section 14; the northeast quarter (NE 1/4) of the northeast quarter (NE 1/4) and Lots 1, 4 and 5 of Section 23; the north half (N1/2) of the north half (N 1/2) and Lots 1, 2, 3 and 4 of Section 24.
2. Township 23 South, Range 63 1/2 East, M.D.B. & M. All of Lots 8, 9 and 10 of Section 1; all of fractional Sections 12, 13 and 24.
3. Township 22 South, Range 64 East, M.D.B. & M. The south half (S 1/2) of the south half (S 1/2) of Section 28; the south half (S 1/2) of the south half (S 1/2) of Section 29; the south half (S 1/2) of the southeast quarter (SE 1/4), the southeast quarter (SE 1/4) of the southwest quarter (SW 1/4) and Lot 12 of Section 30; all of Section 31; all of Section 32; all of Section 33; the south half (S 1/2) of Section 34; and the south half (S 1/2) of Section 35.
4. Township 23 South, Range 64 East, M.D.B. & M. All of Sections 2, 3, 4, 5, 6, 7, 8, 9, 10, 11, 14, 15, 16, 17, 18, 19, 20, 21, 22, 23, 24, 25 and 26.

Issued:  
September 27, 1996

Effective:  
October 27, 1996

Advice Letter No.:  
345

Issued by  
Edward S. Zub  
Senior Vice President



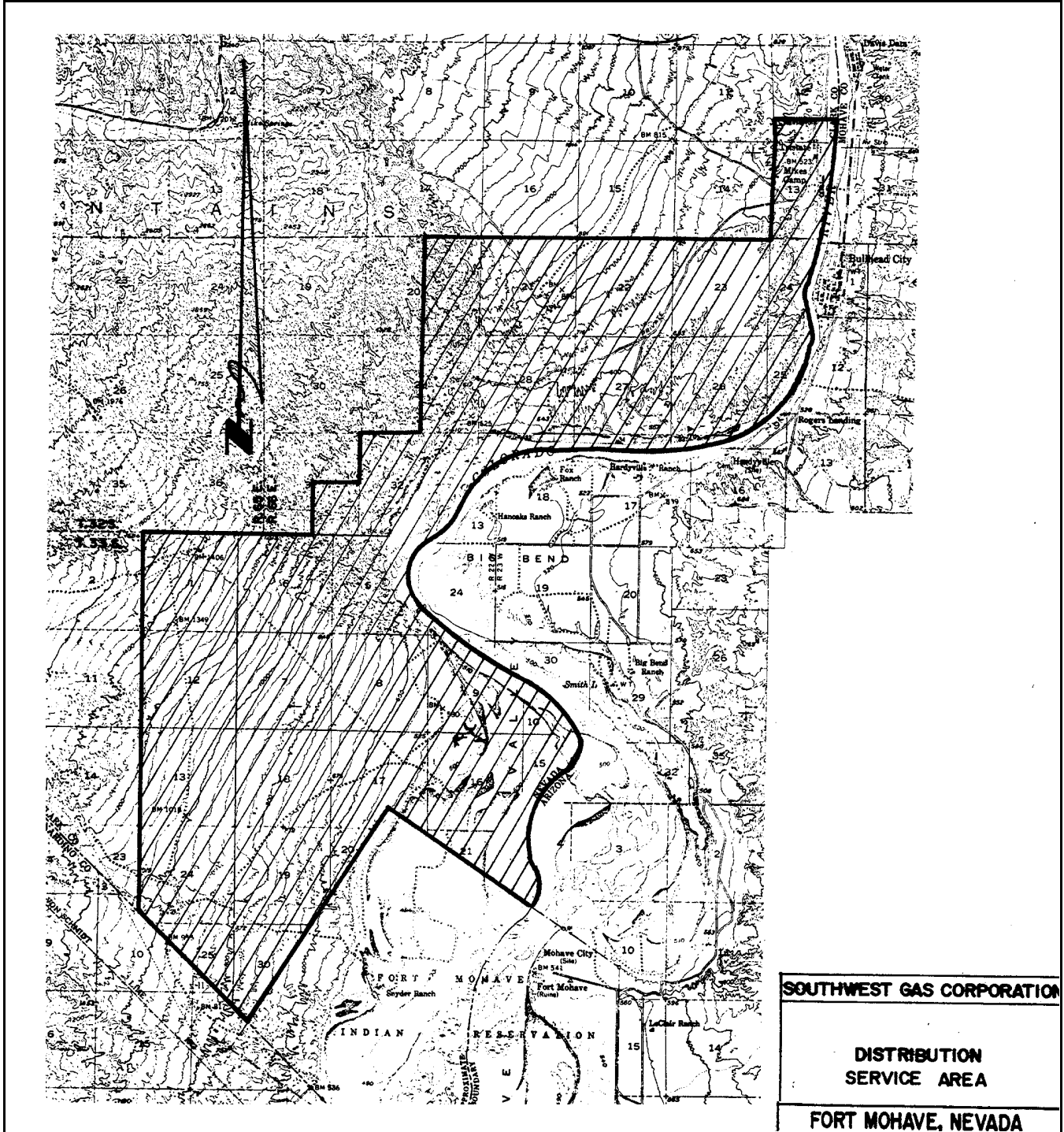

Issued:  
September 27, 1996

Effective:  
October 27, 1996

Advice Letter No.:  
345

Issued by  
Edward S. Zub  
Senior Vice President

SOUTHWEST GAS CORPORATION  
DISTRIBUTION SERVICE AREA  
FORT MOHAVE, NEVADA

DESCRIPTION OF SERVICE AREA

- A. The service area of Southwest Gas Corporation in or near Fort Mohave, County of Clark, State of Nevada, includes the following described area:
1. Township 32 South, Range 66 East, M.D.B. & M. All of Sections 21, 22, 23, 27 and 28; all of Lots 14, 15 and 16 of Section 12; and all of Sections 13, 24, 25, 26, 32, 33, 34 and 35 within the State of Nevada; the east half (E 1/2) of Sections 20 and 29; and the southeast quarter (SE 1/4) of Section 31.
  2. Township 33 South, Range 65 East, M.D.B. & M. All of Sections 1, 12 and 13; and all of Sections 24 and 25 within the State of Nevada.
  3. Township 33 South, Range 66 East, M.D.B. & M. All of Sections 6, 7, 8, 16 and 18; all of Sections 4, 5, 9, 10, 14, 15 and 23 within the State of Nevada, and all of Sections 17, 19, 20, 21, 22, 30 and 31 within the State of Nevada but outside the Fort Mohave Indian Reservation.

B. The aforesaid Fort Mohave, Nevada, service area of Southwest Gas Corporation is more particularly described as follows:

Beginning at the northwest (NW) corner of Section 1, Township 33 South, Range 65 East, M.D.B. & M., Clark County, Nevada; thence south along the west line of Sections 1, 12, 13 and 24; said township and range, to the Nevada-California State Boundary in said Section 24; thence southeasterly along said State Boundary to a point in Section 31, Township 33 South, Range 66 East, M.D.B. & M., where the Fort Mohave Indian Reservation boundary intersects with the said State Boundary; thence northerly along the said Indian Reservation boundary through Sections 31, 30, 19, 20 and 17, said township and range, to a point in said Section 17, the north (N) corner of the Indian Reservation; thence continuing along said boundary in a southeasterly direction through Sections 17, 20, 21 and 22, said township and range, to the intersection of Fort Mohave Indian Reservation boundary and the Nevada-Arizona State Boundary; thence in a northerly direction along the said State Boundary through Township 33 South, Range 66 East,

<p>Issued: September 27, 1996</p> <p>Effective: October 27, 1996</p> <p>Advice Letter No.: <u>345</u></p>	<p>Issued by Edward S. Zub Senior Vice President</p>	
---	--	--

DESCRIPTION OF SERVICE AREA  
(Continued)

M.D.B. & M. and Township 32 South, Range 66 East, M.D.B. & M. to a point on the north line of Lot 16 of Section 12, said township and range; thence west along the north line of Lots 16, 15 and 14 of Section 12 to the west line of Section 12, said township and range; thence south on the west line of Sections 12 and 13, said township and range to the southwest (SW) corner of said Section 13, said township and range; thence west along the north line of Sections 23, 22, 21 and 20, said township and range, to the north quarter (N 1/4) corner of said Section 20; thence south along the center section line of Sections 20 and 29; said township and range, to the north quarter (N 1/4) corner of Section 32; said township and range; thence west along the north line of said Section 32 to the northwest (NW) corner of said Section 32; thence south along the west line of said Section 32 to the west quarter (W 1/4) corner of said Section 32; thence west along the north line of the southeast quarter (SE 1/4) of Section 31; said township and range, to the northwest (NW) corner of said quarter section; thence south along the west line of said quarter section; to the north line of Township 33 South, Range 66 East, M.D.B. & M.; thence west along the north line of said township and range and Township 33 South, Range 65 East, M.D.B. & M. to the point of beginning at the northwest (NW) corner of Section 1, Township 33 South, Range 65 East, M.D.B. & M., Clark County, Nevada.

Issued:  
September 27, 1996

Effective:  
October 27, 1996

Advice Letter No.:  
345

Issued by  
Edward S. Zub  
Senior Vice President

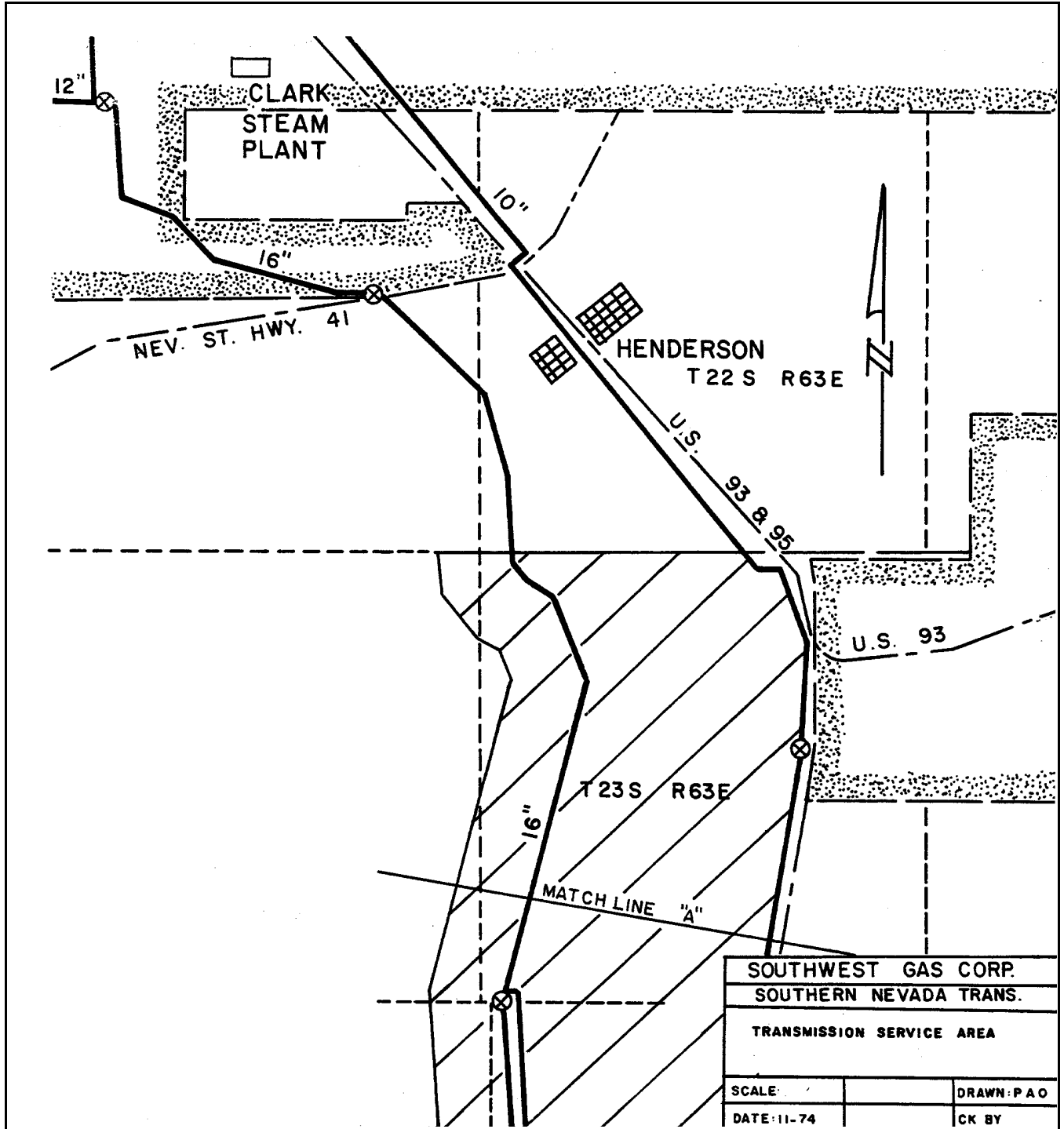

Issued:  
September 27, 1996

Effective:  
October 27, 1996

Advice Letter No.:  
345

Issued by  
Edward S. Zub  
Senior Vice President

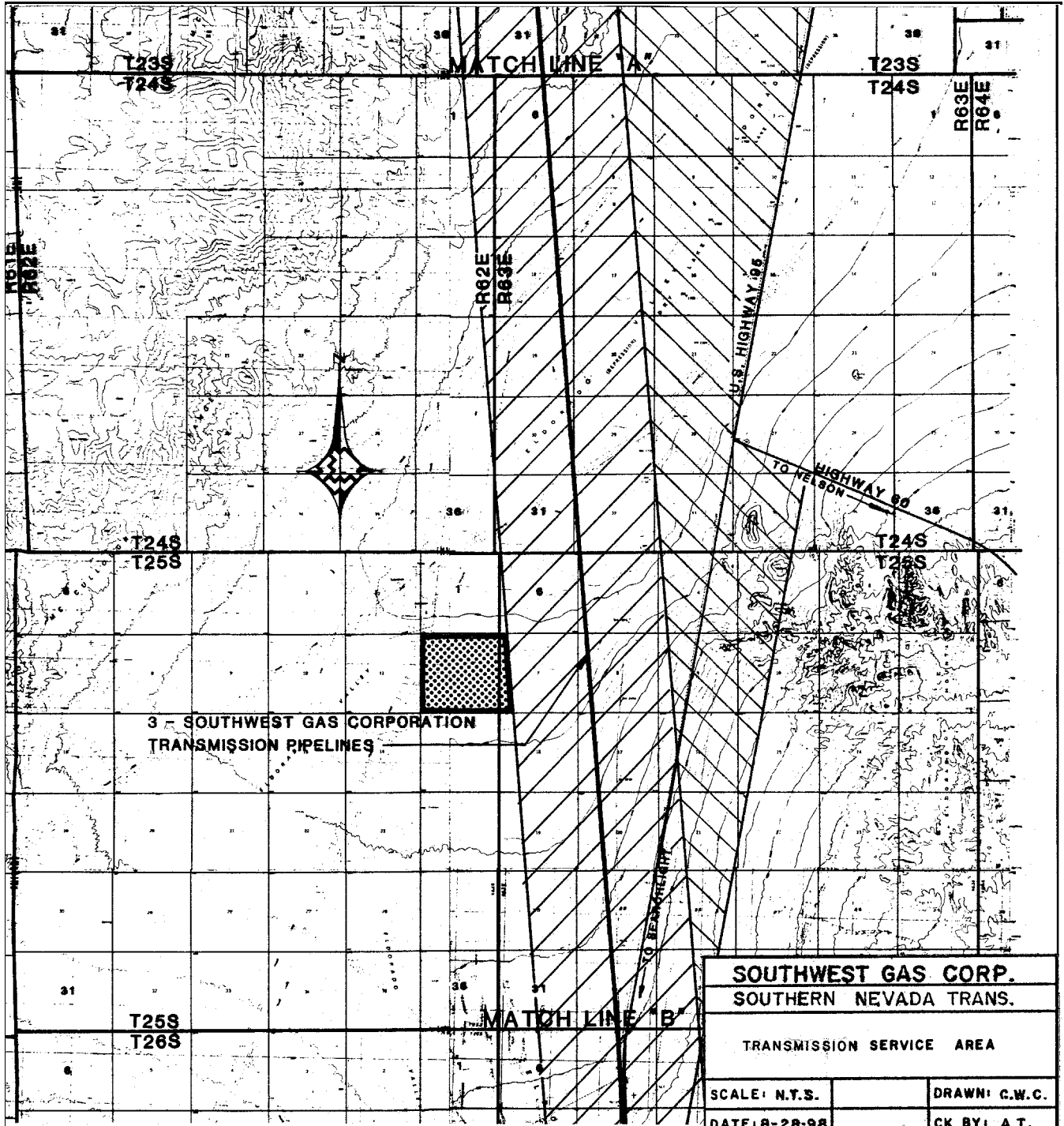

Issued:  
September 28, 1998

Effective:  
October 14, 1998

Advice Letter No.:  
362

Issued by  
Edward S. Zub  
Senior Vice President

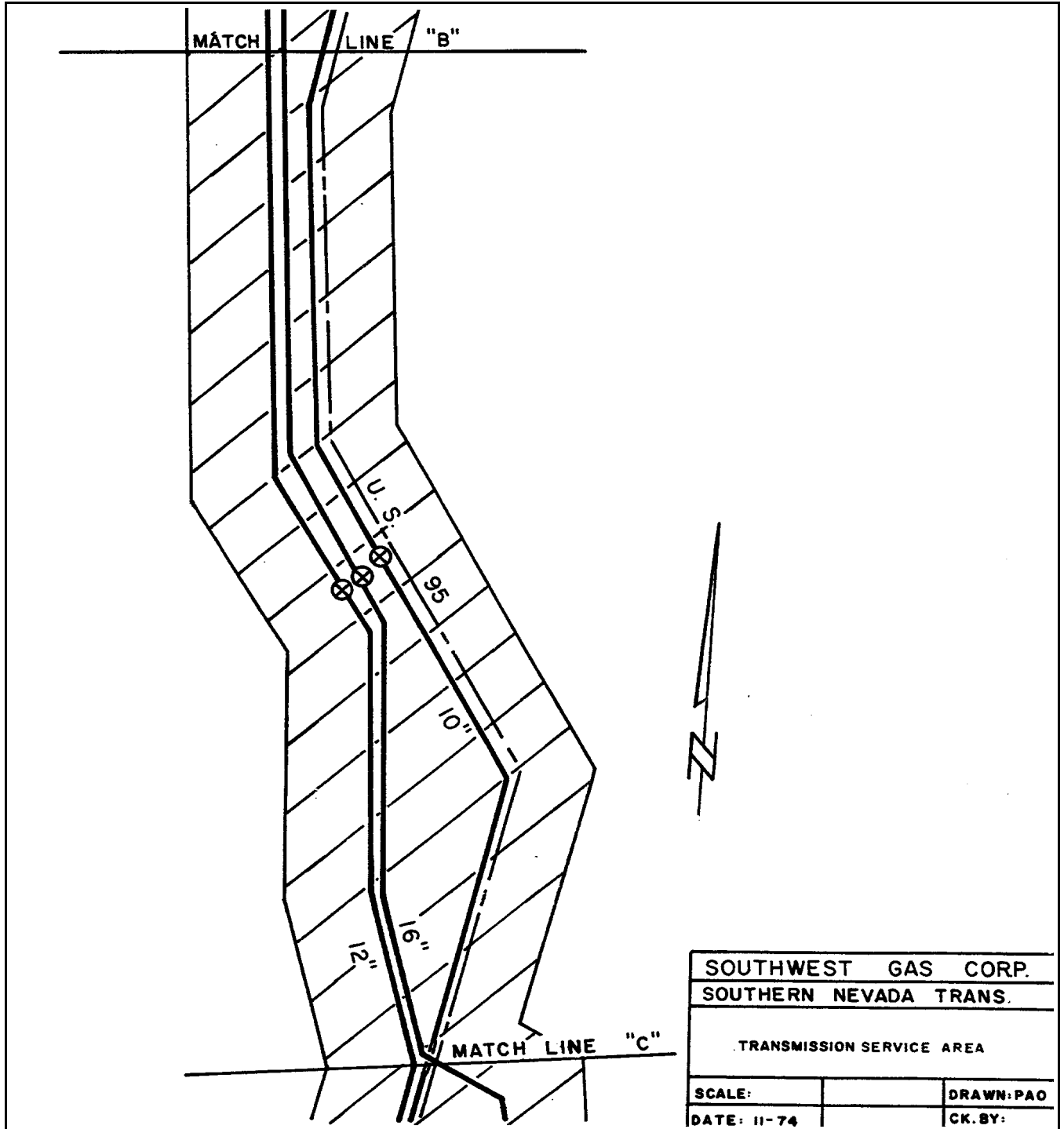

SOUTHWEST GAS CORP.		
SOUTHERN NEVADA TRANS.		
TRANSMISSION SERVICE AREA		
SCALE:		DRAWN: PAO
DATE: 11-74		CK. BY:

<p>Issued: September 27, 1996</p> <p>Effective: October 27, 1996</p> <p>Advice Letter No.: <u>345</u></p>	<p>Issued by Edward S. Zub Senior Vice President</p>	
---	--	--

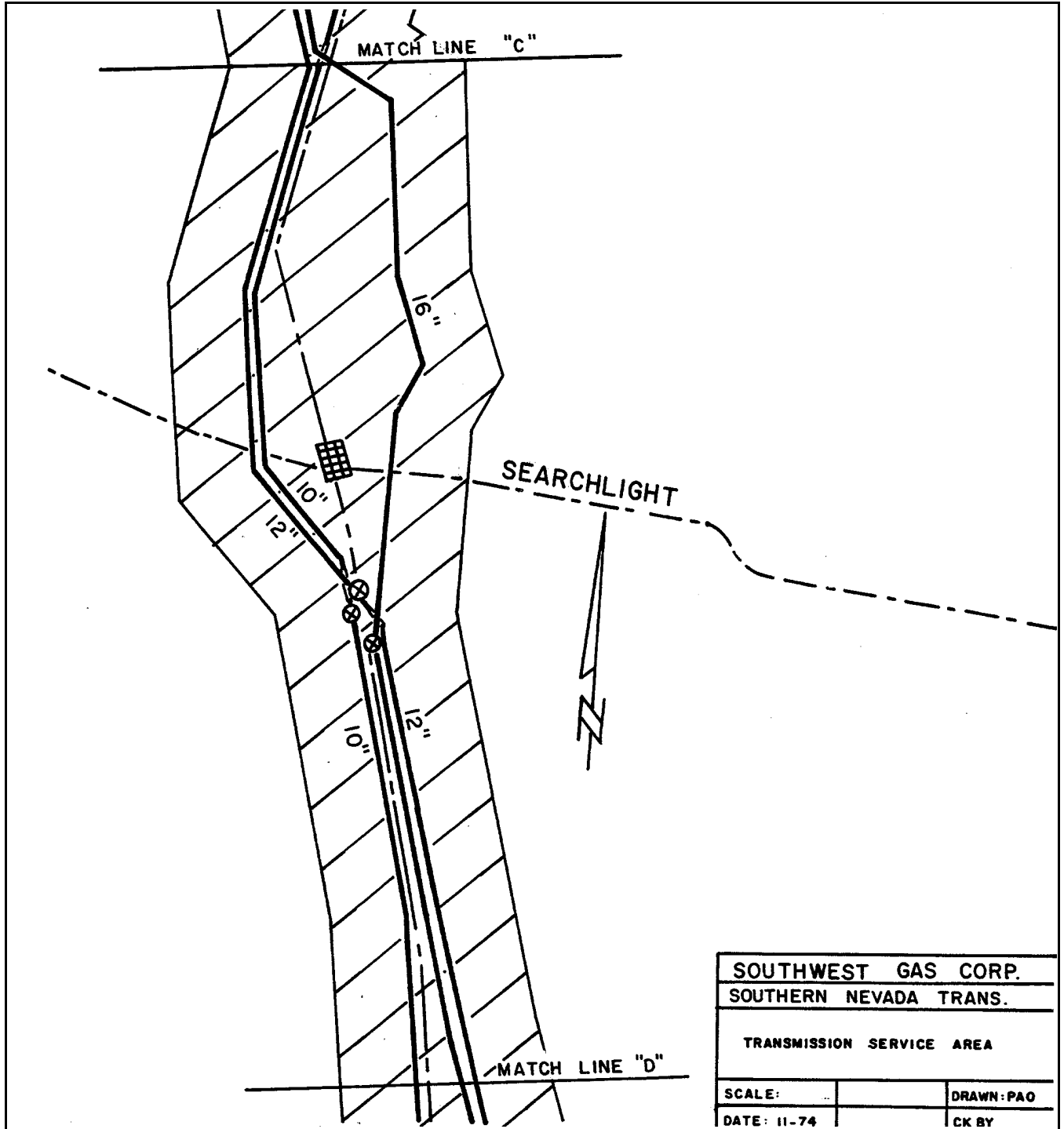

SOUTHWEST GAS CORP.		
SOUTHERN NEVADA TRANS.		
TRANSMISSION SERVICE AREA		
SCALE:		DRAWN: PAO
DATE: 11-74		CK BY

<p>Issued: September 27, 1996</p> <p>Effective: October 27, 1996</p> <p>Advice Letter No.: <u>345</u></p>	<p>Issued by Edward S. Zub Senior Vice President</p>	
---	--	--

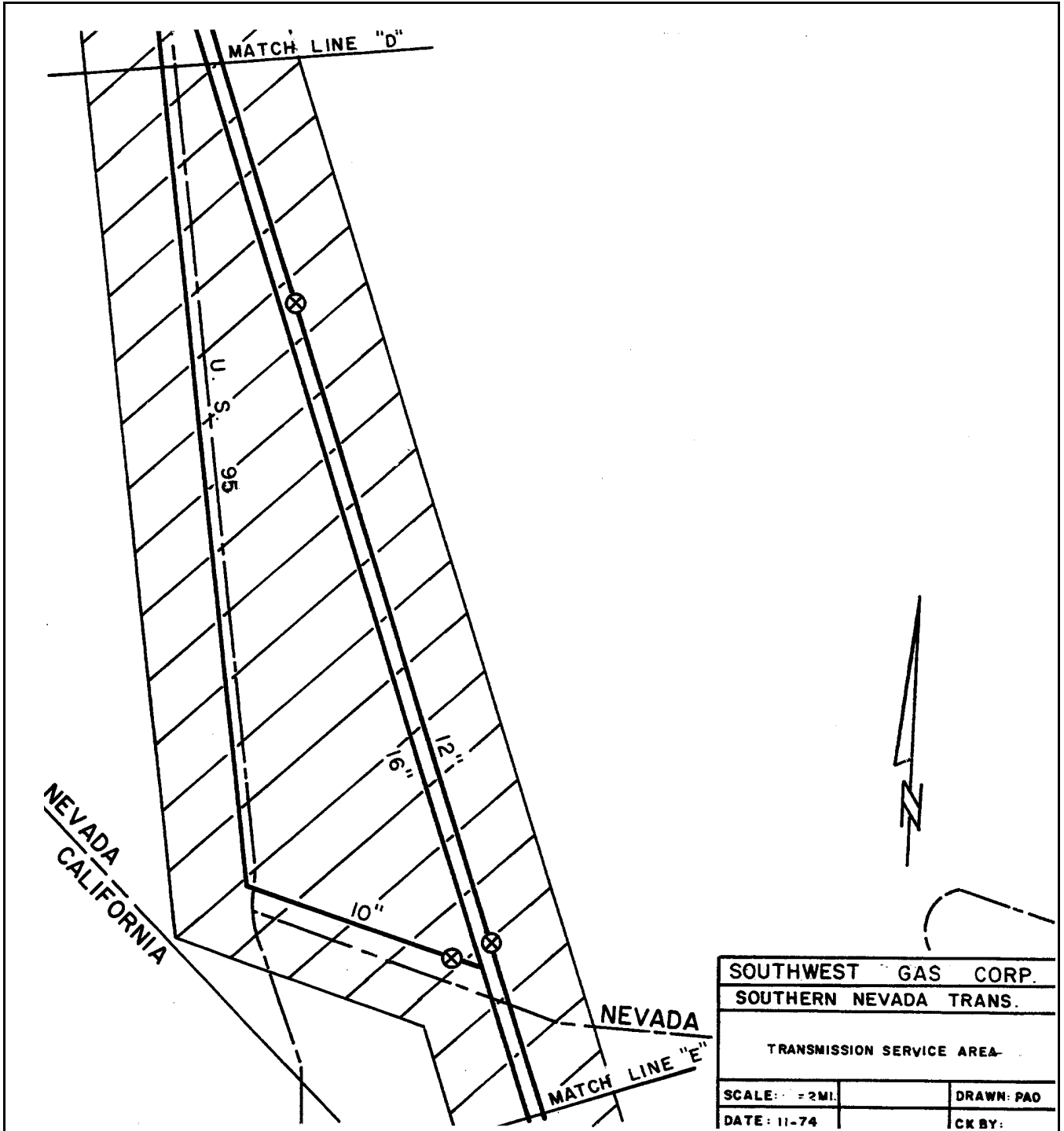

SOUTHWEST GAS CORP.		
SOUTHERN NEVADA TRANS.		
TRANSMISSION SERVICE AREA		
SCALE: 1" = 2 MI.		DRAWN: PAO
DATE: 11-74		CK BY:

Issued:  
September 27, 1996

Effective:  
October 27, 1996

Advice Letter No.:  
345

Issued by  
Edward S. Zub  
Senior Vice President



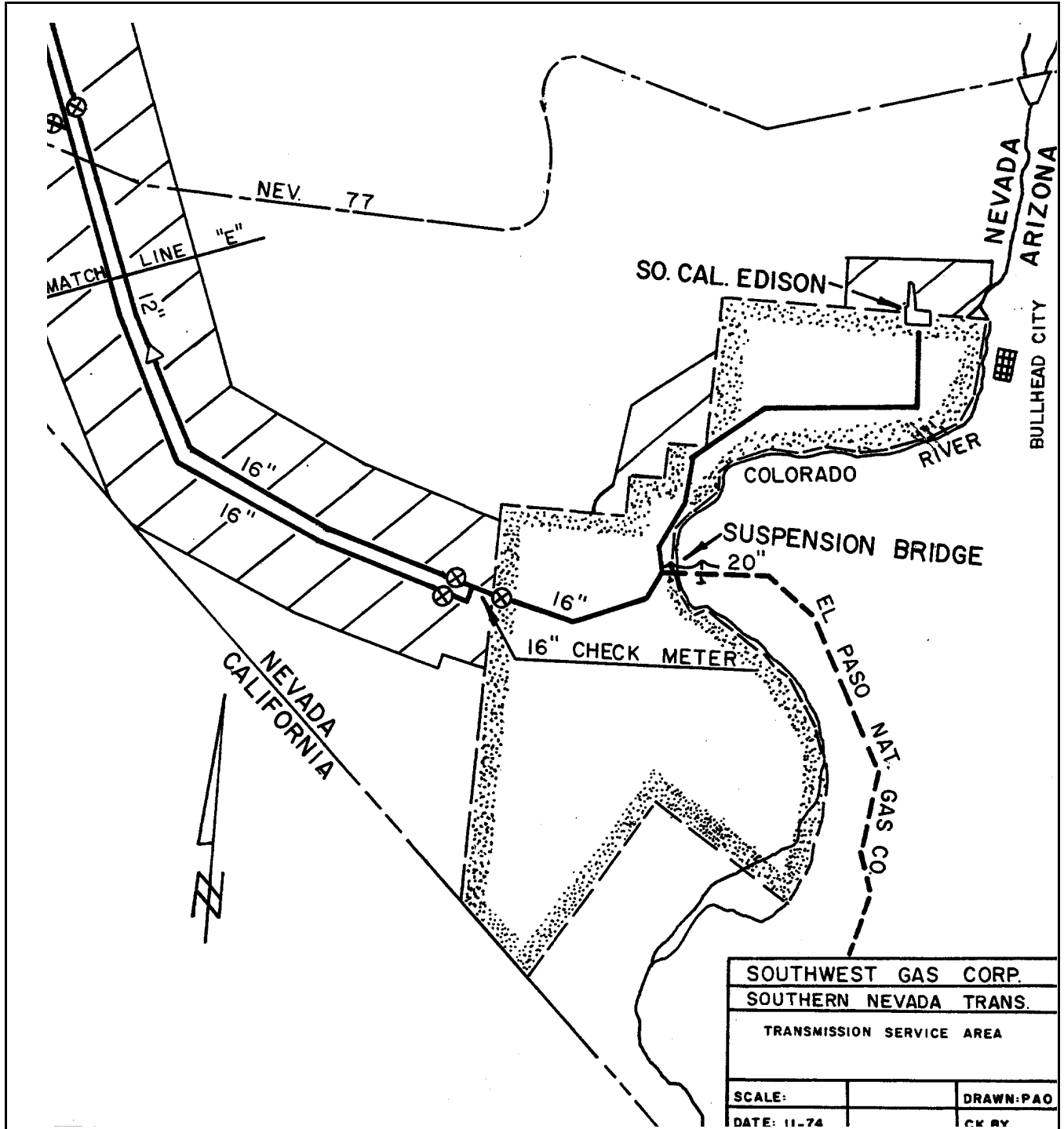

SOUTHWEST GAS CORP.		
SOUTHERN NEVADA TRANS.		
TRANSMISSION SERVICE AREA		
SCALE:		DRAWN: PAO
DATE: 11-74		CK BY

Issued:  
September 27, 1996

Effective:  
October 27, 1996

Advice Letter No.:  
345

Issued by  
Edward S. Zub  
Senior Vice President

DESCRIPTION OF SERVICE AREA

A. The service area of Southwest Gas Corporation within the County of Clark, State of Nevada, includes along its main transmission pipeline and lateral lines the following described areas:

1. Main Lines

A strip one (1) mile on the east side of the most easterly pipeline, one (1) mile on the west side of the most westerly pipeline and including all the area between said pipelines beginning at a point on the Colorado River in Section 4, Township 33 South, Range 66 East, M.D.B. & M. and continuing along the main transmission pipelines to the south line of Township 22 South, Ranges 62 and 63 East, M.D.B. & M. near Henderson, Nevada; except commencing in Section 27, Township 24 South, Range 63 East, M.D.B. & M., the strip on the east side of the most easterly pipeline will stop at the center line of U.S. Highway 95 and State Highway 60 and will continue northerly along the center line of U.S. Highway 95 to the south line of Township 22 South, Range 63 East, M.D.B. & M. near Henderson, Nevada; All of that portion of Sections 6 and 7, Township 25 South, Range 63 East and all of Sections 1 and 12, Township 25 South, Range 62 East west of the existing main transmission pipelines.

2. Edison Lateral

A strip one (1) mile on either side of the Edison Lateral center line, beginning at a point on the main transmission pipeline in Section 5, Township 33 South, Range 66 East, M.D.B. & M., and continuing along the pipeline center line to the termination point in Section 23, Township 32 South, Range 66 East, M.D.B. & M.

Issued:  
September 28, 1998

Effective:  
October 14, 1998

Advice Letter No.:  
362

Issued by  
Edward S. Zub  
Senior Vice President

SOUTHWEST GAS CORPORATION  
 P.O. Box 98510  
 Las Vegas, Nevada 89193-8510  
 Nevada Gas Tariff No. 6

Canceling First Revised P.U.C.N. Sheet No. 247  
Original P.U.C.N. Sheet No. 247-251

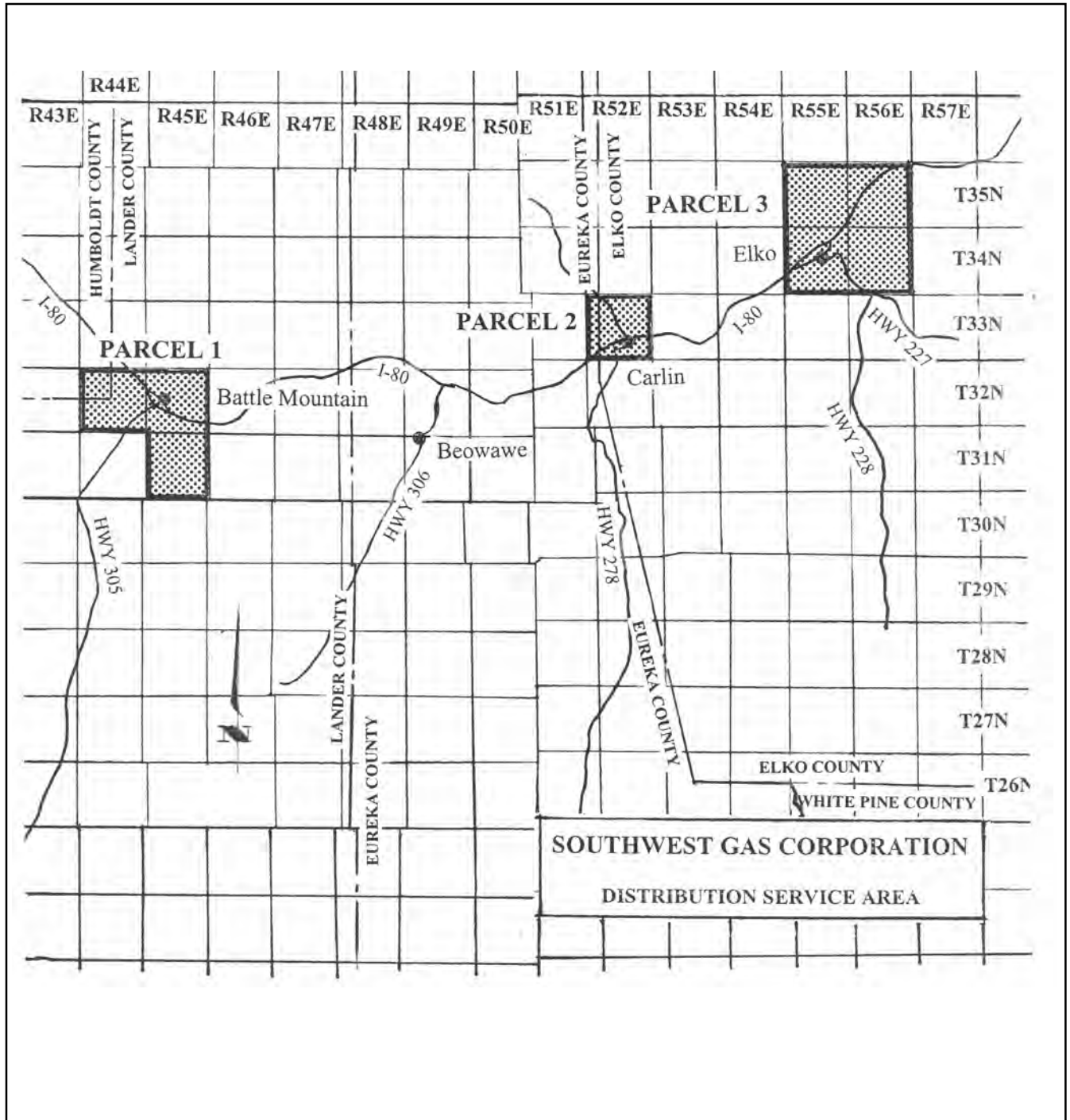

<p>Issued:          February 17, 2006</p> <p>Effective:          January 19, 2006</p> <p>Advice Letter No.:  <u>419</u></p>	<p>Issued by          John P. Hester          Vice President</p>	
---	--	--

DESCRIPTION OF SERVICE AREA

- A. The service area of Southwest Gas Corporation in the Counties of Carlin, Humboldt, Elko, and Lander, State of Nevada, includes the following described area:
1. Township 35 North, Range 55 East, M.D.B.& M. All sections.
  2. Township 35 North, Range 56 East, M.D.B.& M. All sections.
  3. Township 34 North, Range 55 East. M.D.B.& M. All sections.
  4. Township 34 North, Range 56 East. M.D.B.& M. All sections.
  5. Township 33 North, Range 52 East, M.D.B.& M. All sections.
  6. Township 32 North, Range 44 East, M.D.B.& M. All sections.
  7. Township 32 North, Range 45 East, M.D.B.& M. All sections.
  8. Township 31 North, Range 45 East, M.D.B.& M. All sections.

B. The aforesaid service area of Southwest Gas Corporation is more particularly described as follows:

PARCEL 1: Beginning at the northwest (NW) corner of Section 6, Township 32 North, Range 44 East, M.D.B.& M., Humboldt County, Nevada; thence easterly along the north lines of Township 32 North, Ranges 44 and 45 East, crossing into Lander County, to the northeast (NE) corner of Section 1, Township 32 North, Range 45 East; thence southerly along the east lines of Townships 32 and 31 North, Range 45 East to the southeast (SE) corner of Section 36, Township 31 North, Range 45 East; thence westerly along the south lines of Sections 36, 35, 34, 33, 32, and 31 to the southwest (SW) corner of Section 31, said Township and Range; thence northerly along the west lines of Sections 31, 30, 19, 18, 7, and 6 to the northwest (NW) corner of Section 6, said Township and Range; thence westerly along the south lines of Sections 36, 35, 34, 33, 32, and 31 to the southwest (SW) corner of Section 31, Township 32 North, Range 44 East; thence northerly along the west lines of Sections 31, 30, 19, 18, 7, and 6, crossing into Humboldt County, to the northwest (NW) corner of Section 6, Township 32 North, Range 44 East, the point of beginning.

<p>Issued: February 17, 2006</p> <p>Effective: January 19, 2006</p> <p>Advice Letter No.: <u>419</u></p>	<p>Issued by John P. Hester Vice President</p>	
--	--	--

DESCRIPTION OF SERVICE AREA  
(Continued)

B. PARCEL 2: Beginning at the northwest (NW) corner of Section 6, Township 33 North, Range 52 East, M.D.B.& M., Elko County, Nevada; thence easterly along the north lines of Sections 6, 5, 4, 3, 2, and 1 to the northeast (NE) corner of Section 1, said Township and Range; thence southerly along the east lines of Sections 1, 12, 13, 24, 25, and 36 to the southeast (SE) corner of Section 36, said Township and Range; thence westerly along the south lines of Sections 36, 35, 34, 33, 32, and 31 to the southwest (SW) corner of Section 31, said Township and Range; thence northerly along the west lines of Sections 31, 30, 19, 18, 7 and 6 to the northwest (NW) corner of Section 6, Township 33 North, Range 52 East, the point of beginning.

PARCEL 3: Beginning at the northwest (NW) corner of Section 6, Township 35 North, Range 55 East, M.D.B.& M., Elko County, Nevada; thence easterly along the north lines of Township 35 North, Ranges 55 and 56 East to the northeast (NE) corner of Section 1, Township 35 North, Range 56 East; thence southerly along the east lines of Townships 35 and 34 North, Range 56 East to the southeast (SE) corner of Section 36, Township 34 North, Range 56 East; thence westerly along the south lines of Township 34 North, Ranges 56 and 55 East to the southwest (SW) corner of Section 31, Township 34 North, Range 55 East; thence northerly along the west lines of Townships 34 and 35 North, Range 55 East to the northwest (NW) corner of Section 6, Township 35 North, Range 55 East, the point of beginning.

Issued:

February 17, 2006

Effective:

January 19, 2006

Advice Letter No.:

419

Issued by  
John P. Hester  
Vice President

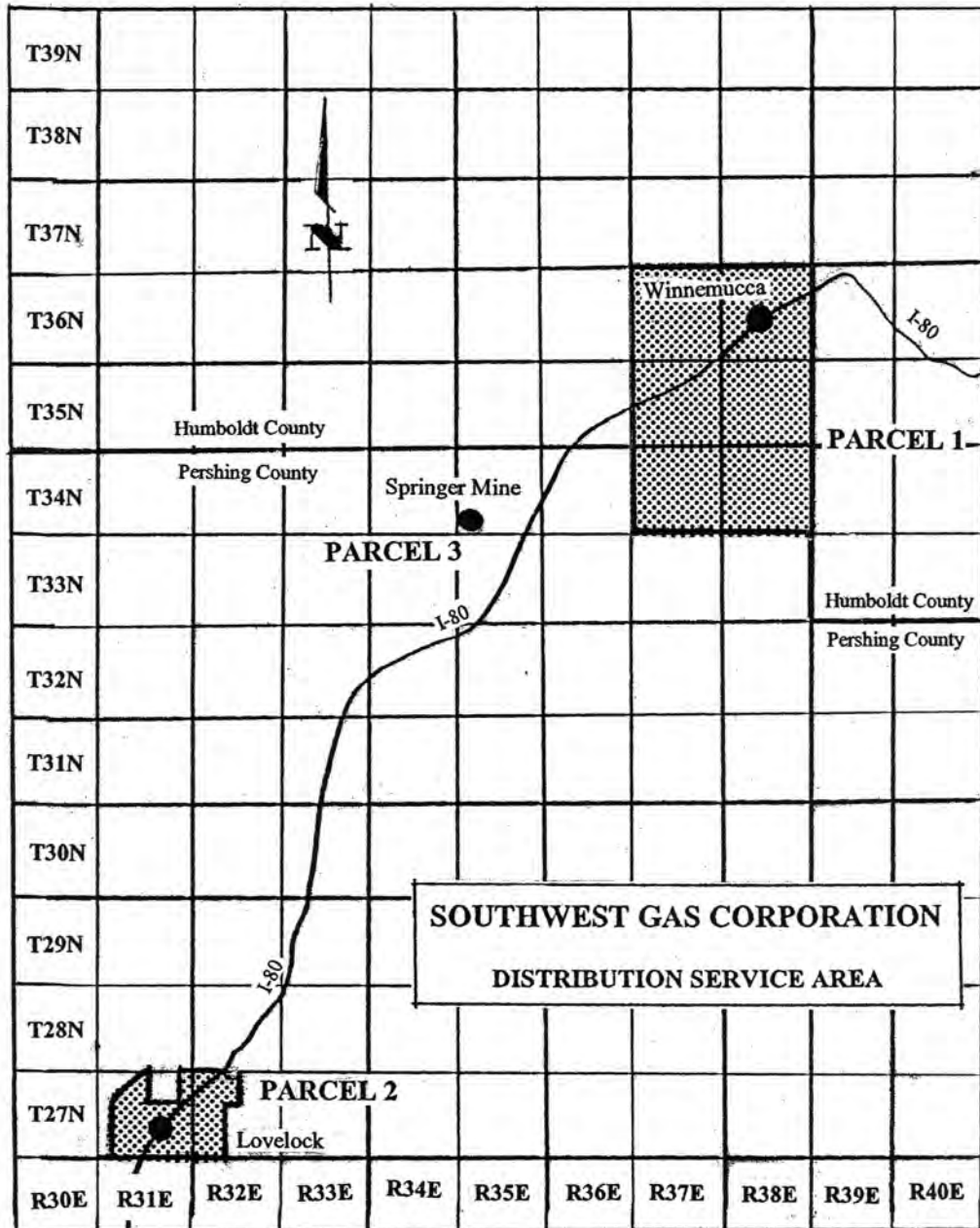

Issued:  
February 17, 2006

Effective:  
January 19, 2006

Advice Letter No.:  
419

Issued by  
John P. Hester  
Vice President

DESCRIPTION OF SERVICE AREA

- A. The service area of Southwest Gas Corporation in the Counties of Humboldt and Pershing, State of Nevada, includes the following described area:
1. Township 36 North, Range 37 East, M.D.B.& M. All sections.
  2. Township 36 North, Range 38 East, M.D.B.& M. All sections.
  3. Township 35 North, Range 37 East, M.D.B.& M. All sections.
  4. Township 35 North, Range 38 East, M.D.B.& M. All sections.
  5. Township 34 North, Range 37 East, M.D.B.& M. All sections.
  6. Township 34 North, Range 38 East, M.D.B.& M. All sections.
  7. Township 26 North, Range 31 East, M.D.B.& M. All of Sections 1, 2, 3, 4 and 5.
  8. Township 26 North, Range 32 East, M.D.B.& M. All of Sections 5 and 6.
  9. Township 27 North, Range 31 East, M.D.B.& M. All of Sections 1, 12, 13, 16, 20, 21, 22, 23, 24, 25, 26, 27, 28, 29, 32, 33, 34, 35 and 36; all of that portion of Sections 4, 8, 9 and 17, one mile distant from Paiute Pipeline Company's (Paiute) Mainline.
  10. Township 27 North, Range 32 East, M.D.B.& M. All of Sections 6, 7, 8, 16, 17, 18, 19, 20, 29, 30, 31 and 32; all of that portion of Sections 4, 5 and 9, one mile distant from Paiute's Eagle Picher No. 2 Lateral.
  11. All of Sections 35 and 36, Township 34 North, Range 34 East, M.D.B.& M.

B. The aforesaid service area of Southwest Gas Corporation is more particularly described as follows:

PARCEL 1: Beginning at the northwest (NW) corner of Section 6, Township 36 North, Range 37 East, M.D.B.& M., Humboldt County, Nevada; thence easterly along the north lines of Township 36 North, Range 37 and 38 East, to the northeast (NE) corner of Section 1, Township 36, Range 38 East; thence southerly along the east lines of Townships 36, 35, and 34 North, Range 38 East, crossing into Pershing

<p>Issued: February 17, 2006</p> <p>Effective: January 19, 2006</p> <p>Advice Letter No.: <u>419</u></p>	<p>Issued by John P. Hester Vice President</p>	
--	--	--

DESCRIPTION OF SERVICE AREA  
(Continued)

B. PARCEL 1: (Continued)

County, to the southeast (SE) corner of Section 36, Township 34 North, Range 38 East; thence westerly along the south lines of Township 34 North, Ranges 38 and 37 East, to the southwest (SW) corner of Section 31, Township 34 North, Range 37 East; thence northerly along the west lines of Townships 34, 35, and 36 North, Range 37 East, crossing into Humboldt County, to the northwest (NW) corner of Section 6, Township 36 North, Range 37 East, the point of beginning.

PARCEL 2: Beginning at the southwest (SW) corner of Section 5, Township 26 North, Range 31 East, M.D.B.& M., Pershing County, Nevada; thence northerly along the west line of said Section 5 to the northwest (NW) corner of said Section 5; thence continuing northerly along the west line of Sections 32, 29, 20 and 17, Township 27 North, Range 31 East, M.D.B.& M. to a point in Section 17, said point being one mile distant from Paiute's Mainline; thence northeasterly one mile distant from said Paiute's Mainline through Sections 17, 8, 9 and 4, said township and range, to a point in Section 4, said point being one mile distant from Paiute's Mainline to the east line of said Section 4; thence southerly along the east line of Sections 4, 9 and 16 to the southeast (SE) corner of Section 16, said township and range; thence easterly along the north line of Sections 22 and 23 to the northeast (NE) corner of said Section 23, said township and range; thence northerly along the west line of Sections 13, 12 and 1 to a point in Section 1, said point being one mile distant from Paiute's Eagle Picher No. 2 Lateral; thence easterly one mile distant of said lateral in Section 1 to the east line of said Section 1, said township and range; thence continuing easterly one mile distant from Paiute's Eagle Picher No. 2 Lateral through Sections 6, 5 and 4, Township 27 North, Range 32 East, M.D.B.& M., to the east line of said Section 4, said township and range; thence southerly along the east line of Sections 4, 9 and 16, said township and range, to the southeast (SE) corner of said Section 16; thence westerly along the south line to the southwest (SW) corner of said Section 16; thence southerly along the east line of Sections 20, 29 and 32, to the southeast (SE) corner of Section 32, Township 27 North, Range 32 East, M.D.B.& M.; thence continuing southerly to the southeast (SE) corner of Section 5, Township 26 North, Range 32 East, M.D.B.& M.; thence westerly along the south line of Sections 5 and 6, said township and range, to the southwest (SW)

<p>Issued:  February 17, 2006</p> <p>Effective:  January 19, 2006</p> <p>Advice Letter No.:  <u>419</u></p>	<p style="text-align: center;">Issued by  John P. Hester  Vice President</p>	
---	--	--



DESCRIPTION OF SERVICE AREA  
(Continued)

B. PARCEL 2: (Continued)

corner of said Section 5; thence continuing westerly along the south line of Sections 1, 2, 3, 4 and 5, Township 26 North, Range 31 East, M.D.B.&M. to the southwest (SW) corner of Section 5, said corner being the point of beginning.

PARCEL 3: Beginning at the northwest (NW) corner of Section 35, Township 34 North, Range 34 East, M.D.B.& M., Pershing County, Nevada; thence easterly along the north lines of Sections 35 and 36, said township and range, to the northeast (NE) corner of said Section 36; thence southerly along the east line of Section 36, said township and range, to the southeast (SE) corner of said Section 36; thence westerly along the south lines of Sections 36 and 35, said township and range, to the southwest (SW) corner of said Section 35; thence northerly along the west line of Section 35, said township and range, to the point of beginning at the northwest (NW) corner of said Section 35.

Issued:

February 17, 2006

Effective:

January 19, 2006

Advice Letter No.:

419

Issued by  
John P. Hester  
Vice President

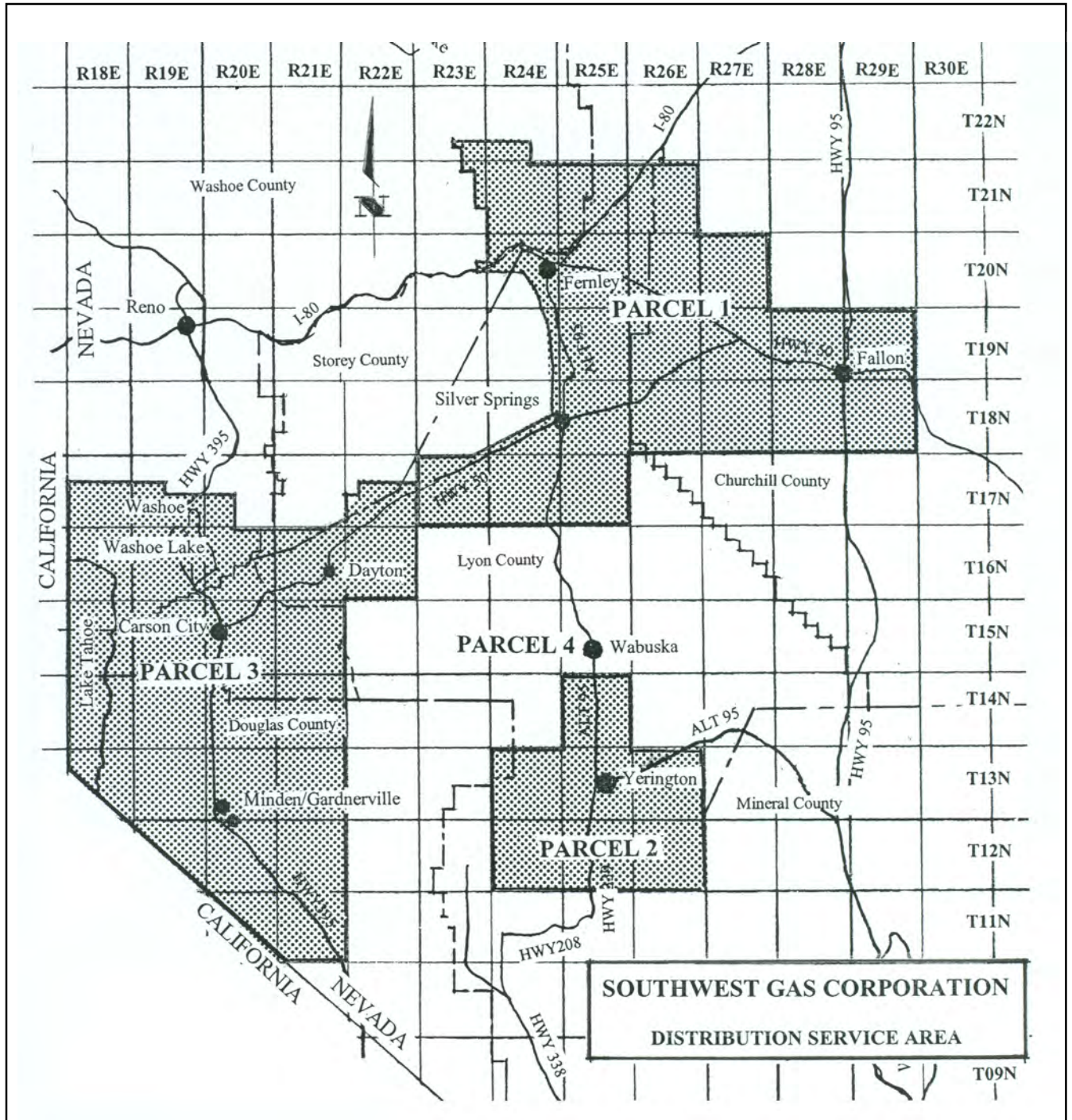

Issued:  
February 17, 2006

Effective:  
January 19, 2006

Advice Letter No.:  
419

Issued by  
John P. Hester  
Vice President

DESCRIPTION OF SERVICE AREA

A. The service area of Southwest Gas Corporation in the Counties of Carson City, Douglas, Lyon, Washoe, Storey, and Churchill, State of Nevada, includes the following described area:

1. Township 22 North, Range 23 East, M.D.B.& M. All of sections 25, 26, 27, 35, and 36.
2. Township 22 North, Range 24 East, M.D.B.& M. All of sections 27, 28, 29, 30, 31, 32, 33, and 34.
3. Township 21 North, Range 23 East, M.D.B.& M. All of sections 1, 2, 12, 13, and 24.
4. Township 21 North, Range 24 East, M.D.B.& M. All sections.
5. Township 21 North, Range 25 East, M.D.B.& M. All sections.
6. Township 21 North, Range 26 East, M.D.B.& M. All sections.
7. Township 20 North, Range 23 East, M.D.B.& M. All of section 13.
8. Township 20 North, Range 24 East, M.D.B.& M. All of sections 1, 2, 3, 4, 5, 6, 7, 8, 9, 10, 11, 12, 13, 14, 15, 16, 17, 22, 23, 24, 25, 26, 35 and 36. All that portion of sections 18, 19, 20, 21, 27, 28 and 34 one mile distant from the Paiute Pipeline Company Lateral (Carson Lateral).
9. Township 20 North, Range 25 East, M.D.B.& M. All sections.
10. Township 20 North, Range 26 East, M.D.B.& M. All sections.
11. Township 20 North, Range 27 East, M.D.B.& M. All sections.

Issued:

February 17, 2006

Effective:

January 19, 2006

Advice Letter No.:

419

Issued by  
John P. Hester  
Vice President

DESCRIPTION OF SERVICE AREA  
*(Continued)*

- A. 12. Township 19 North, Range 24 East, M.D.B.& M. All of sections 1 and 12. All that portion of sections 2, 3, 11, 13, 14, 24, 25 and 36 one mile distant from the Paiute Pipeline Company Lateral (Carson Lateral).
- 13. Township 19 North, Range 25 East, M.D.B.& M. All sections.
- 14. Township 19 North, Range 26 East, M.D.B.& M. All sections.
- 15. Township 19 North, Range 27 East, M.D.B.& M. All sections.
- 16. Township 19 North, Range 28 East, M.D.B.& M. All sections.
- 17. Township 19 North, Range 29 East, M.D.B.& M. All sections.
- 18. Township 18 North, Range 23 East, M.D.B.& M. All that portion of sections 25, 34, 35 and 36 one mile distant from the Paiute Pipeline Company Lateral (Carson Lateral).
- 19. Township 18 North, Range 24 East, M.D.B.& M. All of sections 13, 23, 24, 25, 26, 27, 28, 31, 32, 33, 34, 35 and 36. All that portion of sections 1, 11, 12, 14, 15, 20, 21, 22, 29 and 30 one mile distant from the Paiute Pipeline Company Lateral (Carson Lateral).
- 20. Township 18 North, Range 25 East, M.D.B.& M. All sections.
- 21. Township 18 North, Range 26 East, M.D.B.& M. All sections.
- 22. Township 18 North, Range 27 East, M.D.B.& M. All sections.
- 23. Township 18 North, Range 28 East, M.D.B.& M. All sections.
- 24. Township 18 North, Range 29 East, M.D.B.& M. All sections.
- 25. Township 17 North, Range 18 East, M.D.B.& M. All of sections 13, 14, 15, 16, 17, 18, 19, 20, 21, 22, 23, 24, 25, 26, 27, 28, 29, 30, 31, 32, 33, 34, 35, and 36.

<p>Issued: February 17, 2006</p> <p>Effective: January 19, 2006</p> <p>Advice Letter No.: <u>419</u></p>	<p>Issued by John P. Hester Vice President</p>	
--	--	--

DESCRIPTION OF SERVICE AREA  
(Continued)

- A. 26. Township 17 North, Range 19 East, M.D.B.& M. All of sections 16, 17, 18, 19, 20, 21, 22, 23, 24, 25, 26, 27, 28, 29, 30, 31, 32, 33, 34, 35, and 36.
- 27. Township 17 North, Range 20 East, M.D.B& M. All of sections 19, 20, 21, 28, 29, 30, 31, 32, and 33.
- 28. Township 17 North, Range 21 East, M.D.B.& M. All that portion of sections 35 and 36 in Lyon County.
- 29. Township 17 North, Range 22 East, M.D.B.& M. All of sections 13, 14, 15, 16, 17, 19, 20, 21, 22, 23, 24, 25, 26, 27, 28, 29, 30, 31, 32, 33, 34, 35 and 36. All that portion of section 12 one mile distant from the Paiute Pipeline Company Carson Lateral Line (Carson Lateral).
- 30. Township 17 North, Range 23 East, M.D.B.& M. All sections.
- 31. Township 17 North, Range 24 East, M.D.B.& M. All sections.
- 32. Township 17 North, Range 25 East, M.D.B.& M. All sections.
- 33. Township 16 North, Range 18 East, M.D.B.& M. All sections.
- 34. Township 16 North, Range 19 East, M.D.B.& M. All sections.
- 35. Township 16 North, Range 20 East, M.D.B.& M. All sections.
- 36. Township 16 North, Range 21 East, M.D.B.& M. All sections.
- 37. Township 16 North, Range 22 East, M.D.B.& M. All sections.
- 38. Township 15 North, Range 18 East, M.D.B.& M. All sections.
- 39. Township 15 North, Range 19 East, M.D.B.& M. All sections.
- 40. Township 15 North, Range 20 East, M.D.B.& M. All sections.
- 41. Township 15 North, Range 21 East, M.D.B.& M. All sections.
- 42. Township 14 North, Range 18 East, M.D.B.& M. All sections.

<p>Issued:  February 17, 2006</p> <p>Effective:  January 19, 2006</p> <p>Advice Letter No.:  <u>419</u></p>	<p>Issued by  John P. Hester  Vice President</p>	
---	--	--

DESCRIPTION OF SERVICE AREA  
(Continued)

- A. 43. Township 14 North, Range 19 East, M.D.B.& M. All sections.
- 44. Township 14 North, Range 20 East, M.D.B.& M. All sections.
- 45. Township 14 North, Range 21 East, M.D.B.& M. All sections.
- 46. Township 14 North, Range 25 East, M.D.B.& M. All sections.
- 47. Township 13 North, Range 18 East, M.D.B.& M. All of sections 1, 2, 3, 4, 5, 6, 7, 8, 9, 10, 11, 12, 13, 14, 15, 16, 22, 23, 24, and 25. All that portion of sections 17, 18, 20, 21, 26, 27, 28, 35, and 36, northeasterly of the Nevada/California state line.
- 48. Township 13 North, Range 19 East, M.D.B.& M. All sections.
- 49. Township 13 North, Range 20 East, M.D.B.& M. All sections.
- 50. Township 13 North, Range 21 East, M.D.B.& M. All sections.
- 51. Township 13 North, Range 24 East, M.D.B.& M. All sections.
- 52. Township 13 North, Range 25 East, M.D.B.& M. All sections.
- 53. Township 13 North, Range 26 East, M.D.B.& M. All sections.
- 54. Township 12 North, Range 18 East, M.D.B.& M. All that portion of section 1 northeasterly of the Nevada/California state line.
- 55. Township 12 North, Range 19 East, M.D.B.& M. All of sections 1, 2, 3, 4, 5, 9, 10, 11, 12, 13, 14, 15, 23, 24, and 25. All that portion of sections 6, 7, 8, 16, 17, 21, 22, 26, 27, 35, and 36, northeasterly of the Nevada/California state line.
- 56. Township 12 North, Range 20 East, M.D.B.& M. All of sections 1, 2, 3, 4, 5, 6, 7, 8, 9, 10, 11, 12, 13, 14, 15, 16, 17, 18, 19, 20, 21, 22, 23, 24, 25, 26, 27, 28, 29, 30, 32, 33, 34, 35, and 36. All that portion of section 31 northeasterly of the Nevada/California state line.

<p>Issued: February 17, 2006</p> <p>Effective: January 19, 2006</p> <p>Advice Letter No.: <u>419</u></p>	<p>Issued by John P. Hester Vice President</p>	
--	--	--

DESCRIPTION OF SERVICE AREA  
(Continued)

- A 57. Township 12 North, Range 21 East, M.D.B.& M. All sections.  
58. Township 12 North, Range 24 East, M.D.B.& M. All sections.  
59. Township 12 North, Range 25 East, M.D.B.& M. All sections.  
60. Township 12 North, Range 26 East, M.D.B.& M. All sections.  
61. Township 11 North, Range 20 East, M.D.B.& M. All of sections 1, 2, 3, 4, 10, 11, 12, 13, 14, and 24. All that portion of sections 5, 6, 8, 9, 15, 16, 22, 23, 25, 26, and 36, northeasterly of the Nevada/California state line.  
62. Township 11 North, Range 21 East, M.D.B.& M. All of sections 1, 2, 3, 4, 5, 6, 7, 8, 9, 10, 11, 12, 13, 14, 15, 16, 17, 18, 19, 20, 21, 22, 23, 24, 25, 26, 27, 28, 29, 30, 32, 33, 34, 35, and 36. All that portion of section 31 northeasterly of the Nevada/California state line.  
63. All of Section 22, Township 15 North, Range 25 East, M.D.B.& M.
- B. The aforesaid service area of Southwest Gas Corporation is more particularly described as follows:

PARCEL 1: Beginning at the northwest (NW) corner of Section 27, Township 22 North, Range 23 East, M.D.B.& M., Washoe County, Nevada; thence easterly along the north line of Section 27 to the northeast (NE) corner of Section 27, said Township and Range; thence southerly along the east boundary of said Section 27 of said Township and Range to a point in common with the northwest (NW) corner of Section 26, said Township and Range; thence easterly along the north lines of Sections 26 and 25, said Township and Range, continuing easterly along the north lines of Sections 30, 29, 28, and 27 to the northeast (NE) corner of Section 27, said Township, Range 24 East; thence southerly along the east lines of Sections 27 and 34 to the southeast (SE) corner of Section 34, said Township and Range; thence easterly along the north lines of Sections 2 and 1 to the northeast (NE) corner of Section 1, Township 21 North, Range 24 East; thence

Issued:

February 17, 2006

Effective:

January 19, 2006

Advice Letter No.:

419

Issued by  
John P. Hester  
Vice President

DESCRIPTION OF SERVICE AREA  
(Continued)

B. PARCEL 1: (Continued)

southerly along the east line of said Section 1 of said Township and Range to a point in common with the northwest (NW) corner of Section 6, said Township, Range 25 East; thence easterly along the north lines of Township 21 North, Ranges 25 and 26 East, crossing into Lyon and Churchill Counties, to the northeast (NE) corner of Section 1, Township 21 North, Range 26 East; thence southerly along the east lines of Sections 1, 12, 13, 24, 25, and 36 to the southeast (SE) corner of Section 36, Township 21 North, Range 26 East; thence easterly along the north lines of Sections 6, 5, 4, 3, 2, and 1 to the northeast corner of Section 1, Township 20 North, Range 27 East; thence southerly along the east lines of Sections 1, 12, 13, 24, 25, and 36 to the southeast (SE) corner of Section 36, said Township and Range; thence easterly along the north lines of Township 19 North, Ranges 28 and 29 East to the northeast (NE) corner of Section 1, Township 19 North, Range 29 East; thence southerly along the east lines of Townships 19 and 18 North, Range 29 East to the southeast (SE) corner of Section 36, Township 18 North, Range 29 East; thence westerly along the south lines of Township 18 North, Ranges 29, 28, 27, and 26 East, crossing into Lyon County, to the southwest (SW) corner of Section 31, Township 18 North, Range 26 East; thence southerly along the east lines of Sections 1, 12, 13, 24, 25, and 36 to the southeast (SE) corner of Section 36, Township 17 North, Range 25 East; thence westerly along the south lines of Township 17 North, Ranges 25, 24, and 23 East to the southwest (SW) corner of Section 31, Township 17 North, Range 23 East; thence northerly along the west lines of Township 17 North, Range 23 East, to the northwest (NW) corner of Section 6, to a point on the Lyon/Storey County line; thence easterly along the south lines of Sections 31, 32, 33 and 34 Township 18 North, Range 23 East to a point, said point being one-mile distant from the Paiute Pipeline Company Carson Lateral Line (Carson Lateral); thence continuing in a northeasterly direction along the one-mile distant from Paiute's Carson Lateral through Sections 35, 36 and 25 to

<p>Issued:  February 17, 2006</p> <p>Effective:  January 19, 2006</p> <p>Advice Letter No.:  <u>419</u></p>	<p>Issued by  John P. Hester  Vice President</p>	
---	--	--



DESCRIPTION OF SERVICE AREA  
*(Continued)*

point on the east line of Section 25, said township and range; thence continuing in a northeasterly and northerly direction along the one-mile distant from Paiute's Carson Lateral through Sections 30, 29, 20, 21, 22, 15, 14, 11, 12 and 1 to a point on the north line of Section 1, Township 18 North, Range 24 East; thence continuing in a northerly and northwesterly direction along the one-mile distant from Paiute's Carson Lateral through Sections 36, 25, 24, 13, 14, 11, 2 and 3 to a point on the north line of Section 3, Township 19 North, Range 24 East; thence continuing in a northwesterly direction along the one-mile distant from Paiute's Carson Lateral through Sections 34, 27, 28, 21, 20, 19 and 18 to south line of said section 18, Township 20 North, Range 24 East crossing into Storey and Washoe Counties; thence westerly along the south line of Section 18 a point on the west line of Section 18, said township and range; thence westerly along the south line of Section 13, Township 20 North, Range 23 East to the southwest (SW) corner of said section; thence northerly along the west line to the northwest (NW) corner of said section; thence easterly along the north line to the northeast (NE) corner of said section, township and range; thence northerly along the west lines of Sections 7 and 6, Township 20 North, Range 24 East to the northwest (NW) corner of said section 6, township and range; thence northerly along the west lines of Sections 31 and 30 to the northwest (NW) corner of said section 30, Township 21 North, Range 24 East; thence westerly along the south line of Section 24 to the southwest (SW) corner of Section 24, Township 21 North, Range 23 East; thence northerly along the west lines of Sections 24, 13, and 12 to the northwest (NW) corner of Section 12, said Township and Range; thence westerly along the south line of Section 2 to the southwest (SW) corner of Section 2, said Township and Range; thence northerly along the west line of Section 2 to the northwest (NW) corner of Section 2, said Township and Range; thence easterly along the north line of said Section 2 of said Township and Range to a point in common with the southwest (SW) corner of Section 35, Township 22 North, Range 23 East; thence northerly along the west line of Section 35 to the northwest (NW) corner of Section 35, said Township and

<p>Issued:  February 17, 2006</p> <p>Effective:  January 19, 2006</p> <p>Advice Letter No.:  <u>419</u></p>	<p style="text-align: center;">Issued by  John P. Hester  Vice President</p>	
---	--	--

DESCRIPTION OF SERVICE AREA  
*(Continued)*

Range; thence westerly along the south line of Section 27 to the southwest (SW) corner of Section 27, said Township and along the west line of Section 27 to the northwest (NW) corner of Section 27, Township 22 North, Range 23 East, the point of beginning.

PARCEL 2: Beginning at the northwest (NW) corner of Section 6, Township 14 North, Range 25 East, M.D.B.& M., Lyon County, Nevada; thence easterly along the north lines of Sections 6, 5, 4, 3, 2, and 1 to the northeast (NE) corner of Section 1, said Township and Range; thence southerly along the east lines of Sections 1, 12, 13, 24, 25, and 36 to the southeast (SE) corner of Section 36, said Township and Range; thence easterly along the north lines of Sections 6, 5, 4, 3, 2, and 1 to the northeast (NE) corner of Section 1, Township 13 North, Range 26 East; thence southerly along the east lines of Townships 13 and 12 North, Range 26 East to the southeast (SE) corner of Section 36, Township 12 North, Range 26 East; thence westerly along the south lines of Township 12 North, Ranges 26, 25, and 24 East to the southwest (SW) corner of Section 31, Township 12 North, Range 24 East; thence northerly along the west lines of Townships 12 and 13, Range 24 East, crossing into Douglas County, to the northwest (NW) corner of Section 6, Township 13 North, Range 24 East; thence easterly along the north lines of Sections 6, 5, 4, 3, 2, and 1, crossing into Lyon County, to the northeast (NE) corner of Section 1, said Township and Range; thence northerly along the west lines of Sections 31, 30, 19, 18, 7, and 6 to the northwest (NW) corner of Section 6, Township 14 North, Range 25 East, the point of beginning

PARCEL 3: Beginning at the point of intersection of the north line of Section 18, Township 17 North, Range 18 East, M.D.B.& M, with the California-Nevada state line, Washoe County, Nevada; thence easterly along the north lines of Sections 18, 17, 16, 15, 14, and 13, said Township and Range, continuing easterly along the north lines of Sections 18, 17, and 16 to the northeast (NE) corner of Section 16, said Township, Range 19 East; thence southerly along the east line of Section 16 to the southeast (SE) corner of Section 16, said Township and Range; thence easterly along the north lines of Sections 22, 23, and 24, said Township and Range, continuing easterly along the north lines of Sections 19, 20, and 21 to the northeast (NE) corner of Section 21, said Township, Range 20 East; (SE) corner of Section 33,

<p>Issued: February 17, 2006</p> <p>Effective: January 19, 2006</p> <p>Advice Letter No.: <u>419</u></p>	<p>Issued by John P. Hester Vice President</p>	
--	--	--

DESCRIPTION OF SERVICE AREA  
(Continued)

B. PARCEL 3: (Continued)

said Township and Range; thence easterly along the north line of Sections 3, 2, and 1, crossing into Storey County, Township 16 North, Range 20 East, continuing easterly along the north lines of Sections 6, 5, 4, 3, and 2 to the Lyon County and Storey County Boundary Line in said Section 2, said Township, Range 21 East; thence northeasterly along said County Line through Sections 35 and 36 of Township 17 North, Range 21 East, to the east line of Section 36; thence northerly along the west lines of Sections 31, 30, and 19 to the northwest (NW) corner of Section 19, Township 17 North, Range 22 East; thence easterly along the north line of Section 19 to the northeast (NE) corner of Section 19, said Township and Range; thence northerly along the west line of Section 17 to the northwest (NW) corner of Section 17, said Township and Range; thence easterly along the north lines of Sections 17, 16, 15, 14, and 13, crossing into Lyon County, to a point on the north line of Section 13 one-mile distant from the Carson Lateral; thence northeasterly along the one-mile distant from the Carson Lateral to the east line of Section 12, said Township and Range; thence southerly along the east lines of Sections 12, 13, 24, 25, and 36 to the southwest (SW) corner of Section 36, said Township and Range, continuing southerly along the east lines of Sections 1, 12, 13, 24, 25, and 36 to the southeast (SE) corner of Section 36, said Township and Range; thence westerly along the south lines of Sections 36, 35, 34, 33, 32, and 31 to the southwest (SW) corner of Section 31, said Township and Range; thence southerly along the east lines of Townships 15, 14, 13, 12, and 11 North, Range 21 East, crossing into Lyon, Carson City, and Douglas Counties, to the southeast (SE) corner of Section 36, Township 11 North, Range 21 East; thence westerly along the south lines of Sections 36, 35, 34, 33, 32, and 31 to the point of intersection of the south line of Section 31 with the California-Nevada state line, said Township and Range; thence northwesterly along said state line through Township 11 North, Ranges 21 and 20 East, Township 12 North, Ranges 20, 19, and 18 East, and Township 13 North, Range 18 East; thence northerly along said state line through Townships 13, 14, 15, and 16 North, Range 18 East, crossing Carson City and Washoe Counties, continuing northerly along said state line through Sections 31, 30, 19, and 18 to the northwest (NW) corner of Section 18, Township 17 North, Range 18 East, the point of beginning.

<p>Issued: February 17, 2006</p> <p>Effective: January 19, 2006</p> <p>Advice Letter No.: <u>419</u></p>	<p>Issued by John P. Hester Vice President</p>	
--	--	--

DESCRIPTION OF SERVICE AREA  
(Continued)

B. PARCEL 4: (Continued)

Beginning at the northwest (NW) corner of Section 22, Township 15 North, Range 25 East, M.D.B. & M., Lyon County, Nevada; thence easterly along the north line to the northeast (NE) corner of said Section 22, said township and range; thence southerly along the east line to the southeast (SE) corner of said Section 22, said township and range; thence westerly along the south line to the southwest (SW) corner of said Section 22, said township and range; thence northerly along the west line to the point of beginning at the northwest (NW) corner of said Section 22.

Issued:  
February 17, 2006

Effective:  
January 19, 2006

Advice Letter No.:  
419

Issued by  
John P. Hester  
Vice President

SOUTHWEST GAS CORPORATION  
P.O. Box 98510  
Las Vegas, Nevada 89193-8510  
Nevada Gas Tariff No. 6

Canceling                      First Revised P.U.C.N. Sheet No. 265-282  
                     Original P.U.C.N. Sheet No. 265-282

HELD FOR FUTURE USE

Issued:

February 17, 2006

Effective:

January 19, 2006

Advice Letter No.:

419

Issued by  
John P. Hester  
Vice President

SOUTHWEST GAS CORPORATION  
P.O. Box 98510  
Las Vegas, Nevada 89193-8510  
Nevada Gas Tariff No. 6

Canceling Third Revised P.U.C.N. Sheet No. 283  
Second Revised P.U.C.N. Sheet No. 283

HELD FOR FUTURE USE

Issued:

February 17, 2006

Effective:

January 19, 2006

Advice Letter No.:

419

Issued by  
John P. Hester  
Vice President

SOUTHWEST GAS CORPORATION  
P.O. Box 98510  
Las Vegas, Nevada 89193-8510  
Nevada Gas Tariff No. 6

Canceling Third Revised P.U.C.N. Sheet No. 284  
Second Revised P.U.C.N. Sheet No. 284

HELD FOR FUTURE USE

Issued:

February 17, 2006

Effective:

January 19, 2006

Advice Letter No.:

419

Issued by  
John P. Hester  
Vice President

SOUTHWEST GAS CORPORATION  
P.O. Box 98510  
Las Vegas, Nevada 89193-8510  
Nevada Gas Tariff No. 6

Canceling Second Revised P.U.C.N. Sheet No. 284A  
First Revised P.U.C.N. Sheet No. 284A

HELD FOR FUTURE USE

Issued:

February 17, 2006

Effective:

January 19, 2006

Advice Letter No.:

419

Issued by  
John P. Hester  
Vice President



SOUTHWEST GAS CORPORATION  
P.O. Box 98510  
Las Vegas, Nevada 89193-8510  
Nevada Gas Tariff No. 6

Canceling                      First Revised P.U.C.N. Sheet No. 285-321  
                     Original P.U.C.N. Sheet No. 285-321

HELD FOR FUTURE USE

Issued:

February 17, 2006

Effective:

January 19, 2006

Advice Letter No.:

419

Issued by  
John P. Hester  
Vice President

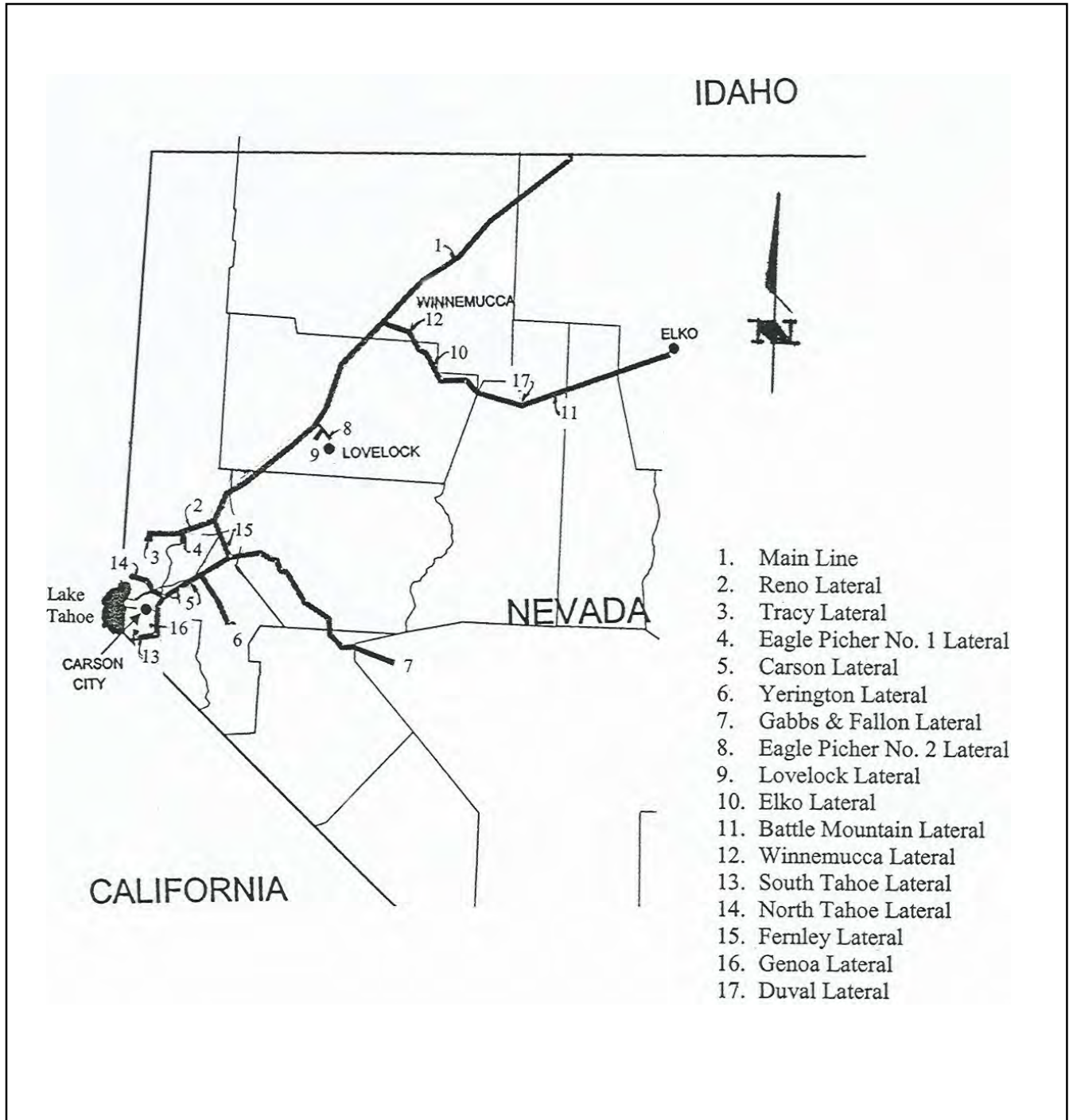

Issued:  
February 17, 2006

Effective:  
January 19, 2006

Advice Letter No.:  
419

Issued by  
John P. Hester  
Vice President

DESCRIPTION OF SERVICE AREA

- A. The service area of Southwest Gas Corporation in its Northern Nevada Division includes along its main transmission pipeline and lateral lines the following described areas:
1. MAIN LINE: A strip two (2) miles in width, one (1) mile on each side of the main transmission pipeline centerline, beginning at a point on the Idaho–Nevada state line in Section 5, Township 47 North, Range 48 East, M.D.B.& M., and continuing along the pipeline centerline in a southwesterly direction to the point of termination at the Golden Tee Intersection in Section 1, Township 20 North, Range 23 East, M.D.B.& M., Washoe County, Nevada.
  2. RENO LATERAL: A strip two (2) miles in width, one (1) mile on each side of the Reno Lateral pipeline centerline, beginning at the Golden Tee Intersection in Section 1, Township 20 North, Range 23 East, M.D.B.& M., and continuing along the pipeline centerline to the point of termination of said service area on the east line of Section 22, Township 20 North, Range 22 East, M.D.B.& M., Washoe County, Nevada; thence the Reno Lateral pipeline continues in a westerly direction to its point of termination in the northwest quarter (NW 1/4) of Section 36, Township 20 North, Range 19 East, M.D.B.& M., city of Reno, County of Washoe, Nevada.
  3. TRACY LATERAL: The Tracy Lateral pipeline centerline begins at a point on the Reno Lateral pipeline in Section 22, Township 20 North, Range 22 East, M.D.B.& M., Washoe County, Nevada, and continues along the pipeline centerline in a southerly direction to its point of termination in Section 33, Township 20 North, Range 22 East, M.D.B.& M., Storey County, Nevada.
  4. EAGLE PICHER NO. 1 LATERAL: The Eagle Picher No. 1 pipeline centerline begins at a point on the Tracy Lateral pipeline in the southeast quarter (SE 1/4) of Section 28, Township 20 North, Range 22 East, M.D.B.& M., Washoe County, Nevada, and continues along the pipeline centerline in an easterly direction to a

<p>Issued: September 27, 1996</p> <p>Effective: October 27, 1996</p> <p>Advice Letter No.: <u>345</u></p>	<p>Issued by Edward S. Zub Senior Vice President</p>	
---	--	--

DESCRIPTION OF SERVICE AREA  
(Continued)

point on the east line of the southeast quarter (SE 1/4) of Section 27, Township 20 North, Range 22 East, M.D.B.& M., Washoe County, Nevada; thence the Eagle Picher No. 1 Lateral service area begins, being a strip two (2) miles wide, one (1) mile on each side of the pipeline centerline and continuing along the pipeline centerline in an easterly direction to its point of termination in the northwest quarter (NW 1/4) of the northeast quarter (NE 1/4) of Section 35, Township 20 North, Range 22 East, M.D.B.& M., Storey County, Nevada.

5. CARSON LATERAL: A strip two (2) miles in width, one (1) mile on each side of the Carson Lateral pipeline centerline, beginning at the Golden Tee Intersection in Section 1, Township 20 North, Range 23 East, M.D.B.& M., and continuing along the pipeline centerline in a southerly direction to its point of termination in Section 4, Township 14 North, Range 20 East, M.D.B.& M., Carson City, Nevada.
6. YERINGTON LATERAL: A strip two (2) miles in width, one (1) mile on each side of the Yerington Lateral centerline, beginning at a point on the Carson Lateral pipeline in Section 2, Township 17 North, Range 23 East, M.D.B.& M., and continuing along the pipeline centerline to the termination point in the town of Yerington, Nevada.
7. GABBS AND FALLON LATERAL: A strip two (2) miles in width, one (1) mile on each side of the Fallon Lateral centerline, beginning at a point on the Carson Lateral pipeline in Section 18, Township 19 North, Range 25 East, M.D.B.& M., and continuing along the pipeline centerline to a point south of Fallon, Nevada, which thence becomes the Gabbs Lateral pipeline continuing along the pipeline centerline to its termination point in Section 26, Township 12 North, Range 36 East, M.D.B.& M.
8. EAGLE PICHER NO. 2 LATERAL: A strip two (2) miles in width, one (1) mile on each side of the Eagle Picher No. 2 Lateral pipeline centerline, beginning at a point on the main transmission pipeline in Section 27, Township 28 North, Range 31 East, M.D.B.& M., continuing along the pipeline centerline to its termination point in Section 27, Township 28 North, Range 32 East, M.D.B.& M.

<p>Issued: September 27, 1996</p> <p>Effective: October 27, 1996</p> <p>Advice Letter No.: <u>345</u></p>	<p>Issued by Edward S. Zub Senior Vice President</p>	
---	--	--

DESCRIPTION OF SERVICE AREA  
(Continued)

9. LOVELOCK LATERAL: A strip two (2) miles in width, one (1) mile on each side of the Lovelock Lateral centerline, beginning at a point on the Eagle Picher No. 2 Lateral pipeline in Section 27, Township 28 North, Range 31 East, M.D.B. & M., continuing along the pipeline centerline to its termination point in the city of Lovelock, Nevada.
  
10. ELKO LATERAL: A strip two (2) miles in width, one (1) mile on each side of the Elko Lateral pipeline centerline, beginning at a point on the main transmission pipeline in Section 24, Township 36 North, Range 36 East, M.D.B. & M., and continuing along the pipeline centerline to its termination point in the city of Elko, Nevada, and that portion more particularly described as follows:
  - a. Township 35 North, Range 36 East, all of Section 1 and all of that portion of Sections 2 and 3 southeast of the Main Line Certificated Service Area right-of-way (right-of-way being one (1) mile on each side of pipeline).
  - b. Township 35 North, Range 37 East, all of that portion of Section 4 west of the Elko Lateral Certificated Service Area right-of-way (right-of-way being one (1) mile on each side of pipeline) and all of Sections 5 and 6.
  - c. Township 36 North, Range 36 East, all of that portion of Section 35 southeast of the Main Line Certificated Service Area right-of-way (right-of-way being one (1) mile on each side of pipeline) and all of that portion of Section 36 southeast of the Main Line and south of the Elko/Jungo Lateral Certificated Service Areas right-of-way (right-of-way being one (1) mile on each side of pipeline).
  - d. Township 36 North, Range 37 East, all of that portion of Section 31 south of the Elko/Jungo Lateral Certificated Service Area right-of-way (right-of-way being one (1) mile on each side of pipeline) and all of that portion of Section 32 south of the Elko/Jungo Lateral and west of the Elko Lateral Certificated Service Areas right-of-way (right-of-way being one (1) mile on each side of pipeline).

<p>Issued: September 27, 1996</p> <p>Effective: October 27, 1996</p> <p>Advice Letter No.: <u>345</u></p>	<p>Issued by Edward S. Zub Senior Vice President</p>	
---	--	--

DESCRIPTION OF SERVICE AREA  
(Continued)

11. BATTLE MOUNTAIN LATERAL: A strip two (2) miles in width, one (1) mile on each side of the Battle Mountain Lateral centerline, beginning at a point on the Elko Lateral pipeline in Section 29, Township 31 North, Range 45 East, M.D.B.& M., and continuing along the pipeline centerline to its termination point in the town of Battle Mountain, Nevada.
  
12. WINNEMUCCA LATERAL: A strip two (2) miles in width, one (1) mile on each side of the Winnemucca Lateral pipeline centerline, beginning at a point on the main transmission pipeline in Section 24, Township 36 North, Range 36 East, M.D.B.& M., and continuing along the pipeline centerline to its point of termination in the city of Winnemucca, Nevada.
  
13. SOUTH TAHOE LATERAL: A strip two (2) miles in width, one (1) mile on each side of the South Tahoe Lateral pipeline centerline, beginning at the end of the Carson Lateral in Section 4, Township 14 North, Range 20 East, M.D.B.& M., and continuing along the pipeline centerline to the termination point in Section 22, Township 13 North, Range 18 East, M.D.B.& M.
  
14. NORTH TAHOE LATERAL: A strip two (2) miles in width, one (1) mile on each side of the North Tahoe Lateral centerline and beginning at a point on the Carson Lateral in Section 2, Township 15 North, Range 20 East, M.D.B.& M., and continuing along the pipeline centerline to the termination point in Section 23, Township 16 North, Range 18 East, M.D.B.& M.
  
15. FERNLEY LATERAL: A strip two (2) miles in width, one (1) mile on each side of the Fernley Lateral centerline and beginning at a point on the Carson Lateral in Section 22, Township 20 North, Range 24 East, M.D.B.& M., and continuing along the pipeline centerline to the termination point in the town of Fernley, Nevada.
  
16. GENOA LATERAL: A strip two (2) miles in width, one (1) mile on each side of the Genoa Lateral centerline and beginning at a point on the South Tahoe Lateral in Section 18, Township 13 North, Range 20 East, M.D.B.& M., and continuing along the pipeline centerline to the town of Genoa, Nevada.

<p>Issued: September 27, 1996</p> <p>Effective: October 27, 1996</p> <p>Advice Letter No.: <u>345</u></p>	<p>Issued by Edward S. Zub Senior Vice President</p>	
---	--	--

DESCRIPTION OF SERVICE AREA  
(Continued)

17. DUVAL LATERAL: A strip two (2) miles in width, one (1) mile on each side of the Duval Lateral centerline, beginning at a point on the Elko Lateral pipeline in Section 4, Township 30 North, Range 43 East, M.D.B. & M., continuing along the pipeline centerline to its termination point in the Section 27, Township 31 North, Range 43 East, M.D.B. & M.

Issued:  
September 27, 1996

Effective:  
October 27, 1996

Advice Letter No.:  
345

Issued by  
Edward S. Zub  
Senior Vice President

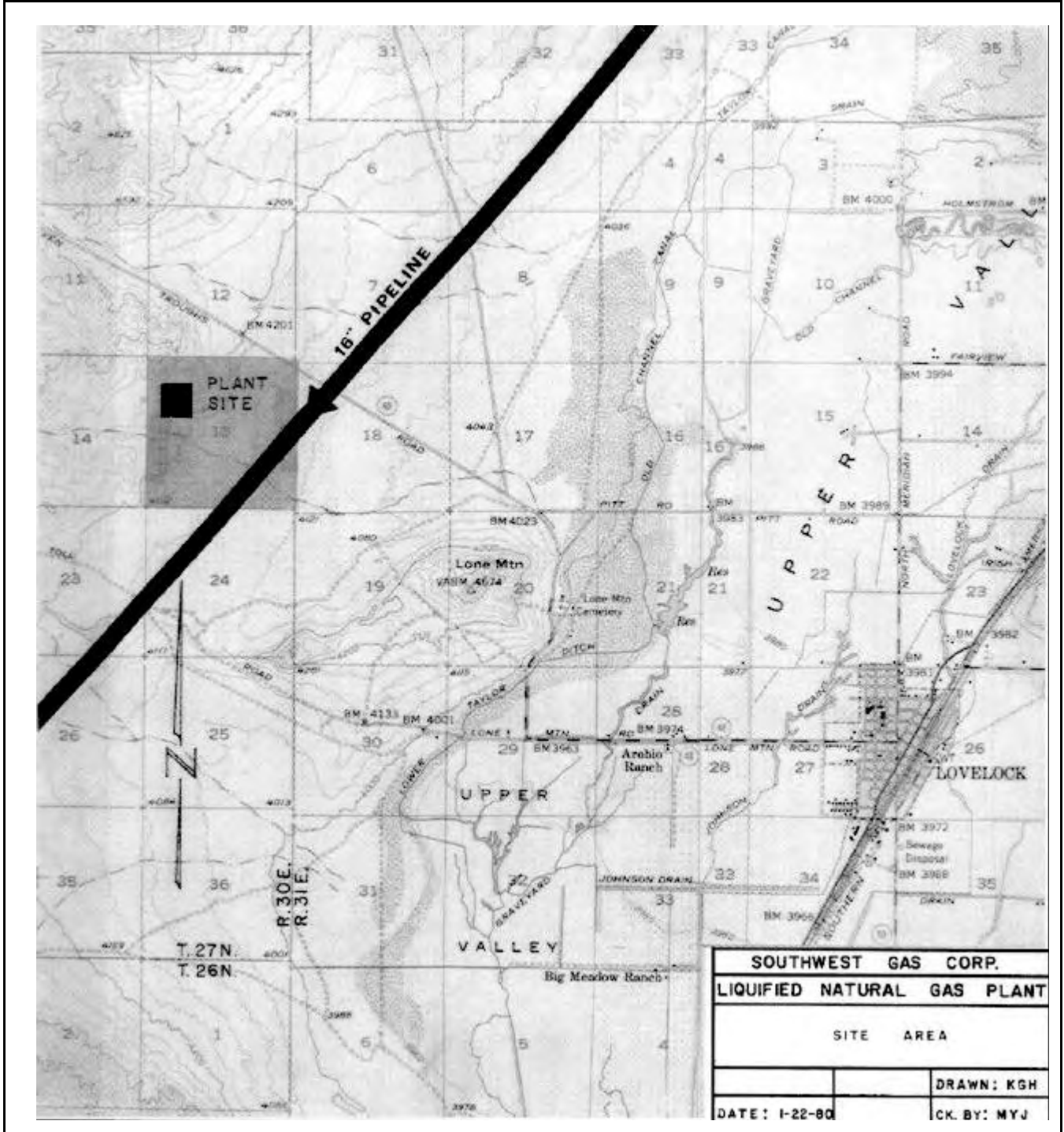

<p>Issued: September 27, 1996</p> <p>Effective: October 27, 1996</p> <p>Advice Letter No.: <u>345</u></p>	<p>Issued by Edward S. Zub Senior Vice President</p>	
---	--	--



DESCRIPTION OF PLANT SITE AREA

A. The site for the liquefied natural gas plant of Southwest Gas Corporation near Lovelock, County of Pershing, State of Nevada, is located in the northwest quarter (NW 1/4) of the following described area:

Section 13, Township 27 North, Range 30 East, M.D.B. & M.

B. The aforesaid area is more particularly described as follows:

Beginning at the northwest (NW) corner of Section 13, Township 27 North, Range 30 East, M.D.B. & M., Pershing County, Nevada; thence easterly along the north line of Section 13, to the northeast (NE) corner of said Section 13; thence southerly along the east line of Section 13 to the southeast (SE) corner of said Section 13; thence westerly along the south line of Section 13 to the southwest (SW) corner of said Section 13; thence northerly along the west line of Section 13 to the point of beginning at the northwest (NW) corner of Section 13.

Issued:  
September 27, 1996

Effective:  
October 27, 1996

Advice Letter No.:  
345

Issued by  
Edward S. Zub  
Senior Vice President

SOUTHWEST GAS CORPORATION  
P.O. Box 98510  
Las Vegas, Nevada 89193-8510  
Nevada Gas Tariff No. 6

Canceling \_\_\_\_\_ Original \_\_\_\_\_ P.S.C.N. Sheet No. 330-334  
P.S.C.N. Sheet No. \_\_\_\_\_

HELD FOR FUTURE USE

Issued:  
September 27, 1996

Effective:  
October 27, 1996

Advice Letter No.:  
345

Issued by  
Edward S. Zub  
Senior Vice President